



neomate
AUTOMATIC SANITARY SYSTEM



PRODUCTS FOR BATHROOM

PRODUCTS FOR BATHROOM



卫浴五金配置设计顾问 2019

2019

SANITARY WARE HARDWARE
CONFIGURATION DESIGN CONSULTANT

2019 年全系产品画册

公共卫生间 | 无障碍卫生间 | 酒店卫生间

雅之杰荣誉出品

版权归雅之杰装饰五金有限公司所有，图片仅供参考，样品以实样为准，《产品画册》2019年5月第一版。



卫浴五金配置设计顾问™

SANITARY WARE HARDWARE
CONFIGURATION DESIGN CONSULTANT



配置设计方案手册

公共卫生间 | 无障碍卫生间 | 酒店卫生间

卫浴五金配置设计顾问™

SANITARY WARE HARDWARE

CONFIGURATION DESIGN CONSULTANT

公共卫生间系统

配置设计指引

PUBLIC TOILET SYSTEM

CONFIGURATION DESIGN GUIDELINES





公共卫生间系统配置设计表

Configuration design table of public toilet system

配置设计依据		标准化		生产工艺		成品保护
01	设计图纸	01	SU304#不锈钢	01	工件表面必须够光亮	所有公卫产品出厂时采用良好防潮及防损保护，同时内置干燥剂，原厂包装，能有效防止损坏。
02	QB/T1560-1992 卫生间附属配件标准	02	QB/T1560-1992 卫生间附属配件标准	02	无任何颗粒和任何坑	
03	其他有关国家及地方有关规范、规程和规定	03	静荷载承受1200N，60S卸载后，残余变形量不大于1/100	03	5次抛光工序	
		04	所有产品均需要经过96小时盐雾测试及耐腐蚀测试	04	多种表面处理颜色	

公共卫生间系统配置设计方案系列产品

系列产品	产品名称	分类检索	系列产品	产品名称	分类检索
	手纸箱 带干手器手纸箱	P48-66		镜后手纸箱	P48-66
				垃圾槽	P104-114
	马桶坐垫纸箱	P48-66		无盖垃圾桶	P104-114
	大卷纸箱	P48-66		挂墙式垃圾桶	P104-114
	衣钩	P104-114		残疾人扶手	P051-057
	皂液器	P116-118		残疾人扶手	P88-100
	台式皂液器	P116-118		地漏	P171-178
	干手器	P104-114		卷纸架	P76-82

酒店卫生间系统

配置设计指引

PUBLIC TOILET SYSTEM

CONFIGURATION DESIGN GUIDELINES





酒店卫生间系统配置设计表

Configuration design table of public toilet system

配置设计依据		标准化		生产工艺		成品保护	
01	设计图纸	01	SU304#不锈钢	01	工件表面必须够光亮	所有酒店五金产品出厂时采用良好防潮及防损保护, 同时内置干燥剂, 原厂包装, 能有效防止损坏。	
02	QB/T1560-1992 卫生间附属配件标准	02	QB/T1560-1992 卫生间附属配件标准	02	无任何颗粒和任何坑		
03	其他有关国家及地方有关规范、规程和规定	03	静荷载承受1200N, 60S卸载后, 残余变形量不大于1/100	03	5次抛光工序		
		04	所有产品均需要经过96小时盐雾测试及耐腐蚀测试	04	多种表面处理颜色		

公共卫生间系统配置设计方案系列产品

系列产品	产品名称	分类检索	系列产品	产品名称	分类检索
	化妆镜	P156-157		干发器	P104-114
	手纸盒	P62-63		无盖垃圾桶	P104-114
	晾衣器	P104-114		卷纸架	P76-84
	手机平台	P83-84		毛巾架	P153-154
	衣钩	P104-114		浴缸扶手	P95-96
	长型排水地漏	P171-178		网篮	P159-165
	残疾人扶手	P85-100		地漏	P171-178
	淋浴房	P179-212			

无障碍卫生间系统

配置设计指引

PUBLIC TOILET SYSTEM

CONFIGURATION DESIGN GUIDELINES





无障碍卫生间系统配置设计表

Configuration design table of public toilet system

配置设计依据		标准化		生产工艺		成品保护	
01	设计图纸	01	SU304#不锈钢	01	工件表面必须够力亮	雅之杰所有产品出厂时采用良好防潮及防损保护，同时内置干燥剂，原厂包装，能有效防止损坏。	
02	QB/T1560-1992 卫生间附属配件标准	02	符合QB/T1560-1992 卫生间附属配件标准	02	无任何颗粒和任何坑		
03	其他有关国家及地方有关规范、规程和规定	03	静荷载承受1200N， 60S卸载后，残余变形量不大于1/100	03	5次抛光工序		
		04	所有产品均需要经过96小时盐雾测试及耐腐蚀测试	04	多种表面处理颜色		
公共卫生间系统配置设计方案系列产品							
系列产品	产品名称	分类检索	系列产品	产品名称	分类检索		
	残疾人扶手	P85-102		浴室凳	P101-102		
	浴帘杆	P85-102		毛巾杆	P153-154		
	皂液器	P69-74		手纸箱	P051-057		
	马桶坐垫纸箱	P58-66		双卷纸架	P76-81		
	衣钩	P104-114		淋浴花洒带扶手	P92		
	可调浴室镜	P156-157		地漏	P171-178		
	卷纸座	P76-81		垃圾桶	P104-114		

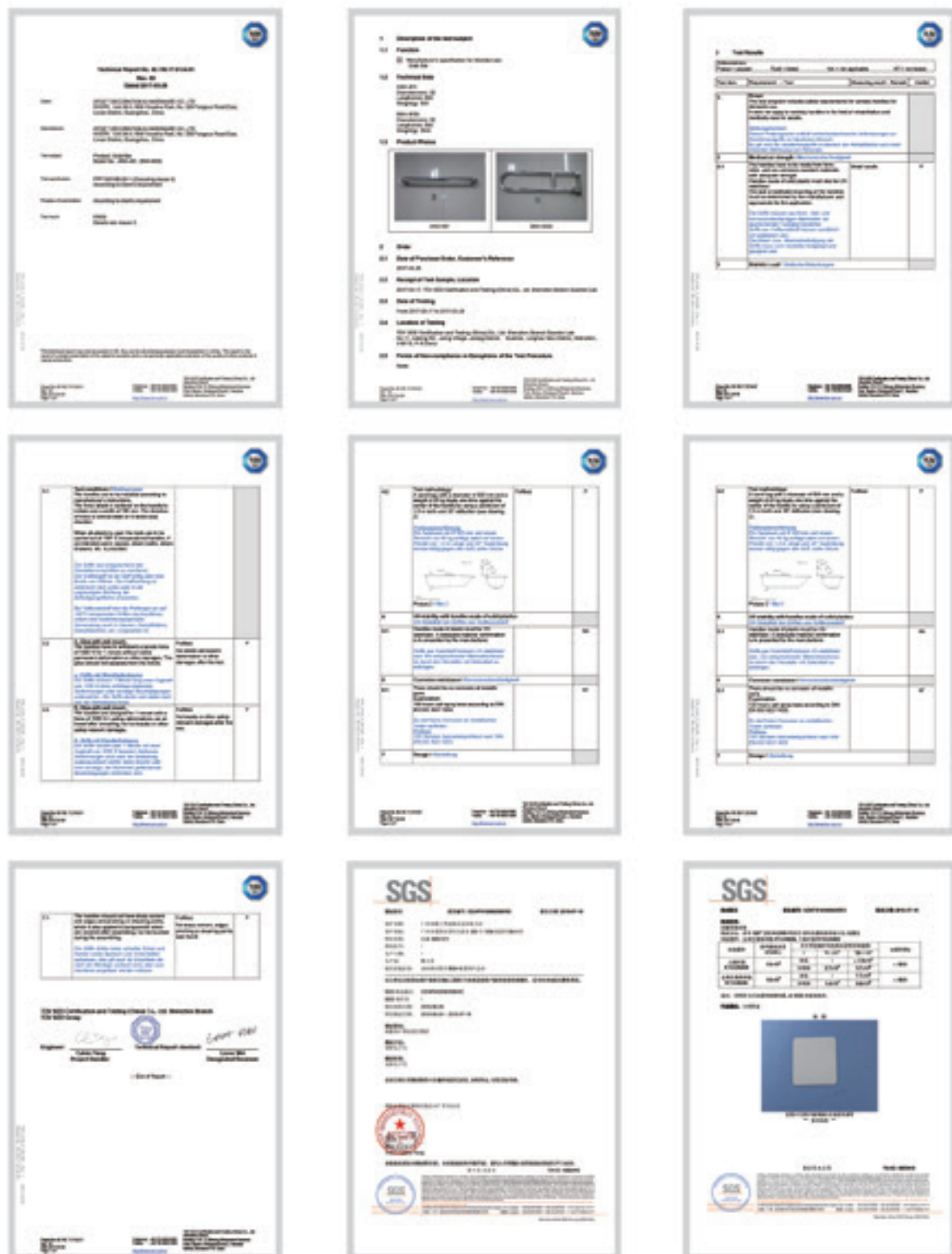

卫浴五金配置设计顾问™

SANITARY WARE HARDWARE
CONFIGURATION DESIGN CONSULTANT

温馨提示

雅之杰专业卫浴五金配置顾问团队可根据空间需求为您提供
定制配置设计方案与配置建议

我们不仅有多种系列产品与产品表面处理进行配置选择
还可以根据客户需求进行定制生产

品牌战略

卫浴五金配置设计顾问™

PUBLIC HEALTH HARDWARE

CONFIGURATION DESIGN CONSULTANT

三大系统

公共卫生间系统 | 无障碍卫生间系统 | 酒店卫生间系统

五大核心

美学设计 | 专业配置 | 非凡品质 | 智慧人生 | 贴心服务

品牌战略

Brand strategy

美学设计

Aesthetics design

雅之杰专业配置设计顾问团队对三大空间的功能、需求、通过深度研究生活形态和产品特性，我们创造性的对三大卫浴空间进行独有专业的配置设计，除了满足功能性外，让产品在不同风格的空间和谐相处，毫无违和感。

专业配置

Professional configuration

“品质不折扣”是雅之杰每一款产品的生产经营理念，我们在追求完美的产品质量，保持对产品质量的信念，世纪品牌，让细节成为每个产品成败的关键。

为了更贴近消费者的需求，雅之杰建立了研发中心和测试中心，严格执行全面质量管理体系，建立了具有更强竞争力，充满生机的卫浴五金品牌，并建立了优良的品质。

非凡品质

Extraordinary quality

智慧人生

Life of Wisdom

顶尖的设计，无一例外都考虑人与自然的微妙平衡，崇尚创新的雅之杰，在考虑产品使用体验的同时，更考虑科技带来的变革，让科技融入产品，带来更智慧更人性的产品体验。

通过专业配置设计服务的创新性开展，雅之杰不仅提供多种优质产品，在满足工程需求上匹配专业的定制服务，通过前期的沟通，制定图纸、深化图纸尺寸、工艺、材质、等要求进行定制产品打样、生产，交货后进行售后安装指导与维护指导。

贴心服务

Intimate service

产品引索

47

手纸箱 -D系列	
TD-8300D	48
TD-8300TD	48
TD-8340D	48
TD-83318D	49
TD-8332D	49
TD-8334D	50
TD-8337D	50

51

手纸箱-全封门系列	
TD-83398	51
TD-83348	52
TD-83318	52
TD-83328	52

53

手纸箱 -C系列	
TD-83318C	54
TD-8332C	54
TD-8334C	54
TD-8337C	55
TD-8334C(PVD)	55
TD-8334C(MRG)	56
TD-8334C(SB)	56

57

手纸箱 -经典系列	
TD-8332A	58
TD-8333A	58
TD-8334A-1200	58
TD-8334A	60
TD-8335A	60
TD-8336A	60
TD-83368A	61
TD-8337A	61
TD-83378	61
TD-8304	62
TD08-313	62
TD08-314	62
TD08-315	63
TD08-322TA	63
TD-8313A	63

TD-8314A	64
TD-8340	64
TD-8300A	64
TD-8300T	65
TD-8330A	65
TD08-320	65
TD08-321	66
TD08-323	66

67

蓝创 -A系列	
TD-A83371B	69
TD-A83341B	70
TD-A83321B	70
TD-A8314A1B	70
TD-A83001B	71
TD-A8300TB	71
TD-A83401B	71
TD-A833181B	71
ANH-A75BΦ25	72
ANH-A75BΦ32	72
SD-380B(500ml)	73
SD-680B(800ml)	73
SD-1080B(1250ml)	73
SD-A10115B(1500ml)	73
AS01-A021	74
AS01-A022W	74

75

卷纸架系列	
TD-130A	76
TD-131A	76
TD-231A	76
TD-232A	76
TD-1122A	77
TD-333D	77
TD-2332W	77
TD-2332L	77
TD-2371	78
TD-2372	78
TD-233	78
TD-233C	78
TD-233E	79
TD-83A6	79
TD-8301D	79
TD-8302W	79

TD-8305D	80
TD-8305D-2	80
TD-8325W	80
TD-8325L	80
TD-8325-2W	81
TD-8325-2L	81

82

爱丁堡系列	
AS01-020	83
AS01-021	83
AS01-022	83
AS01-022W	83
AS01-023	84

85

防滑残弱人扶手系列	
BNH-901406F	85
BNH-457 F	85
BNH- 6 10F	85
BNH-90135F	85
NH-90115F	86
BNH-90110F	86
BNH-90113F	86
BNH-90120F	86

87

不锈钢残弱人扶手系列	
BNH-9032	88
BNH-9033	88
BNH-9035	88
BNH-9035A	88
BNH-19010	89
BNH-19011	89
BNH-19013	89
BNH-19020	89
BNH-19021	90
BNH-19022	90
BNH-19023	90
BNH-19026	90
BNH-19040	91
BNH-19041	91
BNH-19042	91
BNH-19046	91
BNH-A80TΦ32	92

93

抗菌防滑无障碍安全扶手	
BNH-901500	94
BNH-901400	94
BNH-901300	94
BNH-90150B	94
BNH-90132	94
BNH-90120(L,R)	94

95

不锈钢浴室安全扶手系列	
ANH-501 Φ 25	95
ANH-501 Φ 32	95
ANH-501C Φ 32	96
ANH-501Y Φ 32	96
ANH-501B Φ 25	96
ANH-501E Φ 25	96

97

全尼龙安全扶手系列	
BNH-N19013	97
BNH-N19030R(右)	98
BNH-N601	98
BNH-N601B	98
BNH-N19020	98
BNH-N9035	99
BNH-N19031	99
BNH-N190121R(右)	99
BNH-N19041R(右)	99
BNH-N19026	100
BNH-N19026A	100
BNH-N19011	100
BNH-N19014	100

101

浴室凳系列	
ANH-N90511	101
ANH-N90512	102
ANH-M90510	102
ANH-M90520	102
ANH-N90510	102

103

卫生间配套五金系列	
CL-4188A	104
AC01-801A	104
AC01-4288A	104
2303	104
2304	105
XT-8700	105
XT-7373	105
XT-7375	105
AXT-7831	016
AXT-7851	106
AXT-7931	106
AXT-7951	106
AXT-71311	107
AXT-71331	107
AXT-71351	107
AXT-71511	107
AXT-71531	108
AXT-71551	108
GT-5740	108
GT-5760	108
GT-5780	109
XT-707	109
XT-708	109
XT02-8303(H)	110
XT02-8305(H)	110
XT02-8103/8106/8112	110
XT02-8203/8206/8212	110
XT02-9106/9206	111
XT02-660	111
XT02-630	111
XT02-650	111
ANT-501 Φ 19 / Φ 25	112
AV-20802	112
AV-20806/20808/20810	112
XT02-021	112
XT02-022A	113
XT02-022	113
XT02-023	113
XT02-024	113
ADQ01-201	114
ADQ01-203	114
ADQ01-101	114
ADQ01-102	114

115

皂液器系列	
SD-1080(1250ml)	116
SD-680(800ml)	116
SD-380(850ml)	116
AD01-460(1200ml)	116

AD01-440(800ml)	117
SD-4010	117
SD-G10110	117
SD-1090	117
SD-10105DE	118
SD-43113 (300ml)	118
SD-43115 (500ml)	118

119

套装挂件 -AX37(P)系列	
AX37-200(P)	121
AX37-301(P)	121
AX37-702(P)	121
AX37-801(P)	122
AX37-261(P)	122
AX37-262(P)	122
AX37-662(P)	122

123

套装挂件-AX37(ACU)系列	
AX37-200(ACU)	123
AX37-301(ACU)	123
AX37-702(ACU)	123
AX37-801(ACU)	124
AX37-261(ACU)	124
AX37-262(ACU)	124
AX37-662(ACU)	124

125

套装挂件-AX37(ORB)系列	
AX37-200(ORB)	125
AX37-301(ORB)	125
AX37-702(ORB)	125
AX37-801(ORB)	126
AX37-261(ORB)	126
AX37-262(ORB)	126
AX37-662(ORB)	126

127

套装挂件 —AX35(P)系列	
AX35-200	127
AX35-301	128
AX35-3011	128
AX35-3012	128
AX35-702	128
AX35-801	129
AX35-261	129
AX35-262	129
AX35-662	129

130

套装挂件-AX35(PVD)系列	
AX35-200(PVD)	131
AX35-301(PVD)	131
AX35-3011(PVD)	131
AX35-702(PVD)	131
AX35-801(PVD)	132
AX35-261(PVD)	132
AX35-262(PVD)	132
AX35-662(PVD)	132

133

套装挂件 -AX30系列	
AX30-200(P)	133
AX30-3011(P)	133
AX30-701(P)	133
AX30-801(P)	134
AX30-261(P)	134
AX30-262(P)	134
AX30-662(P)	134

135

套装挂件 -AX29系列	
AX29-200	135
AX29-301	135
AX29-702	135
AX29-801	136
AX29-261	136
AX29-262	136
AX29-662	136

137

套装挂件 -AX28系列	
AX28-200	137
AX28-3011	137
AX28-701	137
AX28-801	138
AX28-261	138
AX28-262	138
AX28-662	138

139

套装挂件 -AX22系列	
AX22-200	139
AX22-301	139
AX22-701	139
AX22-261	140
AX22-262	140
AX22-662	140
AX22-661-1	140

141

套装挂件 -AX18系列	
AX18-200	141
AX18-301	141
AX18-701	141
AX18-801	142
AX18-261	142
AX18-262	142
AX18-662	142

143

套装挂件 —AX13系列	
AX13-200	143
AX13-301	143
AX13-701	143
AX13-800	144
AX13-261	144
AX13-262	144
AX13-662	144

产品引索

145

套装挂件 -AC51A系列

AC51A-200	146
AC51A-301	146
AC51A-3011	146
AC51A-701	146
AC51A-801	147
AC51A-261	147
AC51A-262	147
AC51A-662	147

148

套装挂件 -AC61系列

AC61-200	149
AC61-301	149
AC61-3011	149
AC61-701	149
AC61-801	150
AC61-261	150
AC61-262	150
AC61-662	150

153

卫浴配套-毛巾架 系列

ANT-101-610	153
ANT-102-610	153
ANT-103-610	153
ANT-108-610	154
ANT-112-610	154
ANT-113-610	154
ANT-6060-1	154

155

卫浴配套-化妆镜系列

XM-170/XM-200	156
XM-1200	156
XM-2217/2220	156
XM-5217/5220	156
XM-6217/6220	157
XM-8218	157
XM-8318	157
AM02-022(468)	157

158

卫浴配套-网篮系列

AW-08111-1A	159
AW-08111-1A(MB)	159
AW-08111-1A(MRG)	159
AW-08111-1A(PVD)	159
AW-08112-1A	160
AW-08112-2	160
AW-08112-1A(MRG)	160
AW-08112-1A(PVD)	160
AW-08121-1A	161
AW-08121-2	161
AW-08122-1A	161
AW-08122-2	161
AW-68111-1A	162
AW-68111-2	162
AW-68111-1A(MB)	162
AW-68111-1A(MRG)	162
AW-68111-1A(PVD)	163
AW-68112-1A	163
AW-68112-2	163
AW-78121-1A	163
AW-68121-2	164
AW-78111-1A	164
AW-78111-2	164
AW-78112-1A	164
AW-78112-2	165
AW-78121-1A	165
AW-78121-2	165

167

卫浴配套-不锈钢+塑料网篮系列

AW-98111SW	168
AW-98111PW	168
AW-98111BW	168
AW-98111WG	168
AW-98121SW	169
AW-98121PW	169
AW-98121BW	169
AW-98121WG	169

170

卫浴配套-钢柠檬地漏系列

PD-33135	171
PD-33145	171
PD-33155	171
PD-33165	171

PD-33125	172
PD-33103	172
PD-33105	172
PD-3365D	172
PD-36108	173
PD-36118	173
PD-36128	173
PD-36138	173
PD-3698	174
PD-34381D S	174
PD-34381D P	174
PD-34391 P	174
PD-34381-3	175
PD-34391-3 P	175
PD-3618D	175
PD-3619D	175
PD-3638D	176
PD-3318D(P/S)	176
PD-3328D	176
PD-3338D(P/S)	176
PD-3388D	177
PD-3378	177
PD-3379	177
PD-3179A	177
PD-31163	178
PD-31183	178
PD-31283	178
PD-31683	178

179

卫浴配套-淋浴房配件-浴室夹系列

6181P/S	179
6182P/S	179
6183P/S	180
6185P/S	180
6281P/S	180
6282P/S	180
6283P/S	181
6285P/S	181
7861	181
7862	181
7863	182
7864	182
7865	182

183

卫浴配套-淋浴房配件-拉手系列

7911	183
7912	183
7890-Φ19/Φ22/Φ25	183
7891-Φ19/Φ22/Φ25	184
7892-Φ19 / Φ22/ Φ25	184
ATD-8870-30X15	184
ATD-8871-30X15	184
ATD-8872-30X15	185
ATD-8873-30X15	185
ATD-8880-30X15	185
ATD-8881-30X15	185
8890-19X19	186
8891-19X19	186
8892-19X19	186

187

卫浴配套-淋浴房配件-龙头/角阀系列

WZA03	187
WZA08	187
WZA12	187
WZB10	188
04-04T701	188
TZA03	188
TZA08	188
TZA12	188
TZB10	188
04-04T702	188
04-04T703	188
BE910B	189
BE910C	189
BE920A	189
BE920B	189
04-04T704	189
04-04T705	189

190

卫浴配套-淋浴房配件-淋浴花洒系列

A13C	191
A15C	191
A16C	192
A37C	192
A62C	192
A62CW	192

AP01C	193
AP01CW	193
AP02C	193
AP03C	193
AP04C	194
AP05C	194
AP06C	194
AP07C	194
AP08C	195
AP08W	195
A02C	195
A02W	195
A28C	196
A35C	196
A40C	196
A41C	196
A43C	197
A48C	197
A51C	197
A56C	197
A58C	198
A60C	198
A59C	198
A59CW	198
A63C	199
A65C	199
AS01GY	199
AS01BU	199
AS01GR	200
AS02C	200
AS02BL	200
AS03C	200
AS04C	201
AS05C	201
AS06C	201
AS07C	201
AS07BL	202
AS08C	202
AS09C	202
A87C	203
A99C	203
A81C	203
A82C	203
A72C	204
A85C	204
A92C	204
A83C	204
A88C	205
A97C	205
A95C	205
A91C	205
A98C	206
A73C	206
A73GY	206

A75C	206
A75BL	207
A76C	207
A86C	207
4143C	208
4159C	208
5158C	208
30S07BL	208
C26C	209
C27C	209
C28C	209
C29C	209
C30C	210
C30BL	210
C101C	210
E753B	210
E756	210
B01C	211
B02C	211
B04C	211
B08C	211
C18C	212
C19C	212
C20C	212
C21C	212

214

厨房挂件系列

AK-01B102	215
AK-01B103	215
AK-01B105	215
AK-01B106	215
AK-01B107	216
AK-01B110	216
AK-01B111	216



公卫系统系列产品

Public Health System Series Products

手纸箱 —D 系列	47
手纸箱 —全封门系列	51
手纸箱 —C 系列	53
手纸箱 —经典系列	57
蓝创 —A 系列	67
卷纸架系列	75
爱丁堡系列	82
防滑残弱人扶手系列	85
不锈钢残弱人扶手系列	87
抗菌防滑无障碍安全扶手系列	93
不锈钢浴室安全扶手系列	95
全尼龙安全扶手系列	97
浴室凳系列	101
卫生间配套五金系列	103
皂液器系列	115



公卫系统系列产品

Public Health System Series Products

PAPER TOWEL DISPENSER

手纸箱 —
D 系列

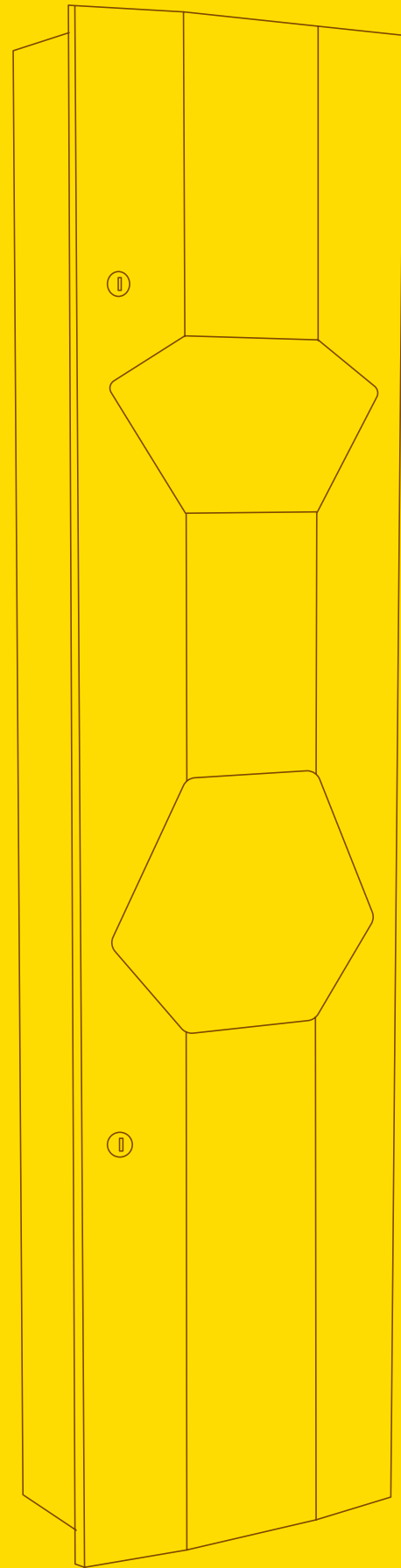

TD-8300D

大卷纸箱
JUMBO-ROLL TISSUE DISPENSER
主要材料：不锈钢 304
表面处理：镜光
Main Material: 304 stainless steel
Surface processing: Polish finished

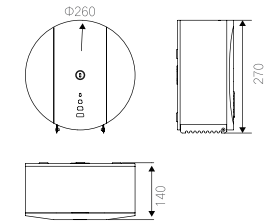

TD-8300TD

大卷纸箱 (带平台)
JUMBO-ROLL TISSUE DISPENSER(WITH PLATFORM)
主要材料：不锈钢 304
表面处理：镜光
Main Material: 304 stainless steel
Surface processing: Polish finished

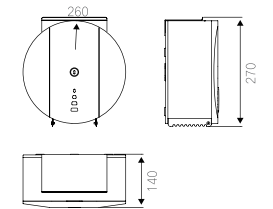

TD-8340D

马桶垫纸箱
PAPER TOWEL DISPENSER
主要材料：不锈钢 304
表面处理：镜光
Main Material: 304 stainless steel
Surface processing: Polish finished

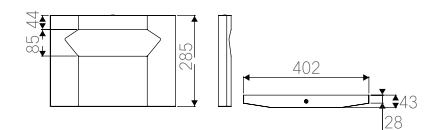



TD-83318D

手纸箱 (入墙式)
 PAPER TOWEL DISPENSER(RECESSED)
 主要材料: 不锈钢 304
 表面处理: 砂光
 Main Material: 304 stainless steel
 Surface processing: Satin finished

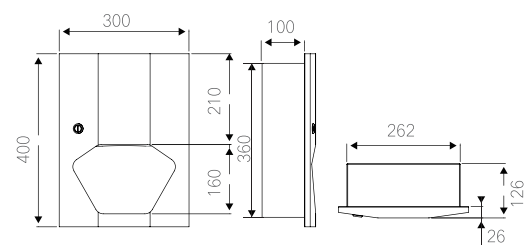

TD-8332D

手纸箱 (入墙式)
 PAPER TOWEL DISPENSER(RECESSED)
 主要材料: 不锈钢 304
 表面处理: 砂光
 Main Material: 304 stainless steel
 Surface processing: Satin finished

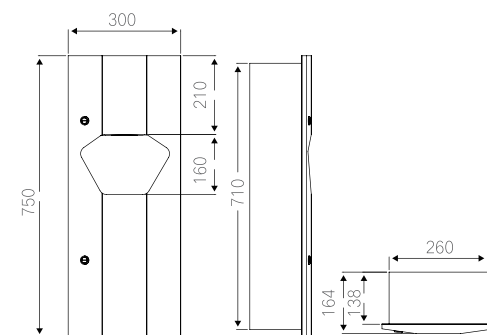

TD-8334D

手纸箱 (入墙式)
 PAPER TOWEL DISPENSER(RECESSED)
 主要材料: 不锈钢 304
 表面处理: 砂光
 Main Material: 304 stainless steel
 Surface processing: Satin finished

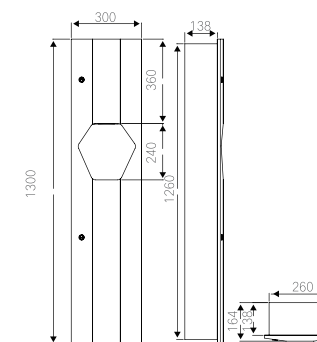

TD-8337D

带干手器手纸箱 (入墙式)
 PAPER TOWEL DISPENSER WITH HAND DRYER(RECESSED)
 主要材料: 不锈钢 304
 表面处理: 砂光
 Main Material: 304 stainless steel
 Surface processing: Satin finished

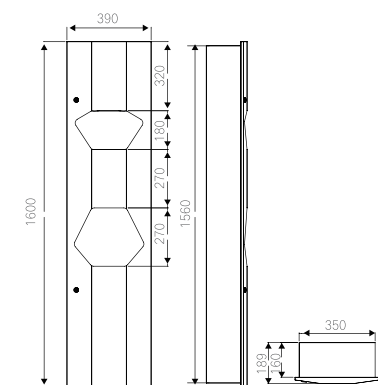

PAPER TOWEL DISPENSER

手纸箱 — 全封门系列



TD-83318

全封门手纸箱 (入墙式)
PAPER TOWEL DISPENSER(RECESSED)

主要材料: 不锈钢 304
表面处理: 砂光
Main Material: 304 stainless steel
Surface processing: Satin finished

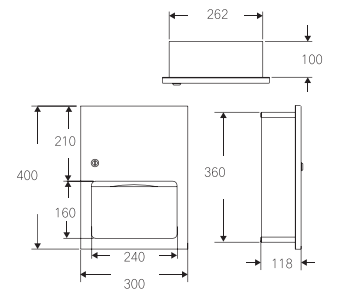

TD-83348

全封门手纸箱 (入墙式)
PAPER TOWEL DISPENSER(RECESSED)

主要材料: 不锈钢 304
表面处理: 砂光
Main Material: 304 stainless steel
Surface processing: Satin finished

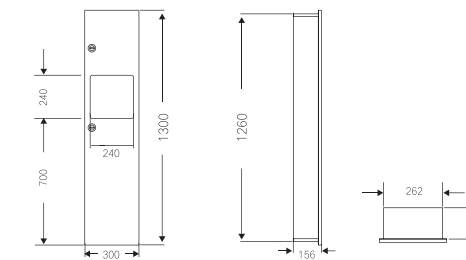

TD-83328

全封门手纸箱 (入墙式)
PAPER TOWEL DISPENSER(RECESSED)

主要材料: 不锈钢 304
表面处理: 砂光
Main Material: 304 stainless steel
Surface processing: Satin finished

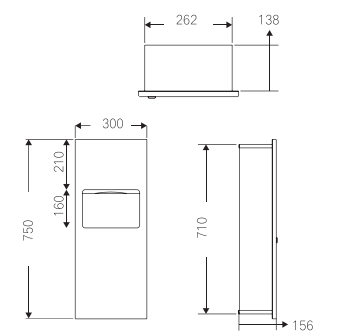

TD-83398

全封门手纸箱 (入墙式)
PAPER TOWEL DISPENSER(RECESSED)

主要材料: 不锈钢 304
表面处理: 砂光
Main Material: 304 stainless steel
Surface processing: Satin finished

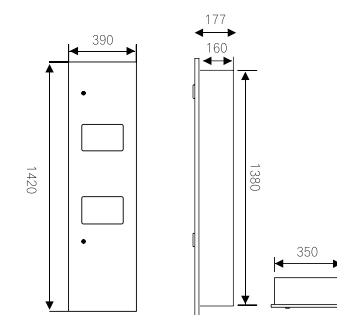

PAPER TOWEL DISPENSER

手纸箱 —
C 系列

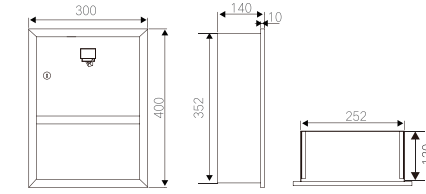
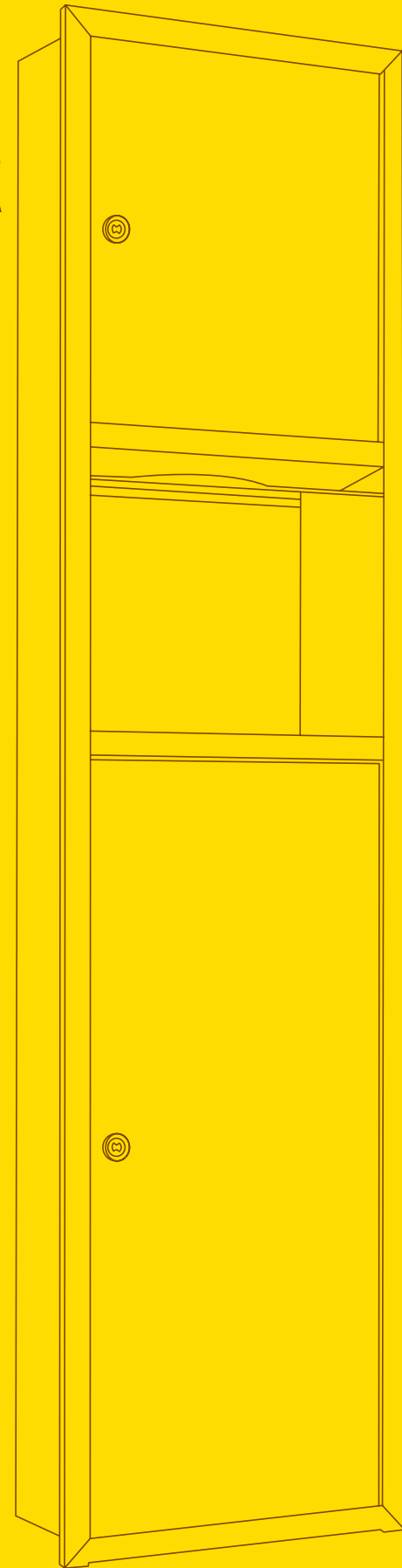

TD-83318C

手纸箱（入墙式）
PAPER TOWEL DISPENSER[RECESSED]

主要材料：不锈钢 304
表面处理：砂光
Main Material: 304 stainless steel
Surface processing: Satin finished



TD-8334C

手纸箱（入墙式）
PAPER TOWEL DISPENSER[RECESSED]

主要材料：不锈钢 304
表面处理：砂光
Main Material: 304 stainless steel
Surface processing: Satin finished

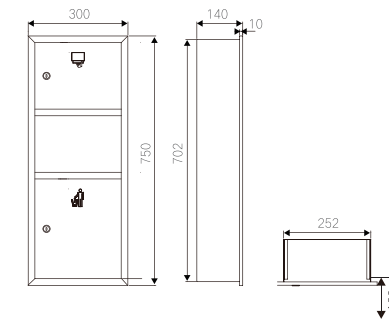

TD-8332C

手纸箱（入墙式）
PAPER TOWEL DISPENSER[RECESSED]

主要材料：不锈钢 304
表面处理：砂光
Main Material: 304 stainless steel
Surface processing: Satin finished

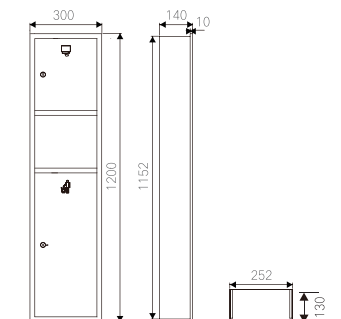



TD-8337C

带干手器手纸箱（入墙式）
PAPER TOWEL DISPENSER WITH HAND DRYER
[3 IN 1 PAPER DISPENSER]

主要材料：不锈钢 304
表面处理：砂光
Main Material: 304 stainless steel
Surface processing: Satin finished

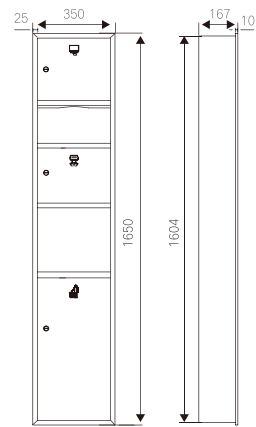

TD-8334C(PVD)

手纸箱（入墙式）
PAPER TOWEL DISPENSER[RECESSED]

主要材料：不锈钢 304
表面处理：钛金
Main Material: 304 stainless steel
Surface processing: PVD

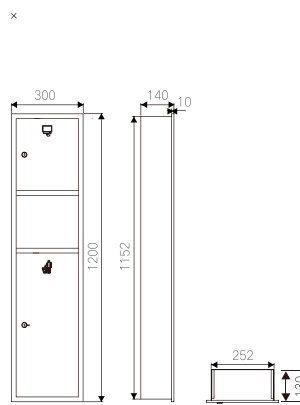

TD-8334C(MRG)

手纸箱（入墙式）
PAPER TOWEL DISPENSER[RECESSED]

主要材料：不锈钢 304
表面处理：玫瑰金
Main Material: 304 stainless steel
Surface processing: MRG

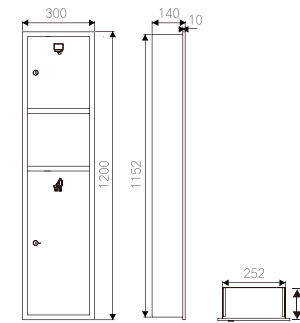

TD-8334C(SB)

手纸箱（入墙式）
PAPER TOWEL DISPENSER[RECESSED]

主要材料：不锈钢 304
表面处理：雅黑
Main Material: 304 stainless steel
Surface processing: SB

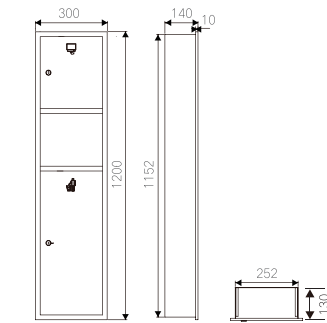

PAPER TOWEL DISPENSER

手纸箱 —
经典系列

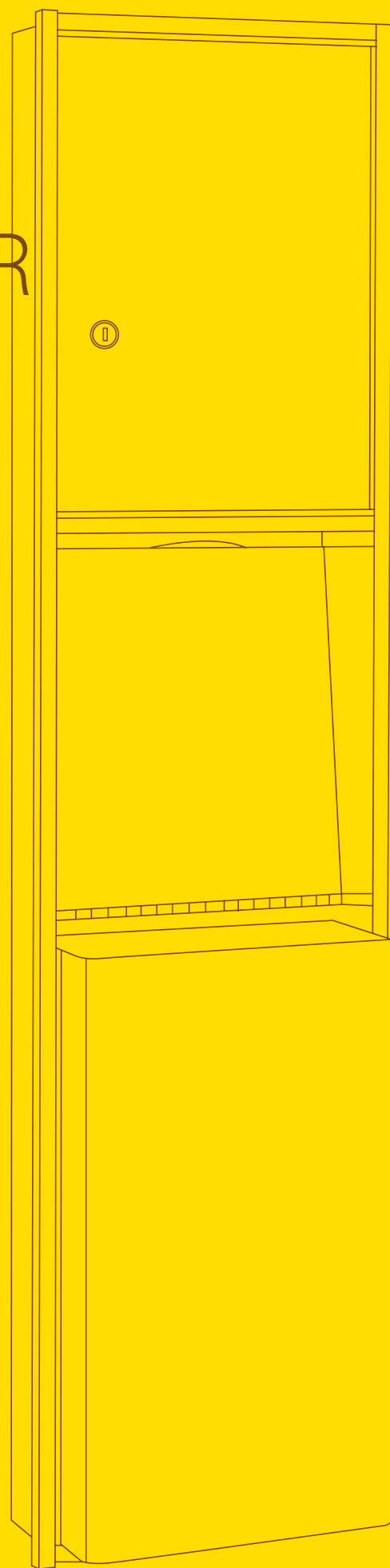

TD-8332A

手纸箱 (入墙式)
PAPER TOWEL DISPENSER (RECESSED)

主要材料: 不锈钢 304
表面处理: 砂光
Main Material: 304 stainless steel
Surface processing: Satin finished

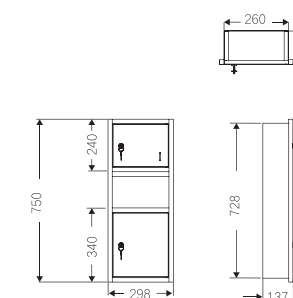

TD-8333A

手纸箱 (挂墙式)
PAPER TOWEL DISPENSER (WALL-MOUNTED)

主要材料: 不锈钢 304
表面处理: 砂光
Main Material: 304 stainless steel
Surface processing: Satin finished

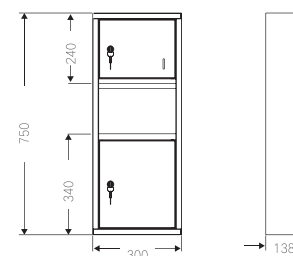

TD-8334A-1200

手纸箱 (入墙式)
PAPER TOWEL DISPENSER (RECESSED)

主要材料: 不锈钢 304
表面处理: 砂光
Main Material: 304 stainless steel
Surface processing: Satin finished

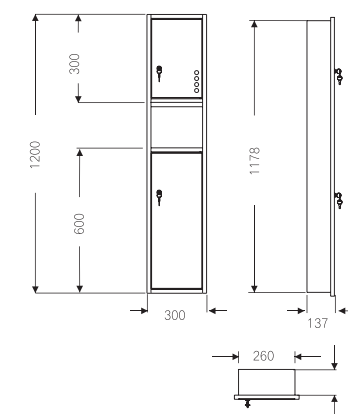



TD-8334A

手纸箱 (入墙式)
PAPER TOWEL DISPENSER (RECESSED)

主要材料: 不锈钢 304
表面处理: 砂光
Main Material: 304 stainless steel
Surface processing: Satin finished

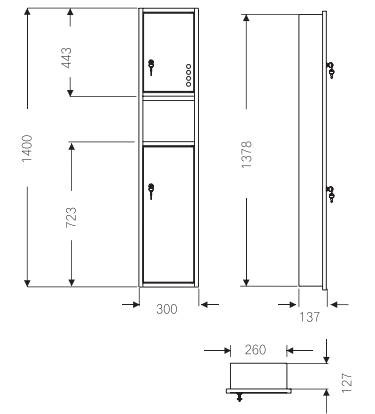

TD-8335A

手纸箱 (挂墙式)
PAPER TOWEL DISPENSER (WALL-MOUNTED)

主要材料: 不锈钢 304
表面处理: 砂光
Main Material: 304 stainless steel
Surface processing: Satin finished

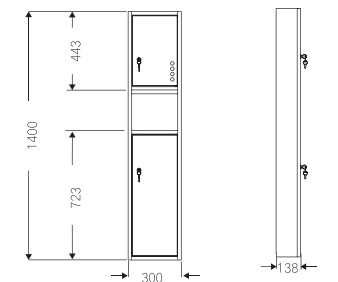

TD-8336A

手纸箱 (入墙式)
PAPER TOWEL DISPENSER (RECESSED)

主要材料: 不锈钢 304
表面处理: 砂光
Main Material: 304 stainless steel
Surface processing: Satin finished

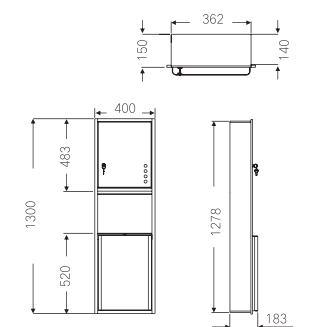



TD-83368A

手纸箱 (入墙式)
PAPER TOWEL DISPENSER (RECESSED)

主要材料: 不锈钢 304
表面处理: 砂光
Main Material: 304 stainless steel
Surface processing: Satin finished

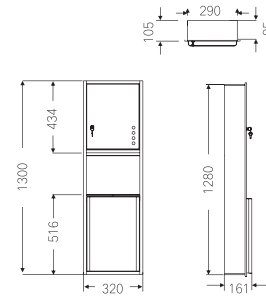

TD-8337A

带干手器手纸箱 (入墙式)
PAPER TOWEL DISPENSER WITH HAND DRYER (RECESSED)

主要材料: 不锈钢 304
表面处理: 砂光
Main Material: 304 stainless steel
Surface processing: Satin finished

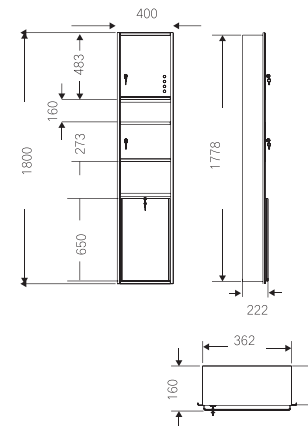

TD-83378

带干手器手纸箱 (入墙式)
PAPER TOWEL DISPENSER WITH HAND DRYER (RECESSED)

主要材料: 不锈钢 304
表面处理: 砂光
Main Material: 304 stainless steel
Surface processing: Satin finished

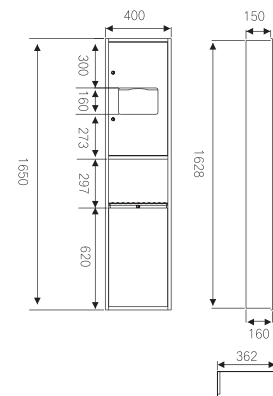

TD-8304

手纸盒 (入墙式)
TISSUE DISPENSER (RECESSED)

主要材料: 不锈钢 304
表面处理: 镜光, 砂光
Main Material: 304 stainless steel
Surface processing: Polish finished, Satin finished

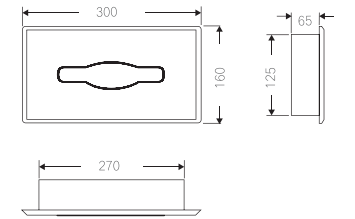

TD08-313

手纸盒
TISSUE DISPENSER

主要材料: 不锈钢 304
表面处理: 镜光
Main Material: 304 stainless steel
Surface processing: Polish finished

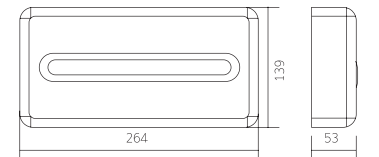

TD08-314

一字形手纸盒 (入墙式)
TISSUE DISPENSER (RECESSED)

主要材料: 不锈钢 304
表面处理: 镜光
Main Material: 304 stainless steel
Surface processing: Polish finished

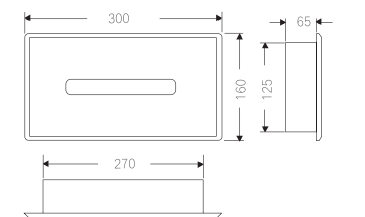



TD08-315

手纸箱
TISSUE DISPENSER

主要材料：不锈钢 304
表面处理：镜光
Main Material: 304 stainless steel
Surface processing: Polish finished

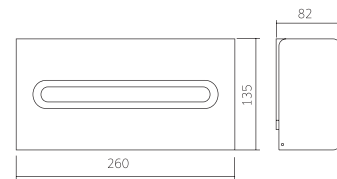

TD-8314A

手纸箱
PAPER TOWEL DISPENSER

主要材料：不锈钢 304
表面处理：镜光, 砂光
Main Material: 304 stainless steel
Surface processing: Polish finished, Satin finished

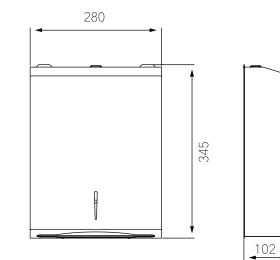

TD08-322TA

手纸箱
PAPER TOWEL DISPENSER

主要材料：不锈钢 304
表面处理：砂光
Main Material: 304 stainless steel
Surface processing: Satin finished

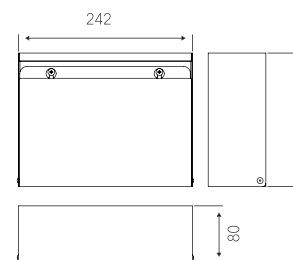

TD-8340

马桶垫纸箱
PAPER TOWEL DISPENSER

主要材料：不锈钢 304
表面处理：镜光, 砂光
Main Material: 304 stainless steel
Surface processing: Polish finished, Satin finished

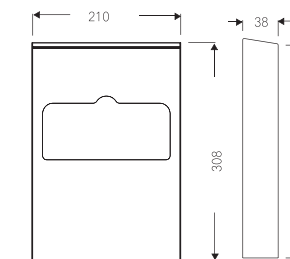

TD-8313A

手纸箱
PAPER TOWEL DISPENSER

主要材料：不锈钢 304
表面处理：镜光, 砂光
Main Material: 304 stainless steel
Surface processing: Polish finished, Satin finished

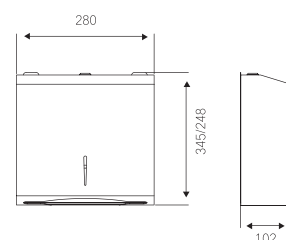

TD-8300A

大卷厕纸箱
JUMBO-ROLL TISSUE DISPENSER

主要材料：不锈钢 304
表面处理：镜光, 砂光
Main Material: 304 stainless steel
Surface processing: Polish finished, Satin finished

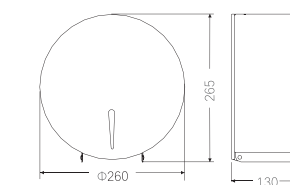



TD-8300T

大卷纸箱 (带平台)
JUMBO-ROLL TISSUE DISPENSER
(WITH PLATFORM)

主要材料: 不锈钢 304
表面处理: 砂光
Main Material: 304 stainless steel
Surface processing: Satin finished

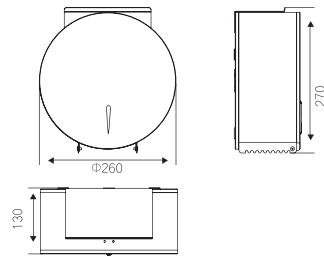

TD08-321

镜后手纸箱
PAPER TOWEL DISPENSER

主要材料: 不锈钢 304
表面处理: 砂光
Main Material: 304 stainless steel
Surface processing: Satin finished

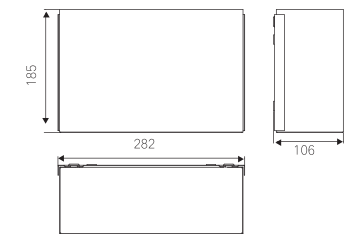

TD-8330A

大卷厕纸箱
JUMBO-ROLL TISSUE DISPENSER

主要材料: 不锈钢 304
表面处理: 镜光, 砂光
Main Material: 304 stainless steel
Surface processing: Polish finished, Satin finished

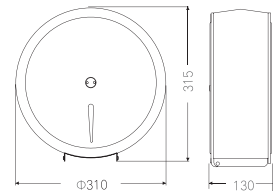

TD08-323

镜后组合箱 (手纸、液皂)
2 in 1 RECESSED DISPENSER
(PAPER & SOAP)

主要材料: 不锈钢 304
表面处理: 砂光
Main Material: 304 stainless steel
Surface processing: Satin finished

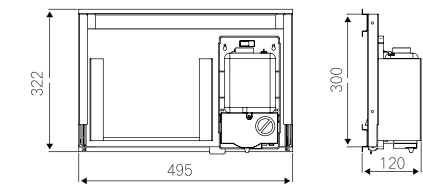

TD08-320

镜后手纸箱
PAPER TOWEL DISPENSER

主要材料: 不锈钢 304
表面处理: 砂光
Main Material: 304 stainless steel
Surface processing: Satin finished

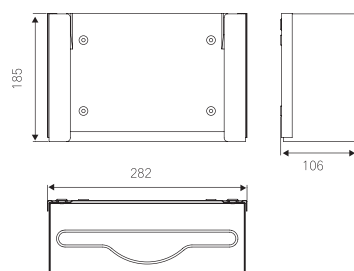

TD08-323 补纸换液步骤:

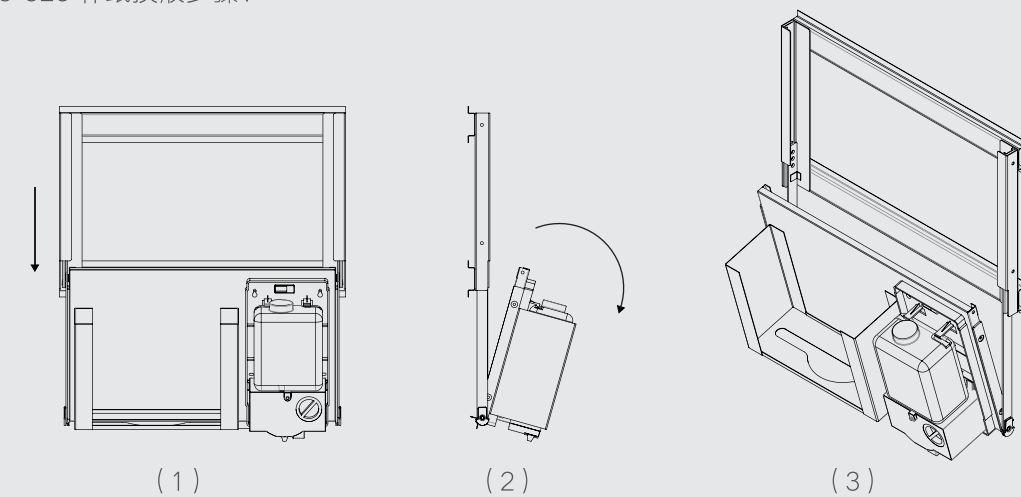

THINK
BLUE!

蓝创 —
A 系列

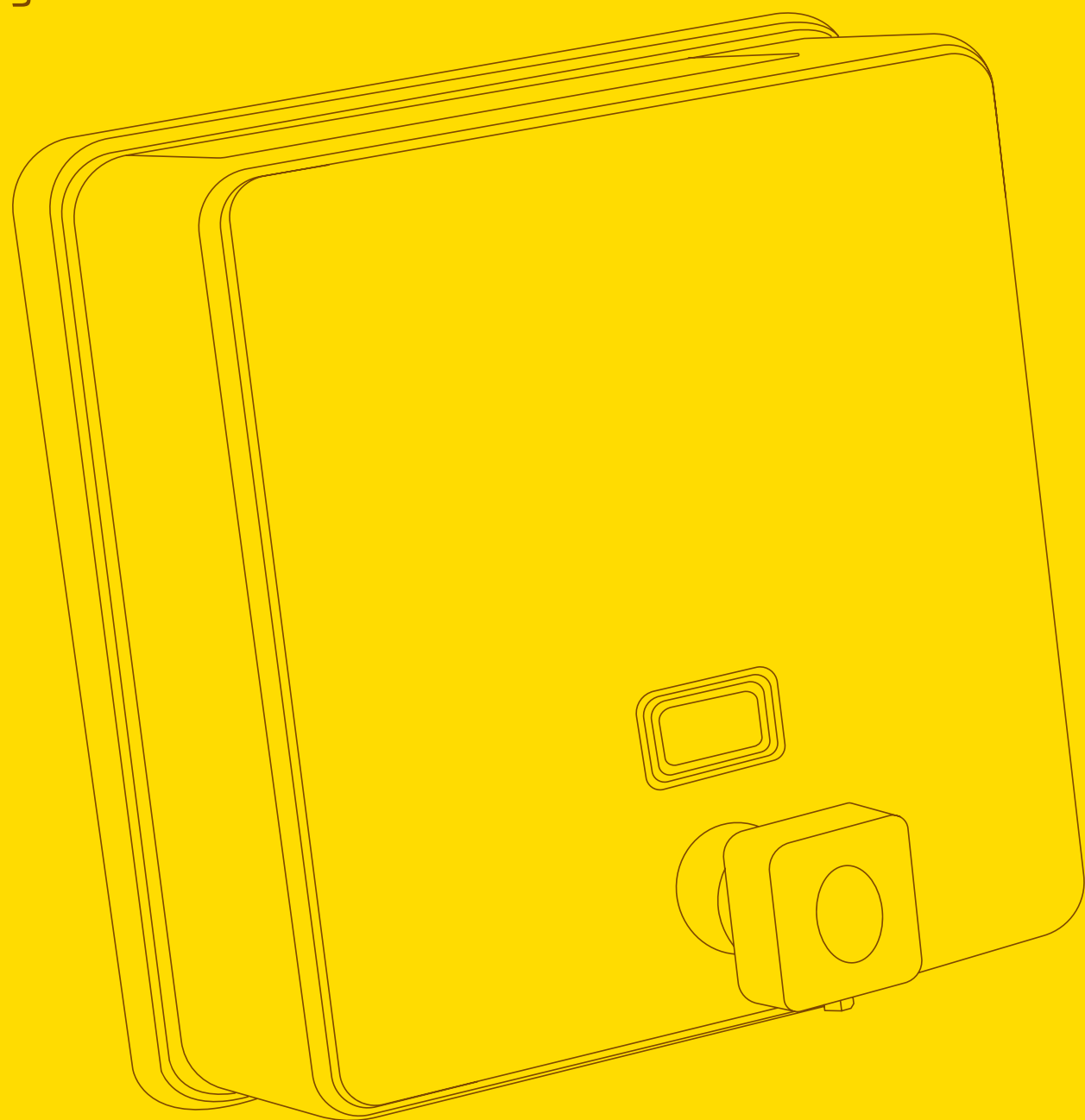

Think Blue! 蓝创未来

独创科技，环保设计，历久不变!

顶尖的设计，无一例外都考虑到人与自然的微妙平衡，崇尚环保的ATGET雅之杰，在考虑产品的使用体验的同时，更加充分考虑产品的耐用性和环保性，所以，于2015年，悉心设计了“蓝创A”系列新产品。

Top design, considering the subtle balance of human being and nature without exception. Same as ATGET advocate environmental protection, fully considering product's usage experience and durability and environmental protection. Thus, we design the "Think Blue A" series in 2015.

蓝创A系列——采用了高强度、高耐磨、抗腐蚀的PA747新科技塑料，同时，运用凸显现代科技的蓝色高冷外观。

"Think Blue A" series—adopted the high strength, hard-wearing and erosion-resisting PA747 plastic material, build up the blue elegant appearance of modern science and technology.

- ◆ “蓝创A”系列的液皂器喷嘴，使用寿命达到100万次；
- ◆ “Think Blue A” series—PA747 pump for soap dispenser, the duration can be reached 1 millions times;

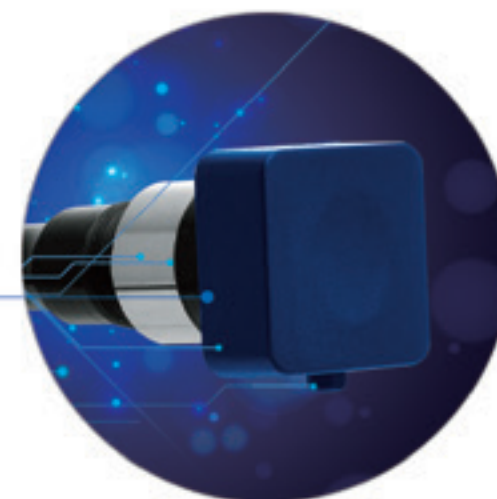

- ◆ “蓝创A”系列的浴室扶手，巧妙运用不锈钢和高科技塑料的结合，大大提高安装的简易性和牢固度。
- ◆ “Think Blue A” series—Bathroom grab bar, perfectly combine the stainless steel with high-tech plastic, make the products become easier to install and more durable.

- ◆ “蓝创A”系列的手纸箱门锁，采用意大利技术，使用寿命达到3万次；
- ◆ “Think Blue A” series—Keys for Paper Holder Dispenser, adopted Italia technology, the duration can be reached 30 thousand times;





TD-A83371B

带干手器手纸箱（入墙式）
PAPER TOWEL DISPENSER WITH HAND DRYER
[3 IN 1 PAPER DISPENSER]

主要材料：不锈钢 304
表面处理：砂光
Main Material: 304 stainless steel
Surface processing: Satin finished

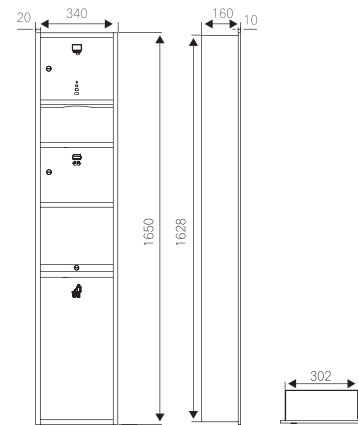

TD-A83341B

手纸箱（入墙式）
PAPER TOWEL DISPENSER[RECESSED]

主要材料：不锈钢 304
表面处理：砂光
Main Material: 304 stainless steel
Surface processing: Satin finished

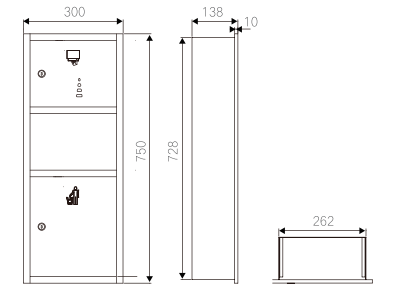
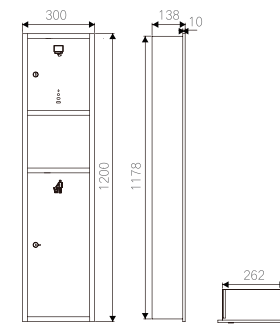

TD-A83321B

手纸箱（入墙式）
PAPER TOWEL DISPENSER[RECESSED]

主要材料：不锈钢 304
表面处理：砂光
Main Material: 304 stainless steel
Surface processing: Satin finished



TD-A8314A1B

手纸箱
PAPER TOWEL DISPENSER

主要材料：不锈钢 304
表面处理：砂光
Main Material: 304 stainless steel
Surface processing: Satin finished

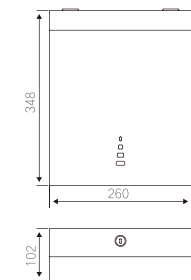



TD-A83001B

大卷纸箱
JUMBO-ROLL TISSUE DISPENSER

主要材料：不锈钢 304
表面处理：砂光
Main Material: 304 stainless steel
Surface processing: Satin finished

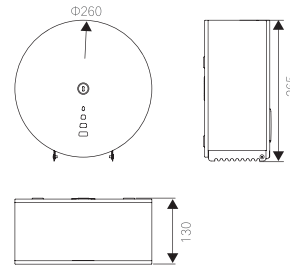

TD-A8300TB

大卷纸箱 (带平台)
JUMBO-ROLL TISSUE DISPENSER(WITH PLATFORM)

主要材料：不锈钢 304
表面处理：砂光
Main Material: 304 stainless steel
Surface processing: Satin finished

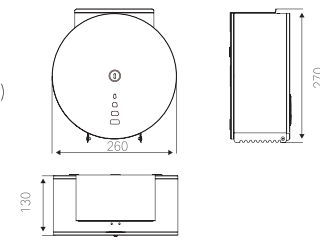

TD-A83401B

马桶垫纸箱
PAPER TOWEL DISPENSER

主要材料：不锈钢 304
表面处理：砂光
Main Material: 304 stainless steel
Surface processing: Satin finished

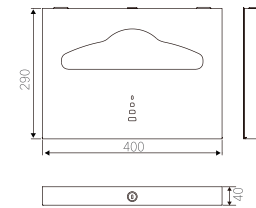

TD-A833181B

手纸箱 (入墙式)
PAPER TOWEL DISPENSER[RECESSED]

主要材料：不锈钢 304
表面处理：砂光
Main Material: 304 stainless steel
Surface processing: Satin finished

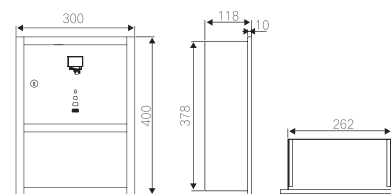

ANH-A75BΦ25

浴室扶手
BATHROOM GRAB BAR

主要材料：不锈钢 304
表面处理：砂光
Main Material: 304 stainless steel
Surface processing: Satin finished

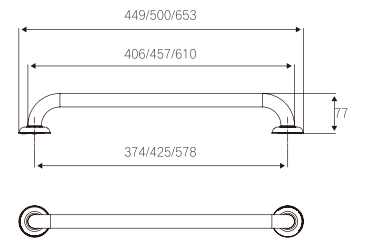

ANH-A75BΦ32

浴室扶手
BATHROOM GRAB BAR

主要材料：不锈钢 304
表面处理：砂光
Main Material: 304 stainless steel
Surface processing: Satin finished

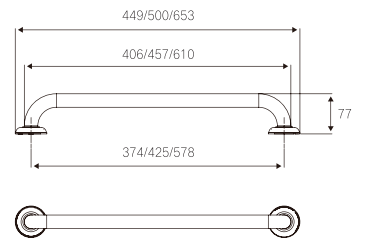



SD-380B(500ml)

皂液器
SOAP DISPENSER

主要材料：不锈钢 304
表面处理：砂光
Main Material: 304 stainless steel
Surface processing: Satin finished

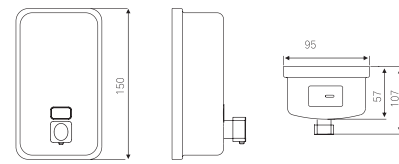

SD-680B(800ml)

皂液器
SOAP DISPENSER

主要材料：不锈钢 304
表面处理：砂光
Main Material: 304 stainless steel
Surface processing: Satin finished

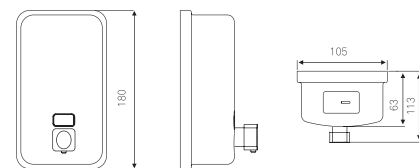

SD-1080B(1250ml)

皂液器
SOAP DISPENSER

主要材料：不锈钢 304
表面处理：砂光
Main Material: 304 stainless steel
Surface processing: Satin finished

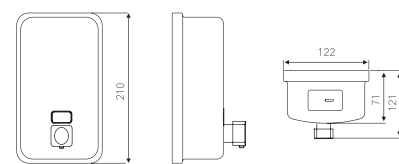

SD-A10115B(1500ml)

皂液器
SOAP DISPENSER

主要材料：不锈钢 304
表面处理：砂光
Main Material: 304 stainless steel
Surface processing: Satin finished

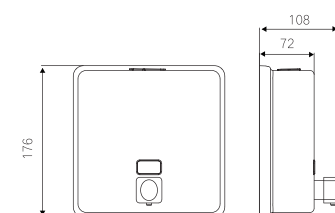

AS01-A021

卷纸架 (带平台)
PAPER HOLDER(WITH PLATFORM)

主要材料：不锈钢 304
表面处理：镜光
Main Material: 304 stainless steel
Surface processing: Polish finished

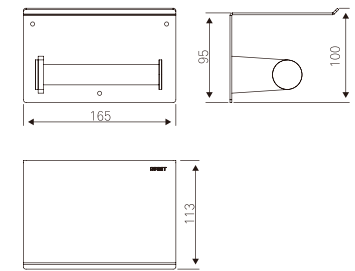

AS01-A022W

双卷纸架 (带平台)
DOUBLE PAPER HOLDER(WITH PLATFORM)

主要材料：不锈钢 304
表面处理：镜光
Main Material: 304 stainless steel
Surface processing: Polish finished

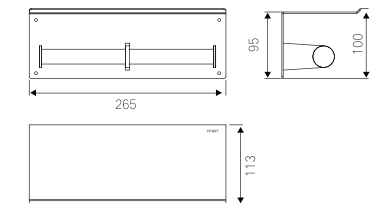

PAPER HOLDER

卷纸架 系列

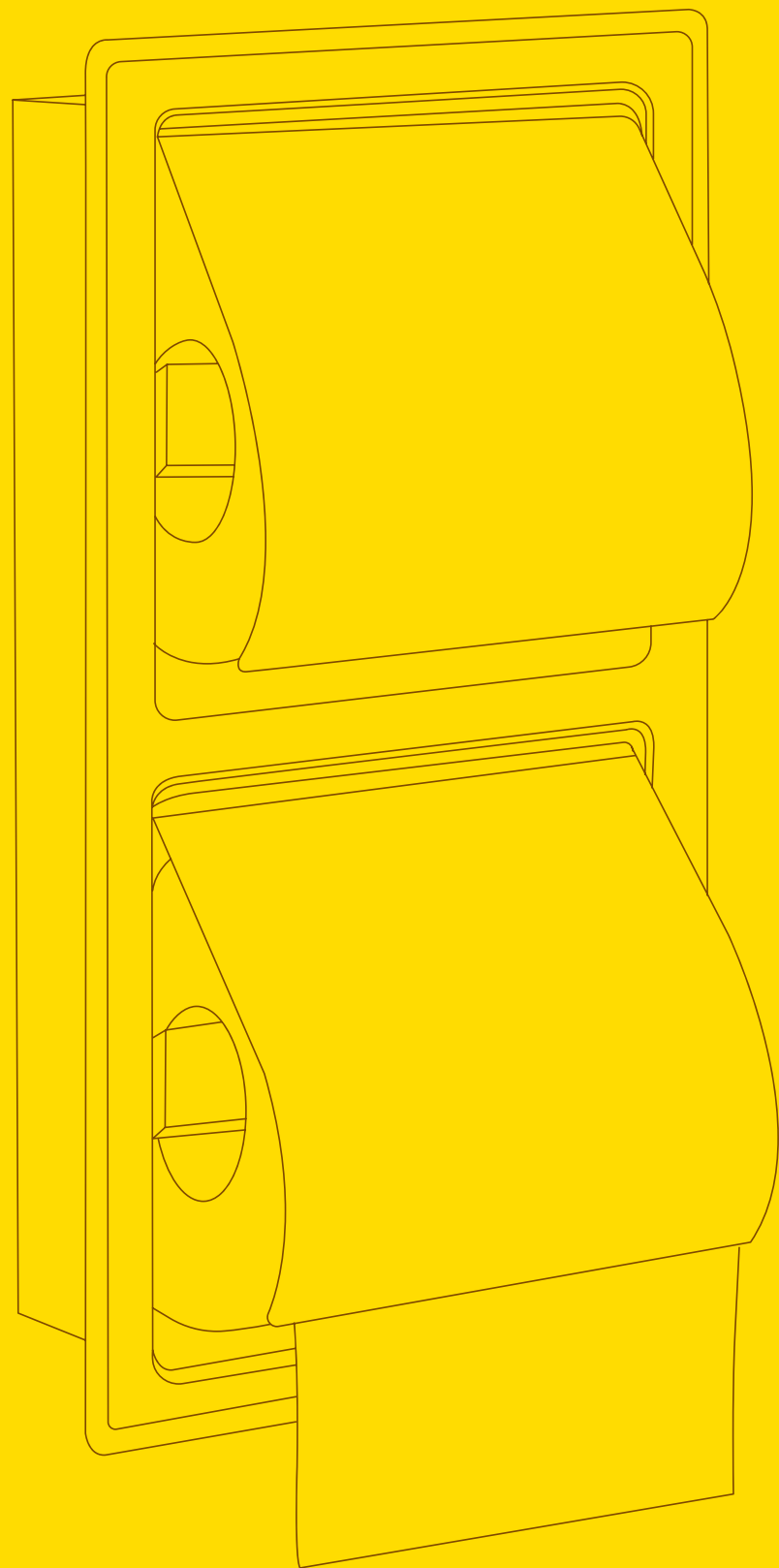

TD-130A

卷纸架
PAPER HOLDER

主要材料: 不锈钢 304
表面处理: 镜光, 砂光
Main Material: 304 stainless steel
Surface processing: Polish finished, Satin finished

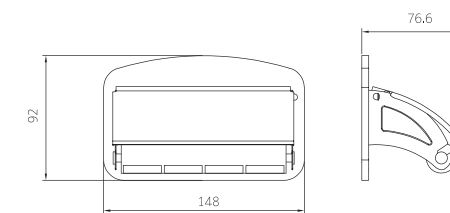

TD-131A

卷纸架
PAPER HOLDER

主要材料: 不锈钢 304
表面处理: 镜光, 砂光
Main Material: 304 stainless steel
Surface processing: Polish finished, Satin finished

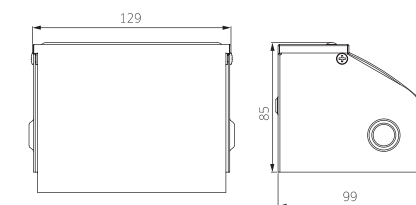

TD-231A

卷纸架 (入墙式)
PAPER HOLDER (RECESSED)

主要材料: 不锈钢 304
表面处理: 镜光, 砂光
Main Material: 304 stainless steel
Surface processing: Polish finished, Satin finished

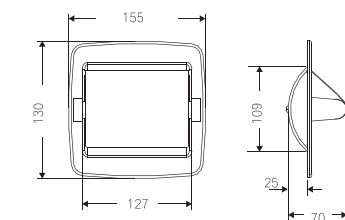

TD-232A

卷纸架 (入墙式)
PAPER HOLDER (RECESSED)

主要材料: 不锈钢 304
表面处理: 镜光, 砂光
Main Material: 304 stainless steel
Surface processing: Polish finished, Satin finished

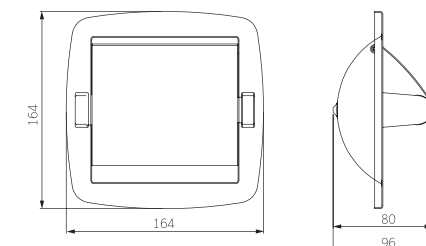



TD-1122A

卷纸架
PAPER HOLDER

主要材料: 不锈钢 304
表面处理: 镜光, 砂光
Main Material: 304 stainless steel
Surface processing: Polish finished, Satin finished

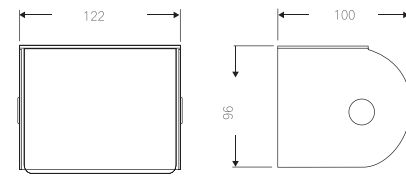

TD-2371

卷纸架
PAPER HOLDER

主要材料: 不锈钢 304
表面处理: 镜光
Main Material: 304 stainless steel
Surface processing: Polish finished

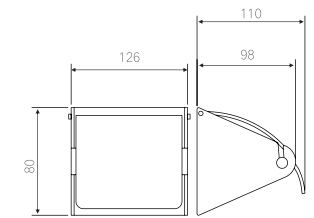

TD-333D

卷纸架
PAPER HOLDER

主要材料: 不锈钢 304
表面处理: 镜光, 砂光
Main Material: 304 stainless steel
Surface processing: Polish finished, Satin finished

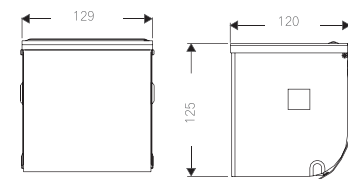

TD-2372

带锁双卷纸架 (横式)
DOUBLE PAPER HOLDER WITH LOCK
(HORIZONTAL)
主要材料: 不锈钢 304
表面处理: 镜光
Main Material: 304 stainless steel
Surface processing: Polish finished

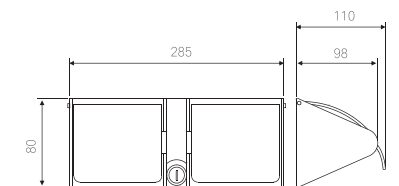

TD-2332W

方座双卷纸架 (横式)
DOUBLE PAPER HOLDER
(RECESSED / HORIZONTAL)

主要材料: 不锈钢 304
表面处理: 镜光, 砂光
Main Material: 304 stainless steel
Surface processing: Polish finished, Satin finished

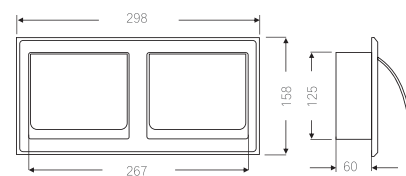

TD-233

卷纸架 (入墙式)
PAPER HOLDER (RECESSED)

主要材料: 不锈钢 304
表面处理: 镜光, 砂光
Main Material: 304 stainless steel
Surface processing: Polish finished, Satin finished

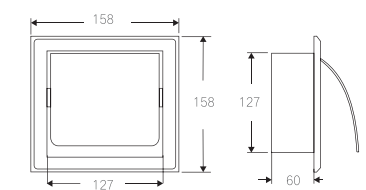

TD-2332L

方座双卷纸架 (竖式)
DOUBLE PAPER HOLDER (RECESSED / VERTICAL)

主要材料: 不锈钢 304
表面处理: 镜光, 砂光
Main Material: 304 stainless steel
Surface processing: Polish finished, Satin finished

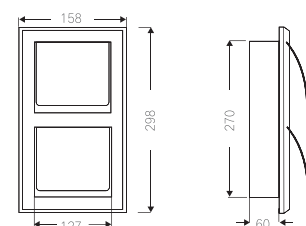

TD-233C

卷纸架 (入墙式)
PAPER HOLDER (RECESSED)

主要材料: 不锈钢 304
表面处理: 镜光, 砂光
Main Material: 304 stainless steel
Surface processing: Polish finished, Satin finished

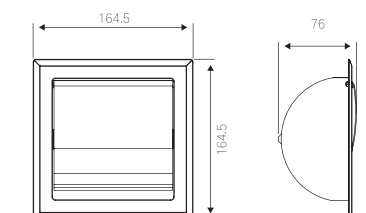



TD-233E

方座卷纸架
PAPER HOLDER

主要材料：不锈钢 304
表面处理：镜光
Main Material: 304 stainless steel
Surface processing: Polish finished

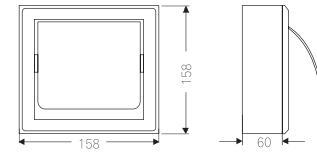

TD-8305D

烟缸卷纸架
PAPER HOLDER WITH ASHTRAY

主要材料：不锈钢 304
表面处理：镜光，砂光
Main Material: 304 stainless steel
Surface processing: Polish finished, Satin finished

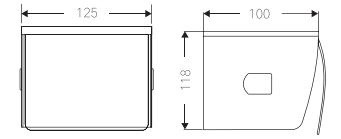

TD-83A6

卷纸架
PAPER HOLDER

主要材料：不锈钢 304
表面处理：镜光
Main Material: 304 stainless steel
Surface processing: Polish finished

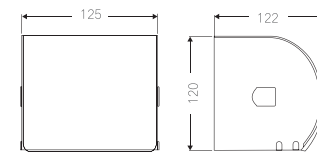

TD-8305D-2

无烟缸卷纸架
PAPER HOLDER

主要材料：不锈钢 304
表面处理：镜光，砂光
Main Material: 304 stainless steel
Surface processing: Polish finished, Satin finished

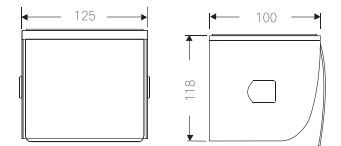

TD-8301D

卷纸架 (入墙式)
PAPER HOLDER (RECESSED)

主要材料：不锈钢 304
表面处理：镜光，砂光
Main Material: 304 stainless steel
Surface processing: Polish finished, Satin finished

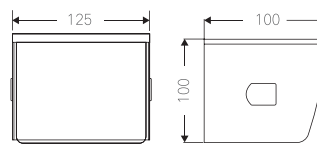

TD-8325W

带碟双卷纸架 (横式)
DOUBLE PAPER HOLDER WITH ASHTRAY
(HORIZONTAL)

主要材料：不锈钢 304
表面处理：镜光，砂光
Main Material: 304 stainless steel
Surface processing: Polish finished, Satin finished

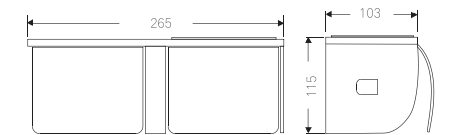

TD-8302W

双卷纸架 (横式)
DOUBLE PAPER HOLDER (HORIZONTAL)

主要材料：不锈钢 304
表面处理：镜光，砂光
Main Material: 304 stainless steel
Surface processing: Polish finished, Satin finished

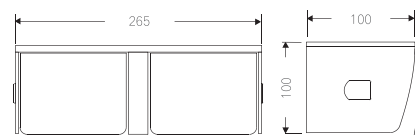

TD-8325L

带碟双卷纸架 (竖式)
DOUBLE PAPER HOLDER WITH ASHTRAY
(VERTICAL)

主要材料：不锈钢 304
表面处理：镜光，砂光
Main Material: 304 stainless steel
Surface processing: Polish finished, Satin finished

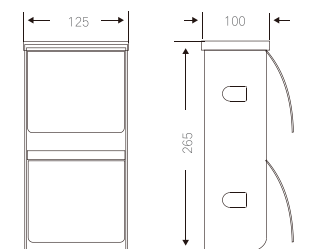

TD-8325-2W



无碟双卷纸架 (横式)
DOUBLE PAPER HOLDER WITH ASHTRAY
(HORIZONTAL)
主要材料: 不锈钢 304
表面处理: 镜光, 砂光
Main Material: 304 stainless steel
Surface processing: Polish finished, Satin finished

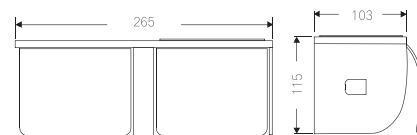

TD-8325-2L



双卷纸架 (竖式)
DOUBLE PAPER HOLDER WITH ASHTRAY
(VERTICAL)
主要材料: 不锈钢 304
表面处理: 镜光, 砂光
Main Material: 304 stainless steel
Surface processing: Polish finished, Satin finish

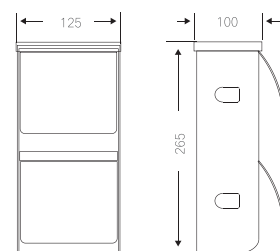

EDINBURGH SERIES

爱丁堡 系列

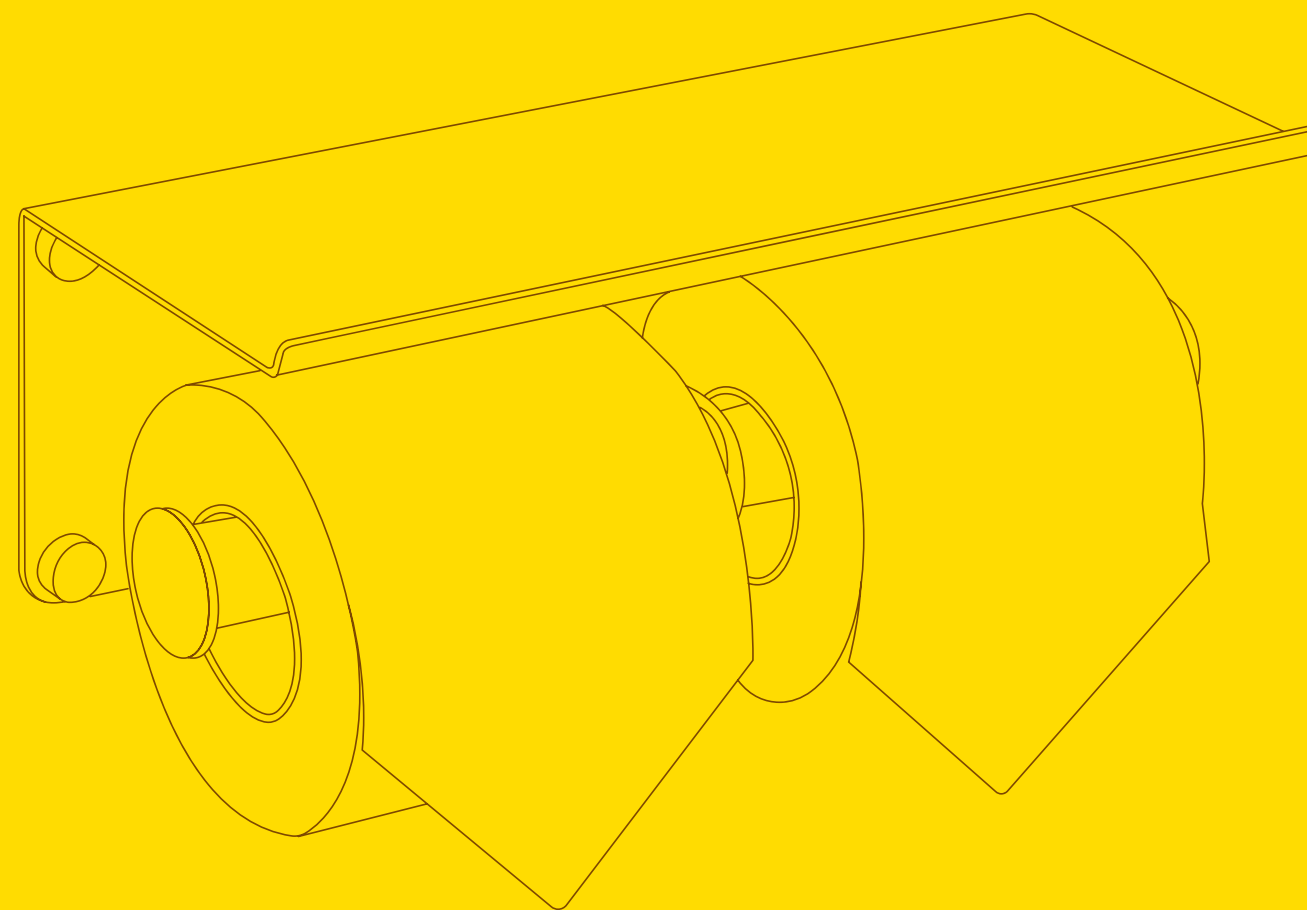

AS01-020



置物平台
BRACKET FOR CELLPHONE

主要材料: 不锈钢 304
表面处理: 镜光, 砂光
Main Material: 304 stainless steel
Surface processing: Polish finished, Satin finished

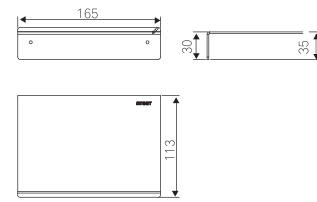

AS01-021



卷纸架 (带平台)
PAPER HOLDER (WITH PLATFORM)

主要材料: 不锈钢 304
表面处理: 镜光, 砂光
Main Material: 304 stainless steel
Surface processing: Polish finished, Satin finished

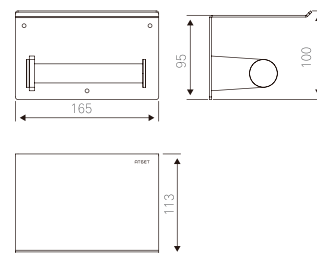

AS01-022



双卷纸架 (带平台)
DOUBLE PAPER HOLDER (WITH PLATFORM)

主要材料: 不锈钢 304
表面处理: 镜光, 砂光
Main Material: 304 stainless steel
Surface processing: Polish finished, Satin finished

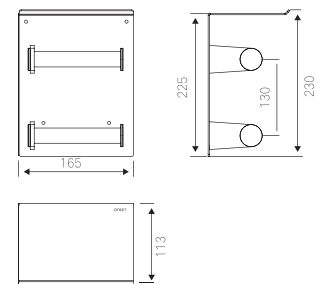

AS01-022W



双卷纸架 (带平台)
DOUBLE PAPER HOLDER (WITH PLATFORM)

主要材料: 不锈钢 304
表面处理: 镜光, 砂光
Main Material: 304 stainless steel
Surface processing: Polish finished, Satin finished

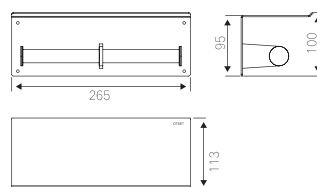

AS01-023

锁轴式卷纸架 (带平台)
PAPER HOLDER WITH LOCK (WITH PLATFORM)

主要材料: 不锈钢 304
表面处理: 镜光, 砂光
Main Material: 304 stainless steel
Surface processing: Polish finished, Satin finished

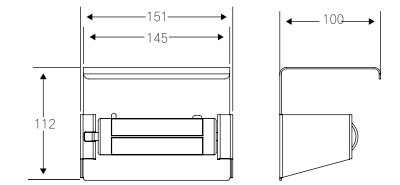

NON-SLIP BATHROOM GRAB BAR

防滑 残弱人扶手 系列

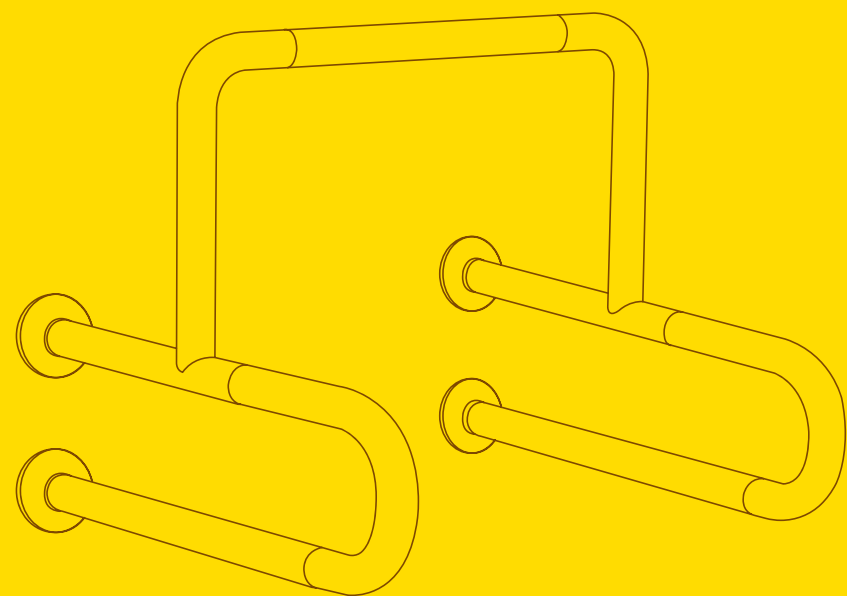

NH-90115F

防滑残弱人扶手
HANDRAIL FOR THE DISABLED

主要材料: 不锈钢 304、树脂
表面处理: 镜光, 砂光
Main Material: 304 stainless steel
Surface processing: Polish finished, Satin finished

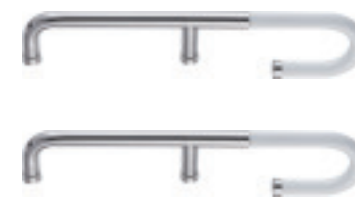
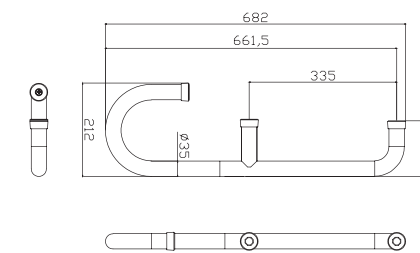

BNH-90110F

防滑残弱人扶手
HANDRAIL FOR THE DISABLED

主要材料: 不锈钢 304、树脂
表面处理: 镜光, 砂光
Main Material: 304 stainless steel
Surface processing: Polish finished, Satin finished

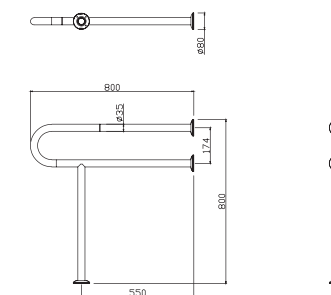

BNH-90113F

防滑残弱人扶手
HANDRAIL FOR THE DISABLED

主要材料: 不锈钢 304、树脂
表面处理: 镜光, 砂光
Main Material: 304 stainless steel
Surface processing: Polish finished, Satin finished

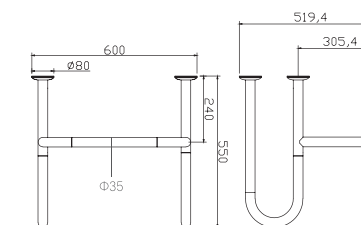

BNH-90120F

防滑残弱人扶手 (左右)
HANDRAIL FOR THE DISABLED

主要材料: 不锈钢 304、树脂
表面处理: 镜光, 砂光
Main Material: 304 stainless steel
Surface processing: Polish finished, Satin finished

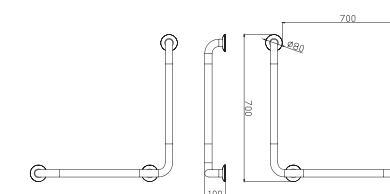

BNH-901406F/457 F / 6 10F

防滑浴室扶手
HANDRAIL FOR THE DISABLED

主要材料: 不锈钢 304、树脂
表面处理: 镜光, 砂光
Main Material: 304 stainless steel
Surface processing: Polish finished, Satin finished

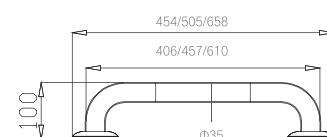

BNH-90135F

防滑残弱人扶手
SWING-UP HANDRAIL FOR THE DISABLED

主要材料: 不锈钢 304、树脂
表面处理: 镜光, 砂光
Main Material: 304 stainless steel
Surface processing: Polish finished, Satin finished

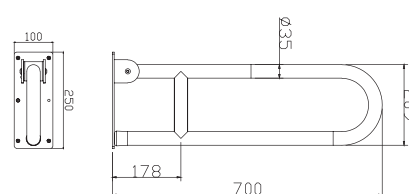

STAINLESS STEEL HANDRAIL FOR THE DISABLED

不锈钢残弱人扶手 系列

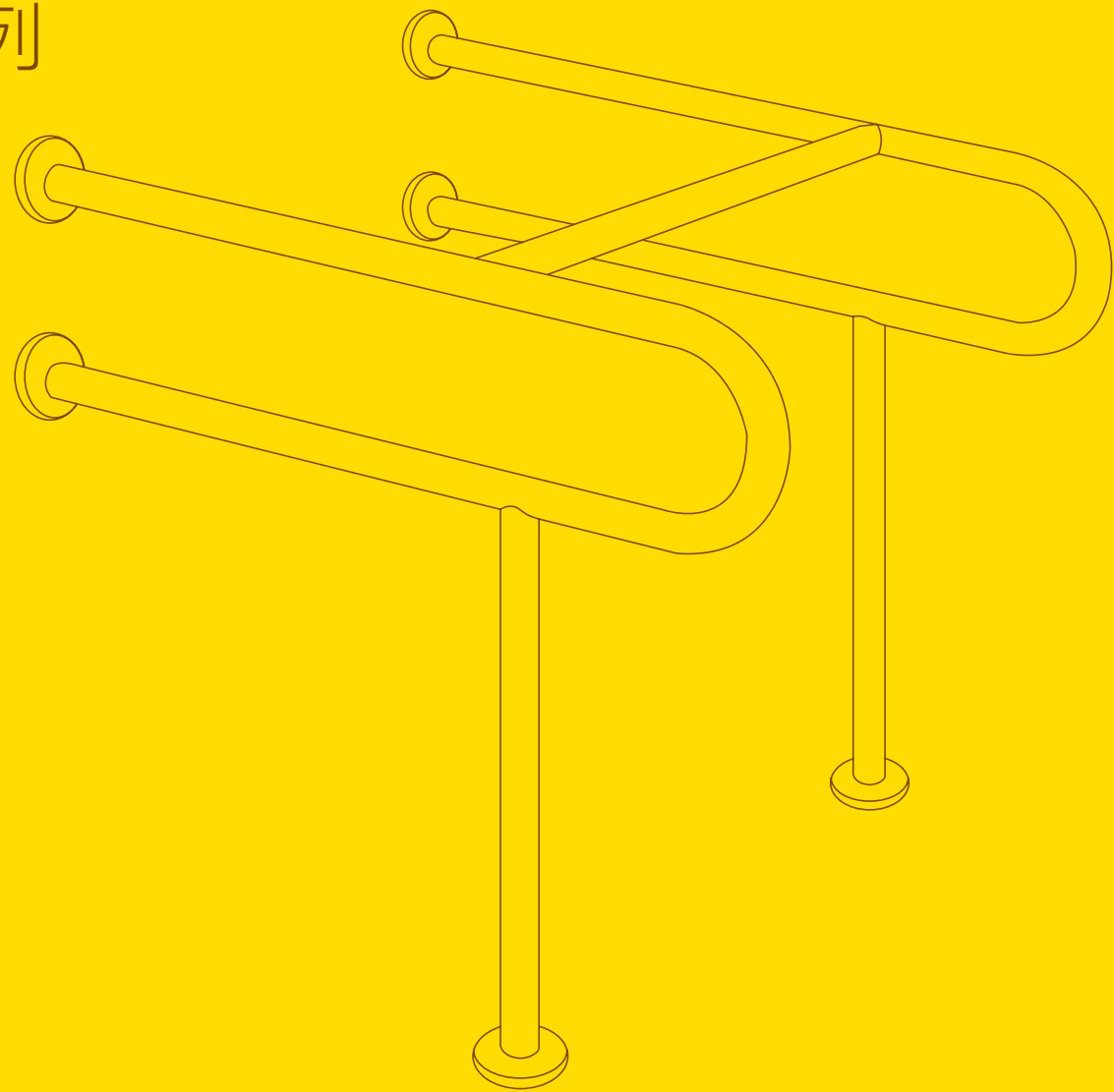

BNH-9032



残弱人扶手
SWING-UP HANDRAIL FOR THE DISABLED

主要材料: 不锈钢 304
表面处理: 镜光, 砂光
Main Material: 304 stainless steel
Surface processing: Polish finished, Satin finished

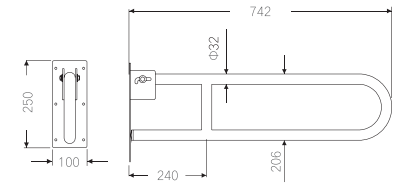

BNH-9033

残弱人扶手
SWING-UP HANDRAIL FOR THE DISABLED

主要材料: 不锈钢 304
表面处理: 镜光, 砂光
Main Material: 304 stainless steel
Surface processing: Polish finished, Satin finished

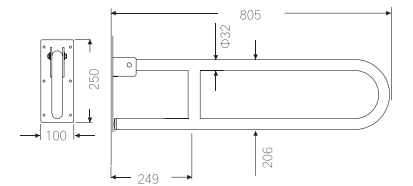

BNH-9035

残弱人扶手
SWING-UP HANDRAIL FOR THE DISABLED

主要材料: 不锈钢 304
表面处理: 镜光, 砂光
Main Material: 304 stainless steel
Surface processing: Polish finished, Satin finished

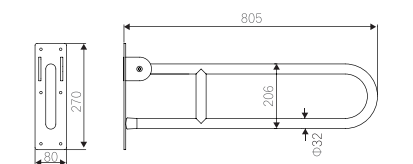

BNH-9035A

残弱人扶手 (带卷纸架)
SWING-UP HANDRAIL FOR THE DISABLED
(WITH PAPER HOLDER)

主要材料: 不锈钢 304
表面处理: 镜光, 砂光
Main Material: 304 stainless steel
Surface processing: Polish finished, Satin finished

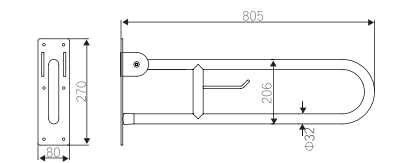



BNH-19010

带盖残弱人扶手
HANDRAIL FOR THE DISABLED

主要材料: 不锈钢 304
表面处理: 镜光, 砂光
Main Material: 304 stainless steel
Surface processing: Polish finished, Satin finished

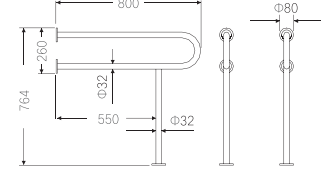

BNH-19021

带盖残弱人扶手
HANDRAIL FOR THE DISABLED

主要材料: 不锈钢 304
表面处理: 镜光, 砂光
Main Material: 304 stainless steel
Surface processing: Polish finished, Satin finished

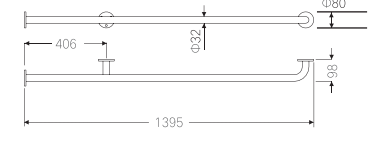

BNH-19011

带盖残弱人扶手
HANDRAIL FOR THE DISABLED

主要材料: 不锈钢 304
表面处理: 镜光, 砂光
Main Material: 304 stainless steel
Surface processing: Polish finished, Satin finished

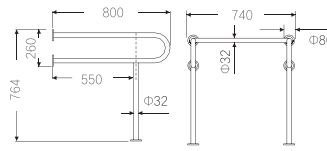

BNH-19022

带盖残弱人扶手
HANDRAIL FOR THE DISABLED

主要材料: 不锈钢 304
表面处理: 镜光, 砂光
Main Material: 304 stainless steel
Surface processing: Polish finished, Satin finished

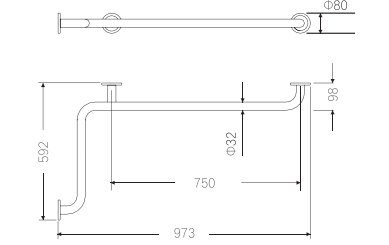

BNH-19013

带盖残弱人扶手
HANDRAIL FOR THE DISABLED

主要材料: 不锈钢 304
表面处理: 镜光, 砂光
Main Material: 304 stainless steel
Surface processing: Polish finished, Satin finished

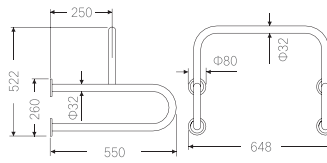

BNH-19023

带盖残弱人扶手
HANDRAIL FOR THE DISABLED

主要材料: 不锈钢 304
表面处理: 镜光, 砂光
Main Material: 304 stainless steel
Surface processing: Polish finished, Satin finished

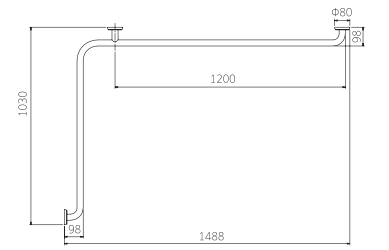

BNH-19020

带盖残弱人扶手
HANDRAIL FOR THE DISABLED

主要材料: 不锈钢 304
表面处理: 镜光, 砂光
Main Material: 304 stainless steel
Surface processing: Polish finished, Satin finished

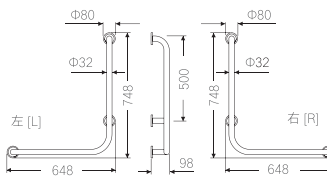

BNH-19026

带盖残弱人扶手
HANDRAIL FOR THE DISABLED

主要材料: 不锈钢 304
表面处理: 镜光, 砂光
Main Material: 304 stainless steel
Surface processing: Polish finished, Satin finished

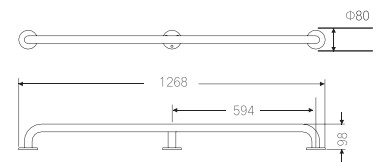



BNH-19040

带盖残疾人扶手
HANDRAIL FOR THE DISABLED

主要材料: 不锈钢 304
表面处理: 镜光, 砂光
Main Material: 304 stainless steel
Surface processing: Polish finished, Satin finished

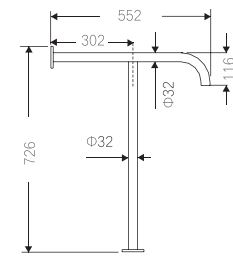

BNH-A80TΦ32

多功能安全扶手 (带升降器)
HANDRAIL FOR THE DISABLED

主要材料: 不锈钢 304/ABS
表面处理: 镜光, 砂光
Main Material: 304 stainless steel/ABS
Surface processing: Polish finished, Satin finished

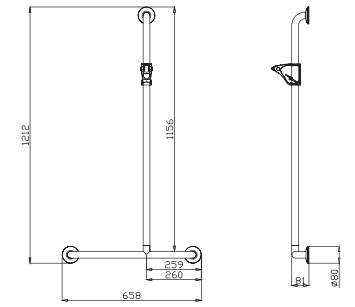

BNH-19041

带盖残疾人扶手
HANDRAIL FOR THE DISABLED

主要材料: 不锈钢 304
表面处理: 镜光, 砂光
Main Material: 304 stainless steel
Surface processing: Polish finished, Satin finished

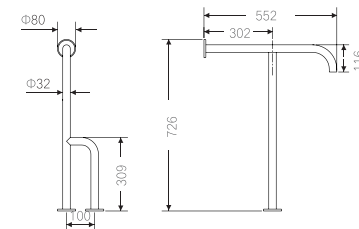

BNH-19042

带盖残疾人扶手
HANDRAIL FOR THE DISABLED

主要材料: 不锈钢 304
表面处理: 镜光, 砂光
Main Material: 304 stainless steel
Surface processing: Polish finished, Satin finished

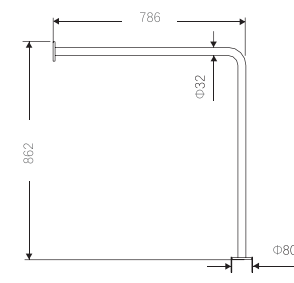

BNH-19046

带盖残疾人扶手
HANDRAIL FOR THE DISABLED

主要材料: 不锈钢 304
表面处理: 镜光, 砂光
Main Material: 304 stainless steel
Surface processing: Polish finished, Satin finished

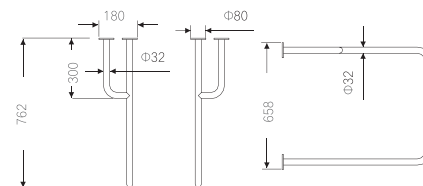

NYLON NON-SLIP BATHROOM GRAB BAR

抗菌防滑
无障碍安全扶手
系列

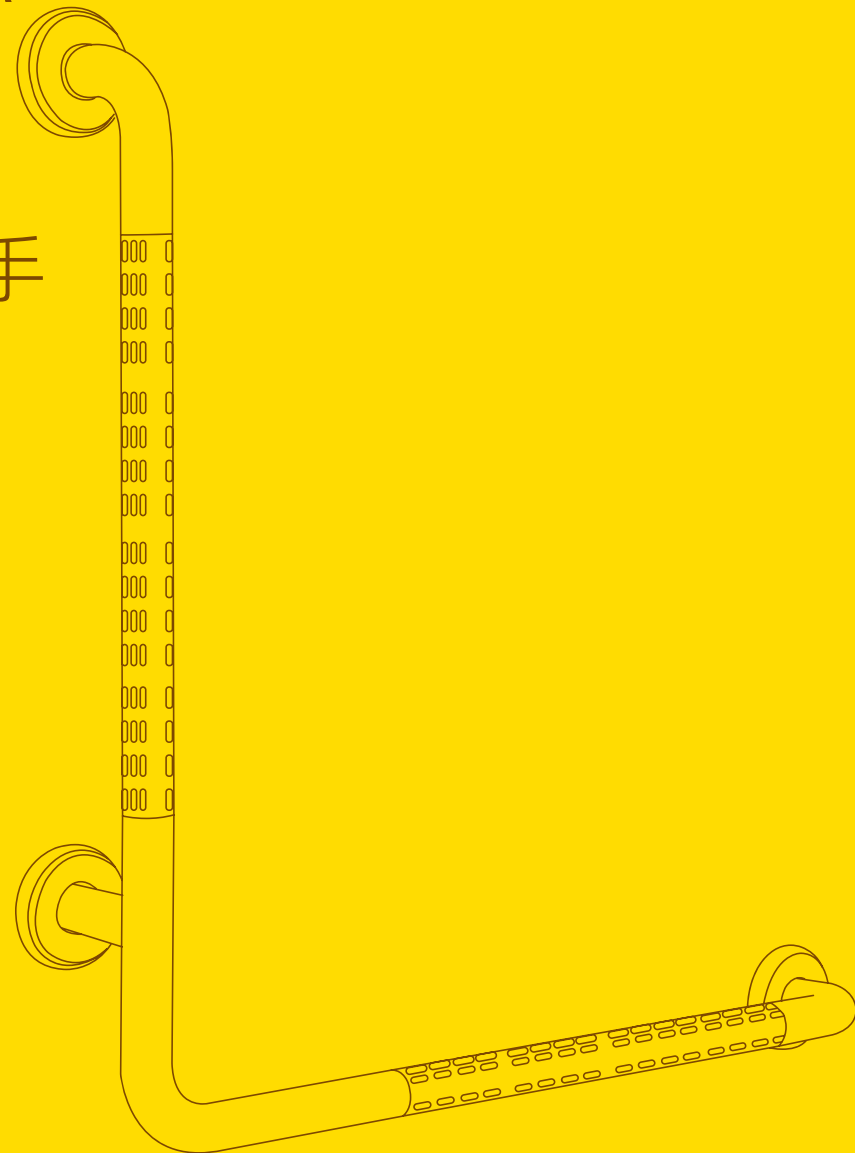

BNH-901500/901400/901300

尼龙残弱人扶手
NYLON NON-SLIP BATHROOM GRAB BAR

主要材料: 不锈钢 304, 尼龙
表面处理: 镜光, 砂光
Main Material: 304 stainless steel, Nylon
Surface processing: Polish finished, Satin finished

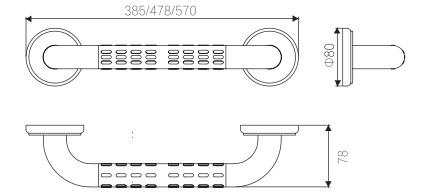

BNH-90150B

尼龙残弱人扶手 (曲型)
NYLON NON-SLIP HANDRAIL FOR THE DISABLED (BENDED)

主要材料: 不锈钢 304, 尼龙
表面处理: 镜光, 砂光
Main Material: 304 stainless steel, Nylon
Surface processing: Polish finished, Satin finished

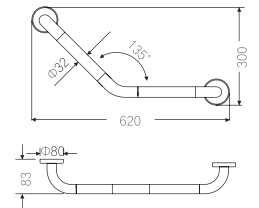

BNH-90132

尼龙残弱人扶手
NYLON NON-SLIP HANDRAIL FOR THE DISABLED

主要材料: 不锈钢 304, 尼龙
表面处理: 镜光, 砂光
Main Material: 304 stainless steel, Nylon
Surface processing: Polish finished, Satin finished

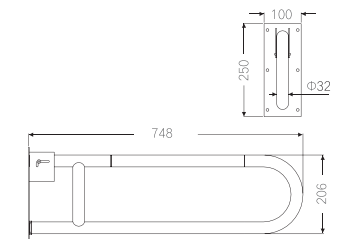

右 (R)

BNH-90120(L,R)

尼龙残弱人扶手 (左 / 右)
NYLON NON-SLIP HANDRAIL FOR THE DISABLED (LEFT/RIGHT)

主要材料: 不锈钢 304, 尼龙
表面处理: 镜光, 砂光
Main Material: 304 stainless steel, Nylon
Surface processing: Polish finished, Satin finished

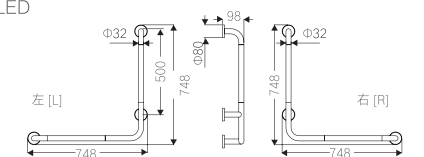

STAINLESS STEEL BATHROOM GRAB BAR

不锈钢浴室 安全扶手系列



ANH-501 Φ 25

浴室扶手
BATHROOM GRAB BAR

主要材料: 不锈钢 304
表面处理: 镜光, 砂光
Main Material: 304 stainless steel
Surface processing: Polish finished, Satin finished

A	305	356	406	457	510	762	813	914
B	335	386	436	487	640	792	843	944

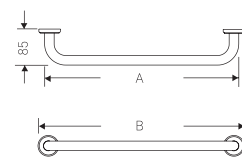

ANH-501 Φ 32

浴室扶手 (简装)
BATHROOM GRAB BAR

主要材料: 不锈钢 304
表面处理: 镜光, 砂光
Main Material: 304 stainless steel
Surface processing: Polish finished, Satin finished

A	406	457	610	762	813	914	1067	1219	1320
B	454	505	658	810	861	962	1115	1267	1368

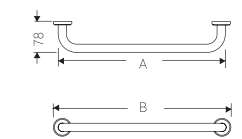

ANH-501C Φ 32

冲花浴室扶手
KNURLED NON-SLIP BATHROOM GRAB BAR

主要材料: 不锈钢 304
表面处理: 镜光, 砂光
Main Material: 304 stainless steel
Surface processing: Polish finished, Satin finished

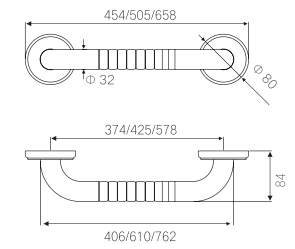

ANH-501Y Φ 32

压花浴室扶手
KNURLED NON-SLIP BATHROOM GRAB BAR

主要材料: 不锈钢 304
表面处理: 镜光, 砂光
Main Material: 304 stainless steel
Surface processing: Polish finished, Satin finished

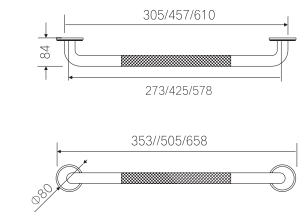

ANH-501B Φ 25

浴室扶手 (曲型)
BATHROOM GRAB BAR (BENDED)

主要材料: 不锈钢 304
表面处理: 镜光, 砂光
Main Material: 304 stainless steel
Surface processing: Polish finished, Satin finished

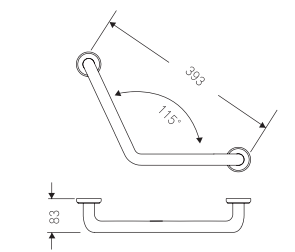

ANH-501E Φ 25

浴室扶手 (曲碟)
BATHROOM GRAB BAR (BENDED / WITH DISH)

主要材料: 不锈钢 304
表面处理: 镜光, 砂光
Main Material: 304 stainless steel
Surface processing: Polish finished, Satin finished

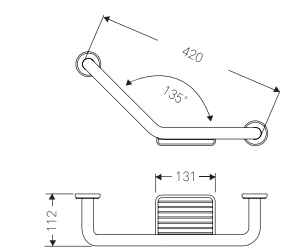

ANTIBACTERIAL ANTISKID GRAB BAR

全尼龙
安全扶手系列

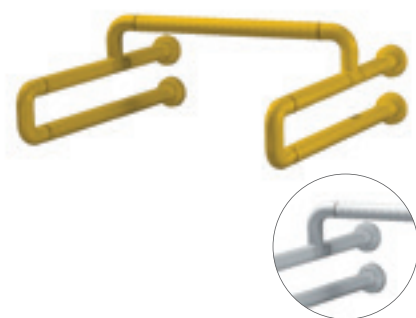
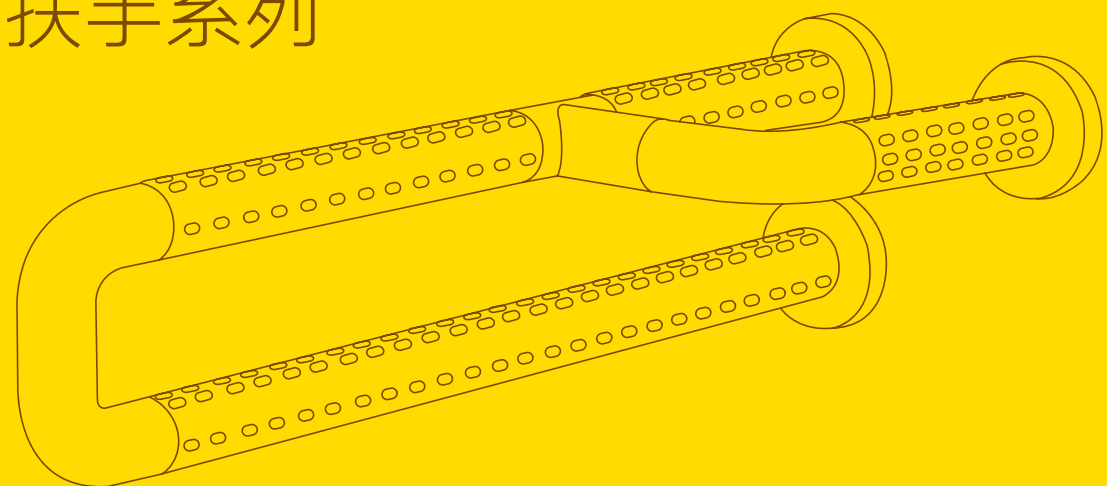

BNH-N19013

抗菌防滑安全扶手
ANTIBACTERIAL ANTISKID GRAB BAR

主要材料: 尼龙,ABS
颜色: 黄色,白色
Main Material: Nylon,ABS
Color: Yellow,White

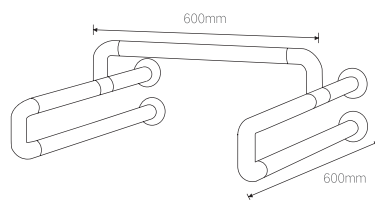

BNH-N19030R(右)

抗菌防滑安全扶手
ANTIBACTERIAL ANTISKID GRAB BAR

主要材料: 尼龙,ABS
颜色: 黄色,白色
Main Material: Nylon,ABS
Color: Yellow,White

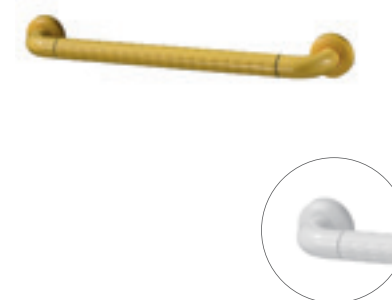
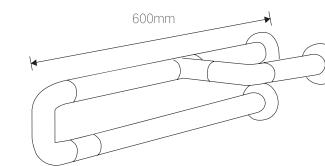

BNH-N601

抗菌防滑安全扶手
ANTIBACTERIAL ANTISKID GRAB BAR

主要材料: 尼龙,ABS
颜色: 黄色,白色
Main Material: Nylon,ABS
Color: Yellow,White

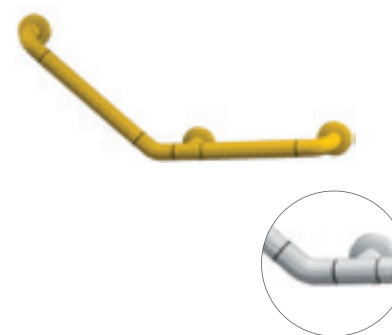
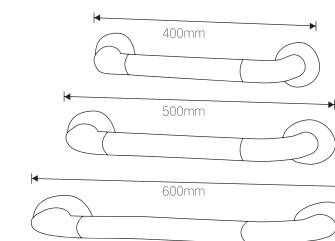

BNH-N601B

抗菌防滑安全扶手
ANTIBACTERIAL ANTISKID GRAB BAR

主要材料: 尼龙,ABS
颜色: 黄色,白色
Main Material: Nylon,ABS
Color: Yellow,White

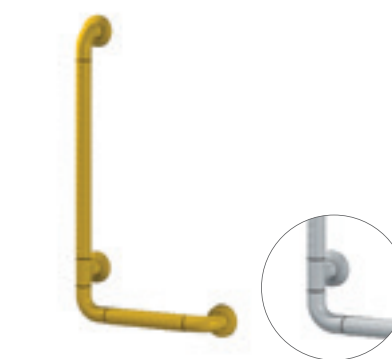
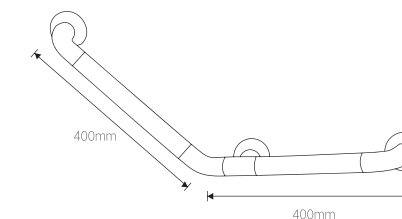

BNH-N19020

抗菌防滑安全扶手
ANTIBACTERIAL ANTISKID GRAB BAR

主要材料: 尼龙,ABS
颜色: 黄色,白色
Main Material: Nylon,ABS
Color: Yellow,White

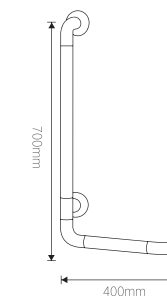



BNH-N9035

抗菌防滑安全扶手
ANTIBACTERIAL ANTISKID GRAB BAR

主要材料: 尼龙,ABS
颜色: 黄色,白色
Main Material: Nylon,ABS
Color: Yellow,White

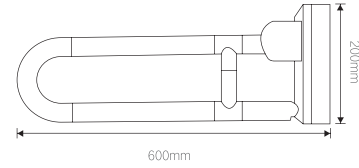

BNH-N19031

抗菌防滑安全扶手
ANTIBACTERIAL ANTISKID GRAB BAR

主要材料: 尼龙,ABS
颜色: 黄色,白色
Main Material: Nylon,ABS
Color: Yellow,White

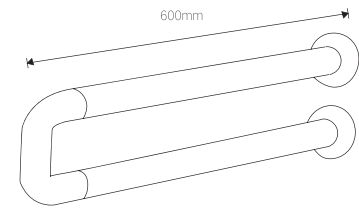

BNH-N190121R(右)

抗菌防滑安全扶手
ANTIBACTERIAL ANTISKID GRAB BAR

主要材料: 尼龙,ABS
颜色: 黄色,白色
Main Material: Nylon,ABS
Color: Yellow,White

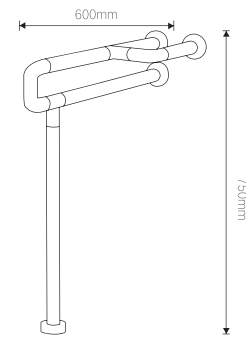

BNH-N19041R(右)

抗菌防滑安全扶手
ANTIBACTERIAL ANTISKID GRAB BAR

主要材料: 尼龙,ABS
颜色: 黄色,白色
Main Material: Nylon,ABS
Color: Yellow,White

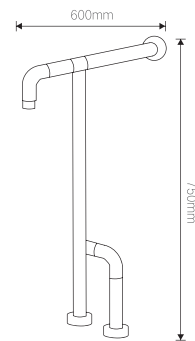

BNH-N19026

抗菌防滑安全扶手
ANTIBACTERIAL ANTISKID GRAB BAR

主要材料: 尼龙,ABS
颜色: 黄色,白色
Main Material: Nylon,ABS
Color: Yellow,White



BNH-N19026A

抗菌防滑安全扶手
ANTIBACTERIAL ANTISKID GRAB BAR

主要材料: 尼龙,ABS
颜色: 黄色,白色
Main Material: Nylon,ABS
Color: Yellow,White



BNH-N19011

抗菌防滑安全扶手
ANTIBACTERIAL ANTISKID GRAB BAR

主要材料: 尼龙,ABS
颜色: 黄色,白色
Main Material: Nylon,ABS
Color: Yellow,White

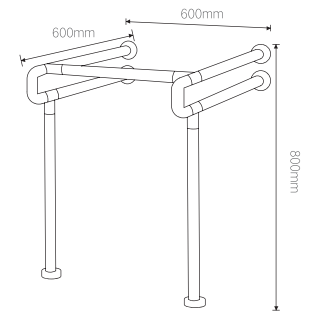

BNH-N19014

抗菌防滑安全扶手
ANTIBACTERIAL ANTISKID GRAB BAR

主要材料: 尼龙,ABS
颜色: 黄色,白色
Main Material: Nylon,ABS
Color: Yellow,White

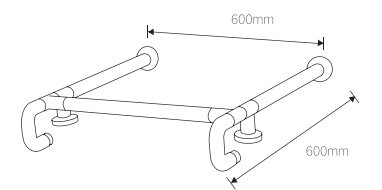

SHOWER SEAT

浴室凳系列

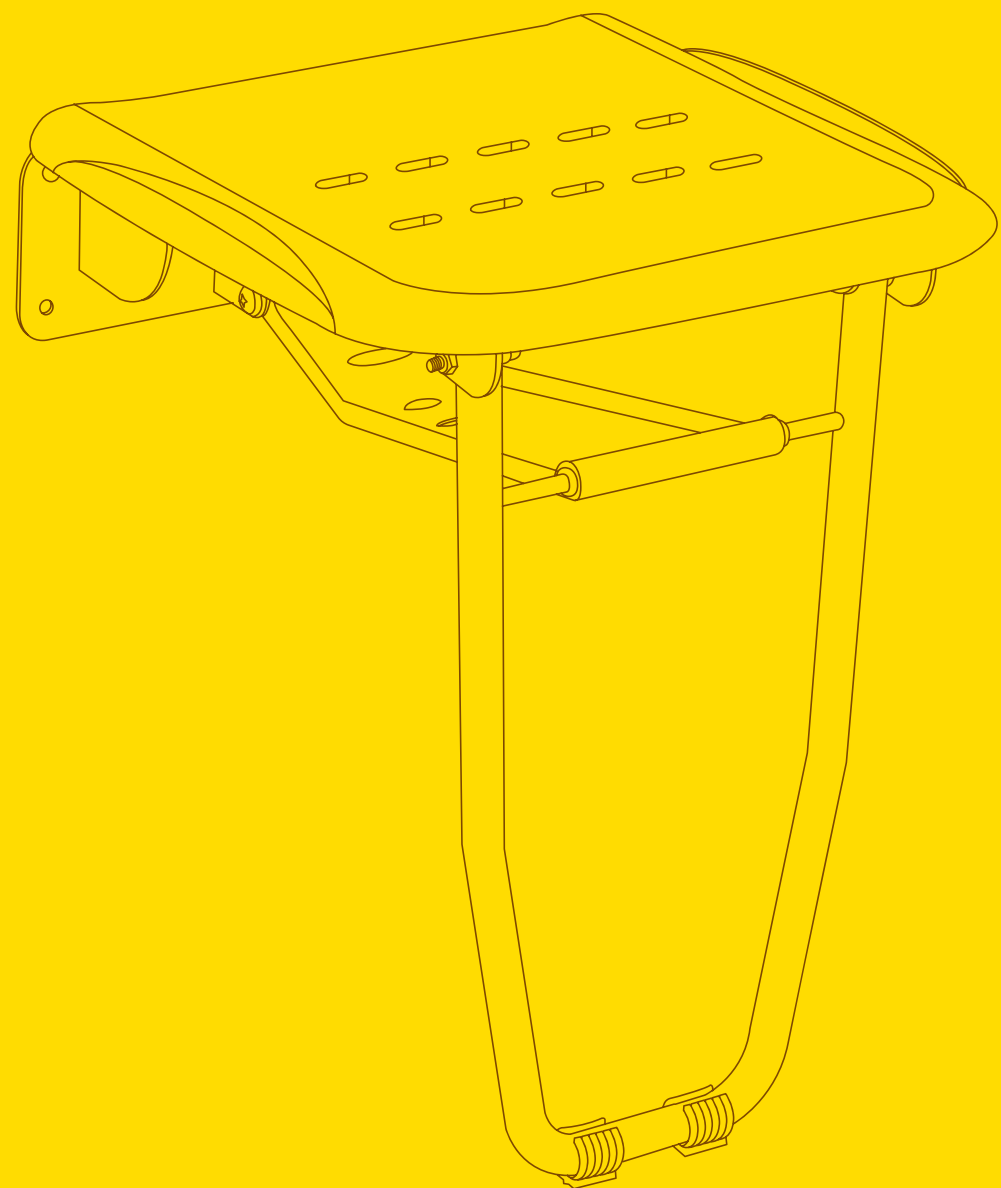

102

SHOWER SEAT



ANH-N90512

带脚浴室凳
SHOWER SEAT

主要材料: 不锈钢, 抗菌 HDPE
表面处理: 光面
Main material: Stainless steel, HDPE
Surface processing: Polish finished

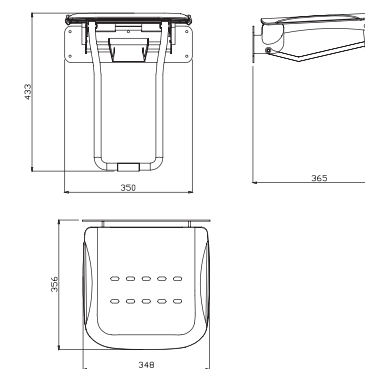

ANH-M90510

浴室凳
SHOWER SEAT

主要材料: 不锈钢, 防腐木
表面处理: 光面
Main material: Stainless steel, Antiseptic wood
Surface processing: Polish finished

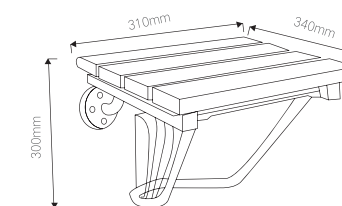

ANH-M90520

浴室凳
SHOWER SEAT

主要材料: 不锈钢, 防腐木
表面处理: 光面
Main material: Stainless steel, Antiseptic wood
Surface processing: Polish finished

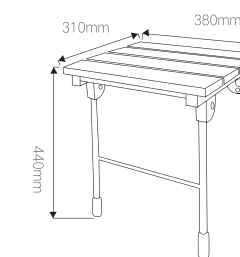

ANH-N90511

浴室凳
SHOWER SEAT

主要材料: 不锈钢, 抗菌 HDPE
表面处理: 光面
Main material: Stainless steel, HDPE
Surface processing: Polish finished

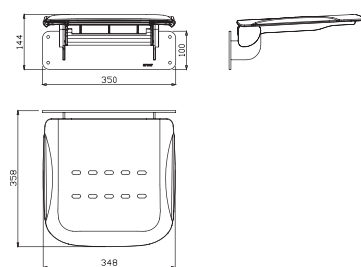

ANH-N90510

浴室凳
SHOWER SEAT

主要材料: 不锈钢, 尼龙
表面处理: 光面
Main material: Stainless steel, Nylon
Surface processing: Polish finished

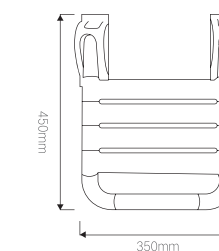

HARDWARE FOR TOILET

卫生间配套五金 系列

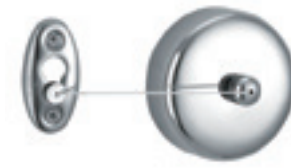
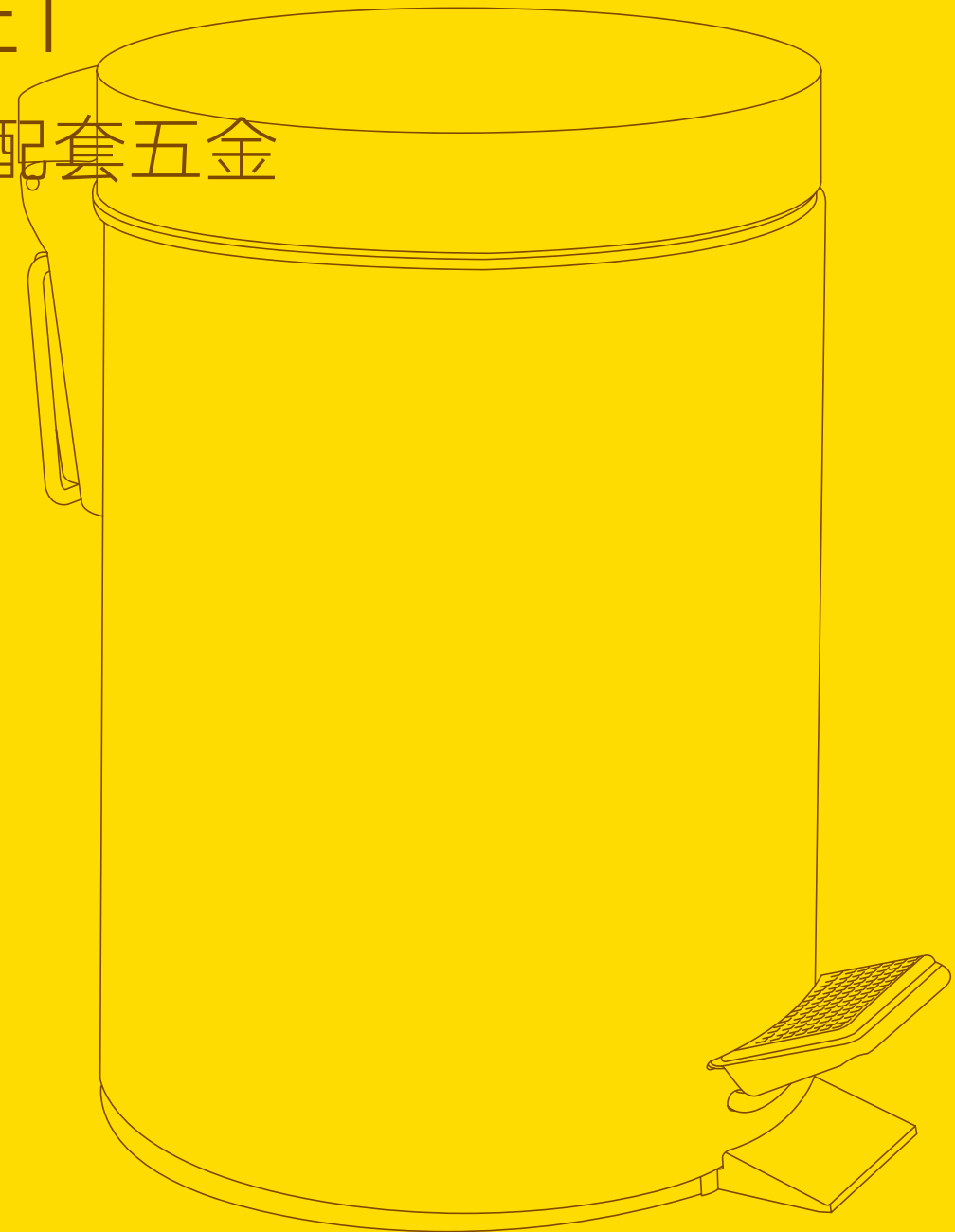

CL-4188A

晾衣器

RETRACTABLE CLOTHESLINE

主要材料: 不锈钢 304

表面处理: 镜光, 砂光

Main Material: 304 stainless steel

Surface processing: Polish finished, Satin finished

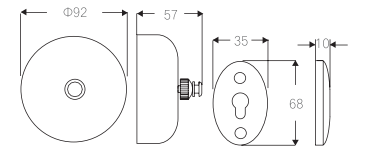

AC01-801A

方晾衣器

SQUARE RETRACTABLE CLOTHESLINE

主要材料: 不锈钢 304

表面处理: 镜光, 砂光

Main Material: 304 stainless steel

Surface processing: Polish finished, Satin finished

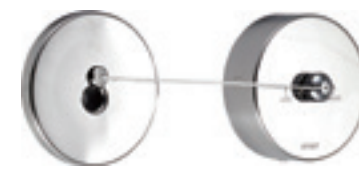
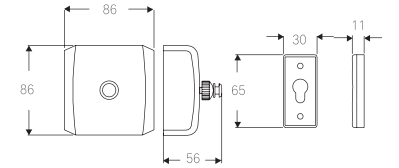

AC01-4288A

晾衣器

RETRACTABLE CLOTHESLINE

主要材料: 不锈钢 304

表面处理: 镜光, 砂光

Main Material: 304 stainless steel

Surface processing: Polish finished, Satin finished

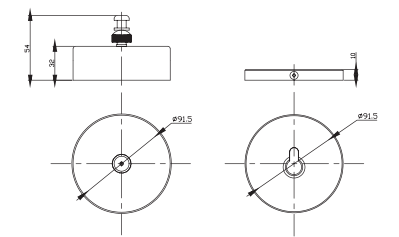

2303

烟缸

ASHTRAY

主要材料: 不锈钢 304

表面处理: 镜光, 砂光

Main Material: 304 stainless steel

Surface processing: Polish finished, Satin finished

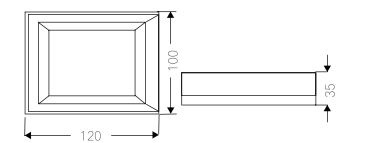

2304



香皂架
SOAP DISH

主要材料: 不锈钢 304
表面处理: 镜光, 砂光
Main Material: 304 stainless steel
Surface processing: Polish finished, Satin finished

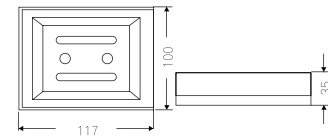

AXT-7831



三衣钩
TRIPLE ROBE HOOKS (3)

主要材料: 铝合金, 锌合金
表面处理: 镀铬, 拉丝电化
Main Material: Aluminum alloy, Zinc alloy
Surface processing: Chrome Plating, Satin Electrization

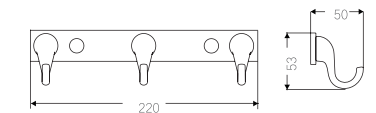

XT-8700



马桶刷筒
BRUSH HOLDER

主要材料: 不锈钢 304
表面处理: 镜光, 砂光
Main Material: 304 stainless steel
Surface processing: Polish finished, Satin finished

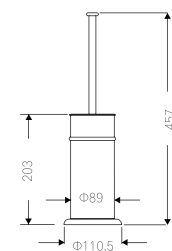

AXT-7851



五衣钩
QUINTUPLE ROBE HOOKS (5)

主要材料: 铝合金, 锌合金
表面处理: 镀铬, 拉丝电化
Main Material: Aluminum alloy, Zinc alloy
Surface processing: Chrome Plating, Satin Electrization

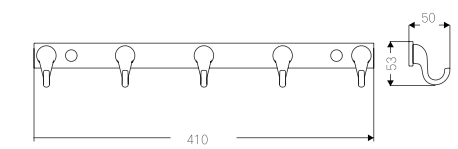

XT-7373



三衣钩
TRIPLE ROBE HOOKS (3)

主要材料: 不锈钢 304, 锌合金
表面处理: 镜光
Main Material: 304 stainless steel, Zinc alloy
Surface processing: Polish finished

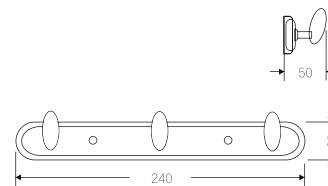

AXT-7931



三衣钩
TRIPLE ROBE HOOKS (3)

主要材料: 铝合金, 锌合金
表面处理: 镀铬, 拉丝电化
Main Material: Aluminum alloy, Zinc alloy
Surface processing: Chrome Plating, Satin Electrization

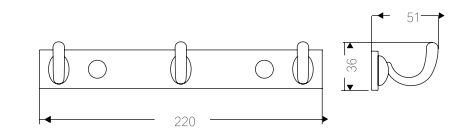

XT-7375



五衣钩
QUINTUPLE ROBE HOOKS (5)

主要材料: 不锈钢 304, 锌合金
表面处理: 镜光
Main Material: 304 stainless steel, Zinc alloy
Surface processing: Polish finished

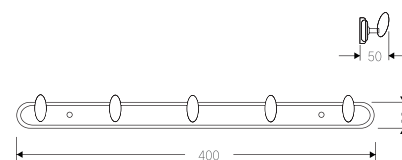

AXT-7951



五衣钩
QUINTUPLE ROBE HOOKS (5)

主要材料: 铝合金, 锌合金
表面处理: 镀铬, 拉丝电化
Main Material: Aluminum alloy, Zinc alloy
Surface processing: Chrome Plating, Satin Electrization

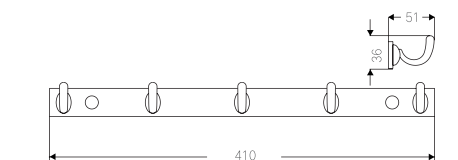

AXT-71311



单衣钩
SINGLE ROBE HOOK

主要材料: 不锈钢 304
表面处理: 砂光
Main Material: 304 stainless steel
Surface processing: Satin finished

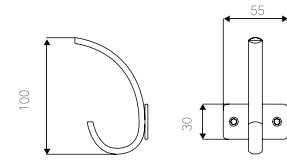

AXT-71331



三衣钩
TRIPLE ROBE HOOKS (3)

主要材料: 不锈钢 304
表面处理: 砂光
Main Material: 304 stainless steel
Surface processing: Satin finished

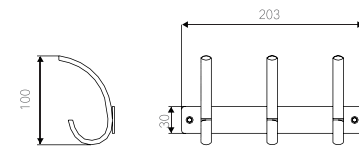

AXT-71351



五衣钩
QUINTUPLE ROBE HOOKS (5)

主要材料: 不锈钢 304
表面处理: 砂光
Main Material: 304 stainless steel
Surface processing: Satin finished

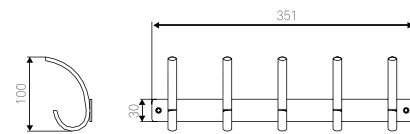

AXT-71511



单衣钩
SINGLE ROBE HOOK

主要材料: 不锈钢 304
表面处理: 砂光
Main Material: 304 stainless steel
Surface processing: Satin finished

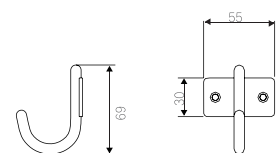

AXT-71531



三衣钩
TRIPLE ROBE HOOKS (3)

主要材料: 不锈钢 304
表面处理: 砂光
Main Material: 304 stainless steel
Surface processing: Satin finished

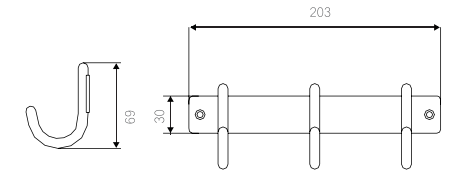

AXT-71551



五衣钩
QUINTUPLE ROBE HOOKS (5)

主要材料: 不锈钢 304
表面处理: 砂光
Main Material: 304 stainless steel
Surface processing: Satin finished

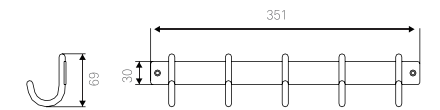

GT-5740



四衣钩
QUINTUPLE ROBE HOOKS (4)

主要材料: 不锈钢 304, 锌合金
表面处理: 镜光
Main Material: 304 stainless steel, Zinc alloy
Surface processing: Polish finished

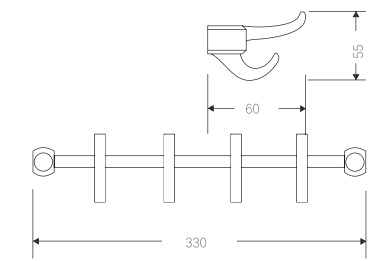

GT-5760



六衣钩
SEXTUPLE ROBE HOOKS (6)

主要材料: 不锈钢 304, 锌合金
表面处理: 镜光
Main Material: 304 stainless steel, Zinc alloy
Surface processing: Polish finished

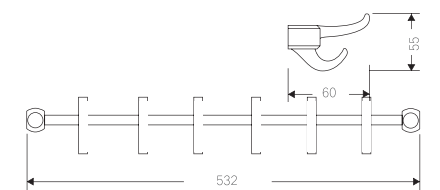

GT-5780



八衣钩
OCTUPLE ROBE HOOKS (8)

主要材料: 不锈钢 304, 锌合金
表面处理: 镜光
Main Material: 304 stainless steel,Zinc alloy
Surface processing: Polish finished

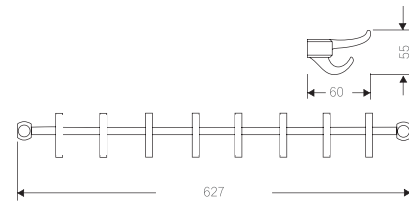

XT-707

弃物袋钩
SANITARY BAG HOOK

主要材料: 铜
表面处理: 镀铬
Main Material: Brass
Surface processing: Chrome Plating

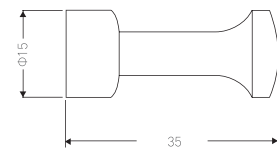

XT-708

衣帽钩
CLOTHES & CAPS HOOK

主要材料: 铜
表面处理: 镀铬
Main Material: Brass
Surface processing: Chrome Plating

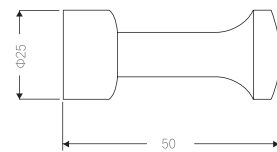

XT02-8303(H)



垃圾桶 [缓冲式]
GARBAGE [SOFT-CLOSE COVER BIN]

主要材料: 不锈钢 304
表面处理: 砂光
Main Material: 304 stainless steel
Surface processing: Satin finished

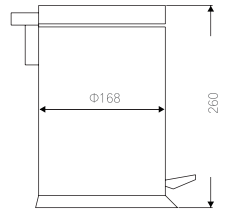

XT02-8305(H)

垃圾桶 [缓冲式]
GARBAGE [SOFT-CLOSE COVER BIN]

主要材料: 不锈钢 304
表面处理: 砂光
Main Material: 304 stainless steel
Surface processing: Satin finished

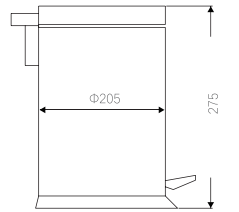

XT02-8103/8106/8112

垃圾桶
GARBAGE BIN

主要材料: 不锈钢
表面处理: 镜光
Main Material: stainless steel
Surface processing: Polish finished

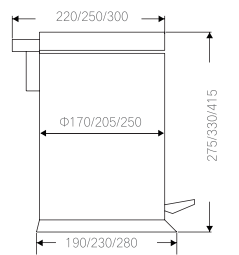

XT02-8203/8206/8212

垃圾桶
GARBAGE BIN

主要材料: 不锈钢 304
表面处理: 砂光
Main Material: 304 stainless steel
Surface processing: Satin finished

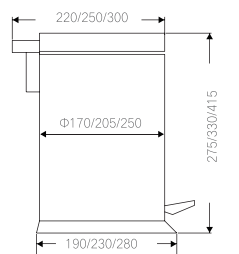



XT02-9106/9206

无盖垃圾桶
GARBAGE BIN

主要材料: 不锈钢 304
表面处理: 镜光, 砂光
Main Material: 304 stainless steel
Surface processing: Polish finished, Satin finished

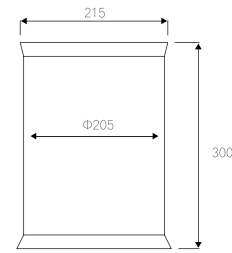

ANT-501 Φ 19 / Φ 25

浴室杆座
SHOWER
CURTAIN ROD

主要材料: 不锈钢 304
表面处理: 镜光, 砂光
Main Material: 304 stainless steel
Surface processing: Polish finished, Satin finished

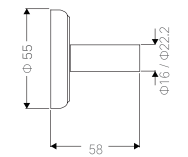

XT02-660

全封门垃圾桶 (入墙式)
RECESSED WASTEBIN

主要材料: 不锈钢 304
表面处理: 砂光
Main Material: 304 stainless steel
Surface processing: Satin finished

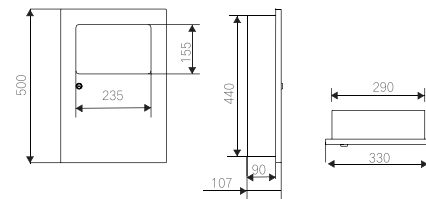

AV-20802

管井锁
LOCK LATCH WITH KEY

主要材料: 不锈钢 304, 锌合金
表面处理: 镜光
Main Material: 304 stainless steel, Zinc alloy
Surface processing: Polish finished

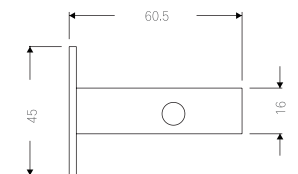

XT02-630

垃圾桶
GARBAGE BIN

主要材料: 不锈钢 304
表面处理: 砂光
Main Material: 304 stainless steel
Surface processing: Satin finished

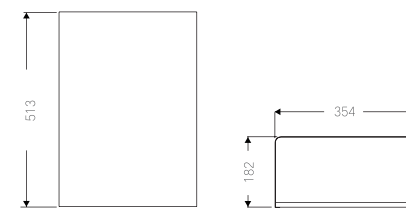

AV-20806/20808/20810

鸡咀铰
HINGE

主要材料: 不锈钢 304
表面处理: 砂光
Main Material: 304 stainless steel
Surface processing: Satin finished

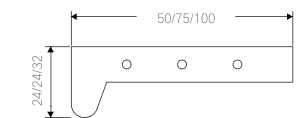

XT02-650

垃圾桶
GARBAGE BIN

主要材料: 不锈钢 304
表面处理: 砂光
Main Material: 304 stainless steel
Surface processing: Satin finished

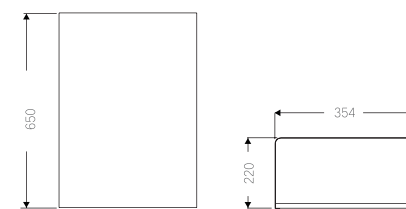

XT02-021

方型垃圾槽
COUNTERTOP WASTEBIN

主要材料: 不锈钢 304
表面处理: 砂光
Main Material: 304 stainless steel
Surface processing: Satin finished

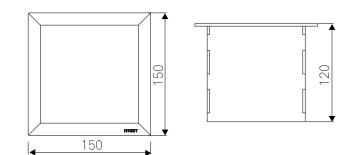



XT02-022A

长型台面垃圾槽 (带盖)
COUNTERTOP WASTEBIN(WITH COVER)

主要材料: 不锈钢 304
表面处理: 砂光
Main Material: 304 stainless steel
Surface processing: Satin finished

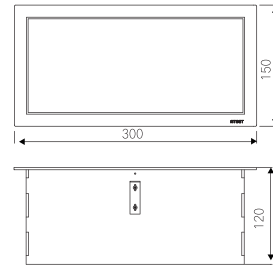

XT02-022

长型台面垃圾槽 (带盖)
COUNTERTOP WASTEBIN(WITH COVER)

主要材料: 不锈钢 304
表面处理: 砂光
Main Material: 304 stainless steel
Surface processing: Satin finished

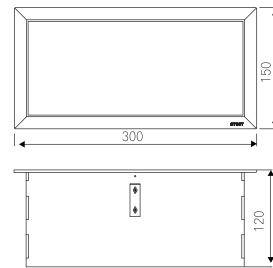

XT02-023

方型台面垃圾槽
COUNTERTOP WASTEBIN

主要材料: 不锈钢 304
表面处理: 砂光
Main Material: 304 stainless steel
Surface processing: Satin finished

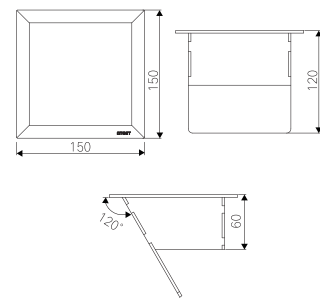

XT02-024

圆型台面垃圾槽
COUNTERTOP WASTEBIN

主要材料: 不锈钢 304
表面处理: 砂光
Main Material: 304 stainless steel
Surface processing: Satin finished

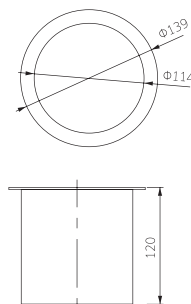

ADQ01-201

干手器
HAND DRYER

主要材料: 塑料
表面颜色: 白色
Main Material: Plastic
Surface color: White

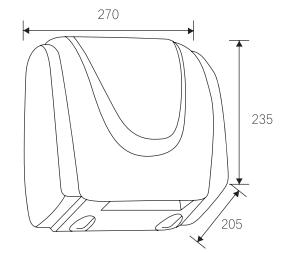

ADQ01-203

干手器
HAND DRYER

主要材料: 塑料
表面颜色: 白色
Main Material: Plastic
Surface color: White

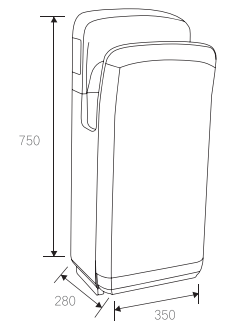

ADQ01-101

电吹风
HAIR DRYER WITH OUTLET

主要材料: 塑料
表面颜色: 白色
Main Material: Plastic
Surface color: White

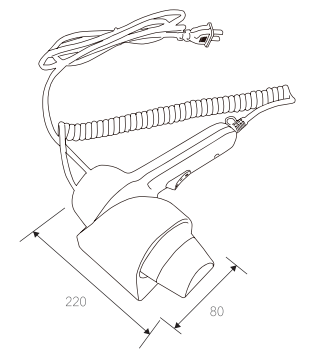

ADQ01-102

电吹风
HAIR DRYER WITH OUTLET

主要材料: 塑料
表面颜色: 白色
Main Material: Plastic
Surface color: White

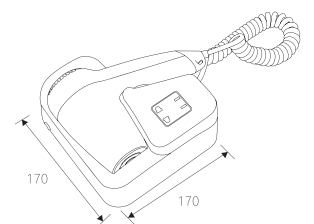

SOAP DISPENSER

皂液器系列

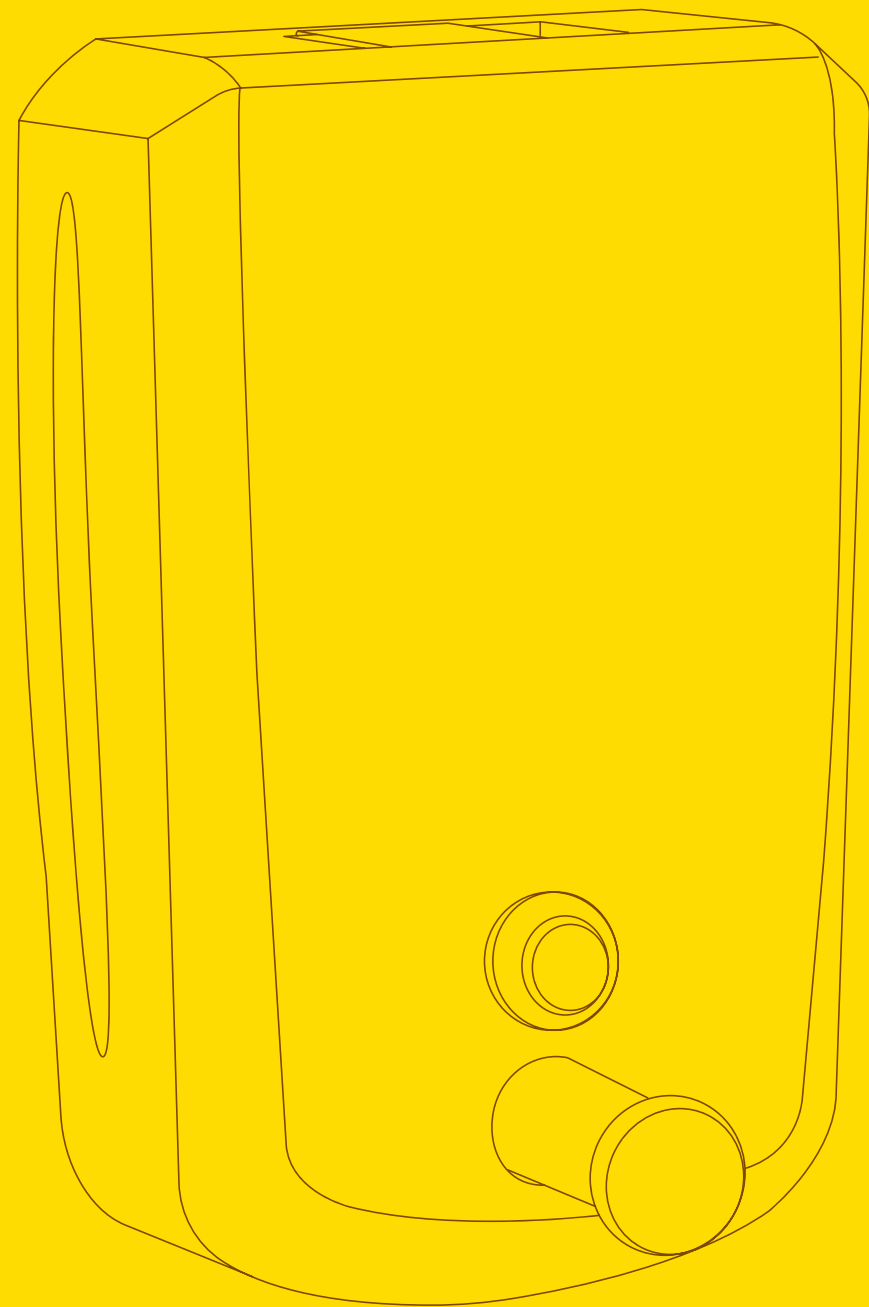

SD-1080(1250ml)

液皂器

SOAP DISPENSER

主要材料: 不锈钢 304

表面处理: 镜光, 砂光

Main Material: 304 stainless steel

Surface processing: Polish finished,Satin finished

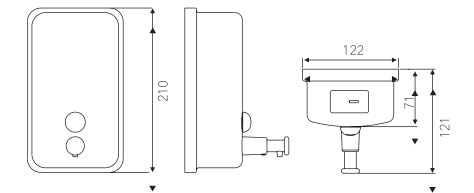

SD-680(800ml)

液皂器

SOAP DISPENSER

主要材料: 不锈钢 304

表面处理: 镜光, 砂光

Main Material: 304 stainless steel

Surface processing: Polish finished,Satin finished

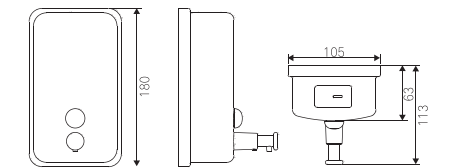

SD-380(500ml)

液皂器

SOAP DISPENSER

主要材料: 不锈钢 304

表面处理: 镜光, 砂光

Main Material: 304 stainless steel

Surface processing: Polish finished,Satin finished

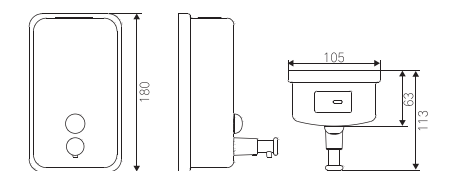

AD01-460(1200ml)

液皂器

SOAP DISPENSER

主要材料: 不锈钢 304

表面处理: 镜光, 砂光

Main Material: 304 stainless steel

Surface processing: Polish finished,Satin finished

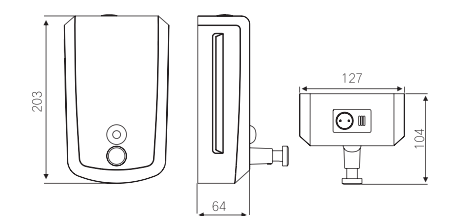



AD01-440(800ml)

液皂器
SOAP DISPENSER

主要材料: 不锈钢 304
表面处理: 镜光, 砂光
Main Material: 304 stainless steel
Surface processing: Polish finished, Satin finished

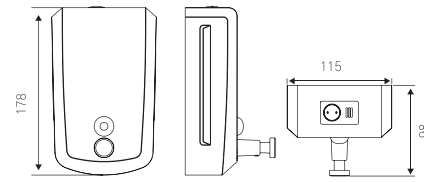

SD-10105DE

皂液器
SOAP DISPENSER

主要材料: 不锈钢 304
表面处理: 砂光
Main Material: 304 stainless steel
Surface processing: Satin finished

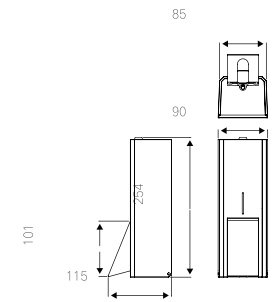

SD-4010

入墙式液皂器
SOAP DISPENSER(RECESSED)

主要材料: 不锈钢 304
表面处理: 镜光, 砂光
Main Material: 304 stainless steel
Surface processing: Polish finished, Satin finished

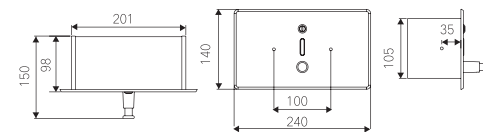

SD-43113 (300ml)

液皂器
SOAP DISPENSER

主要材料: 不锈钢 304, 塑料
表面处理: 镜光, 砂光
Main Material: 304 stainless steel, Plastic
Surface processing: Polish finished, Satin finished

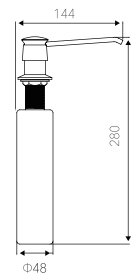

SD-G10110

感应液皂器
SENSOR SOAP DISPENSER

主要材料: 不锈钢 304
表面处理: 镜光, 砂光
Main Material: 304 stainless steel
Surface processing: Polish finished, Satin finished

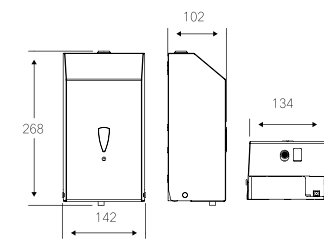

SD-43115 (500ml)

液皂器
SOAP DISPENSER

主要材料: 不锈钢 304, 塑料
表面处理: 镜光, 砂光
Main Material: 304 stainless steel, Plastic
Surface processing: Polish finished, Satin finished

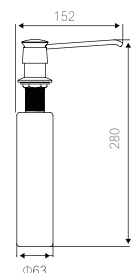

SD-1090

液皂器
SOAP DISPENSER

主要材料: 不锈钢 304
表面处理: 镜光, 砂光
Main Material: 304 stainless steel
Surface processing: Polish finished, Satin finished

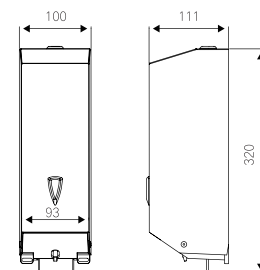

套装挂件系列产品

Bathroom Accessories Set

AX37(P) 系列	121
AX37(ACU) 系列	123
AX37(ORB) 系列	125
AX35(P) 系列	127
AX35(PVD) 系列	130
AX30 系列	133
AX29 系列	135
AX28 系列	137
AX22 系列	139
AX18 系列	141
AX13 系列	143
AC51A 系列	145
AC61 系列	148

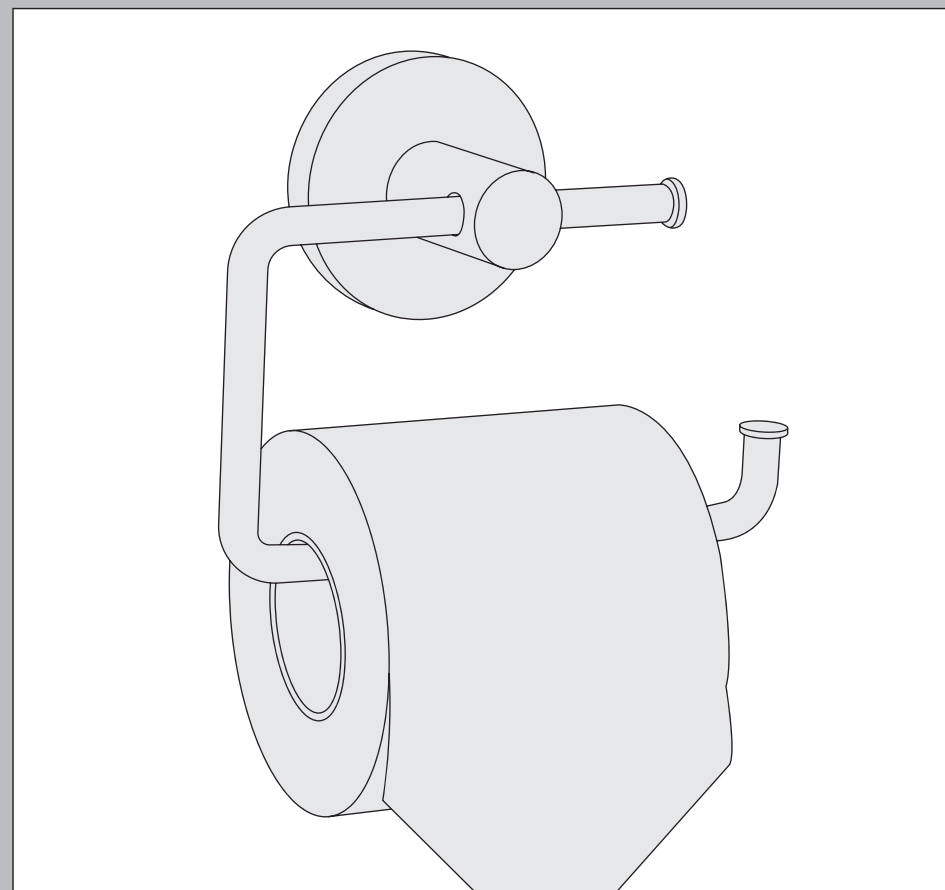

套装挂件系列产品

Bathroom Accessories Set

BATHROOM ACCESSORIES SET

套装挂件 —
AX37(P) 系列



122

BATHROOM ACCESSORIES SET
AX37(P) SERIES

AX37-801(P)

马桶刷座
BRUSH HOLDER

主要材料: 不锈钢 304, 陶瓷
表面处理: 镜光
Main Material: 304 stainless steel, Ceramic
Surface processing: Polish finished

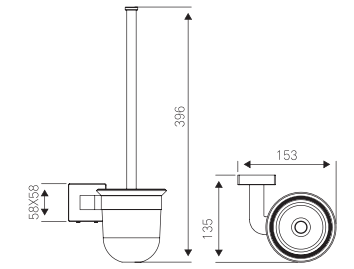

AX37-200(P)



毛巾环
TOWEL RING

主要材料: 不锈钢 304
表面处理: 镜光
Main Material: 304 stainless steel
Surface processing: Polish finished

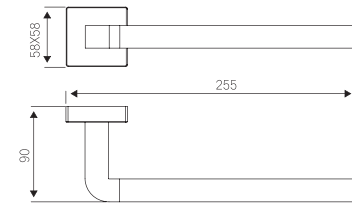

AX37-261(P)



毛巾单杆
SINGLE TOWEL BAR

主要材料: 不锈钢 304
表面处理: 镜光
Main Material: 304 stainless steel
Surface processing: Polish finished

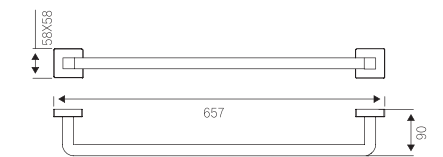

AX37-301(P)



卷纸座 (带盖)
PAPER HOLDER(WITH COVER)

主要材料: 不锈钢 304
表面处理: 镜光
Main Material: 304 stainless steel
Surface processing: Polish finished

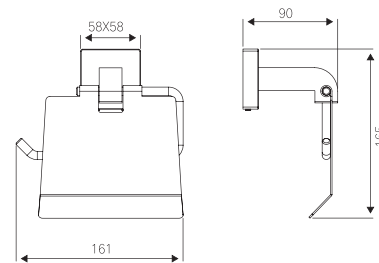

AX37-262(P)



毛巾双杆
DOUBLE TOWEL BAR

主要材料: 不锈钢 304
表面处理: 镜光
Main Material: 304 stainless steel
Surface processing: Polish finished

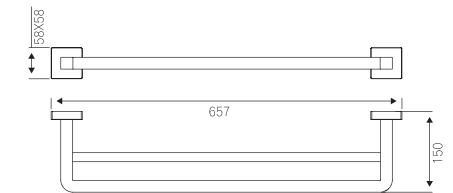

AX37-702(P)



双衣钩
DOUBLE ROBE HOOK

主要材料: 不锈钢 304
表面处理: 镜光
Main Material: 304 stainless steel
Surface processing: Polish finished

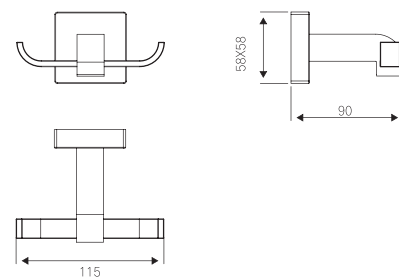

AX37-662(P)



毛巾架 (带下杆)
TOWEL RACK (WITH BAR)

主要材料: 不锈钢 304
表面处理: 镜光
Main Material: 304 stainless steel
Surface processing: Polish finished

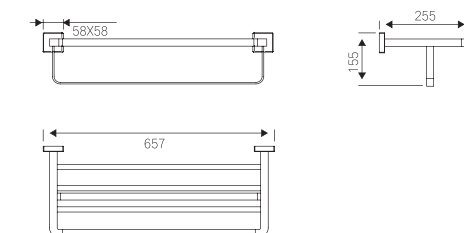

BATHROOM ACCESSORIES SET

套装挂件 —
AX37(ACU) 系列

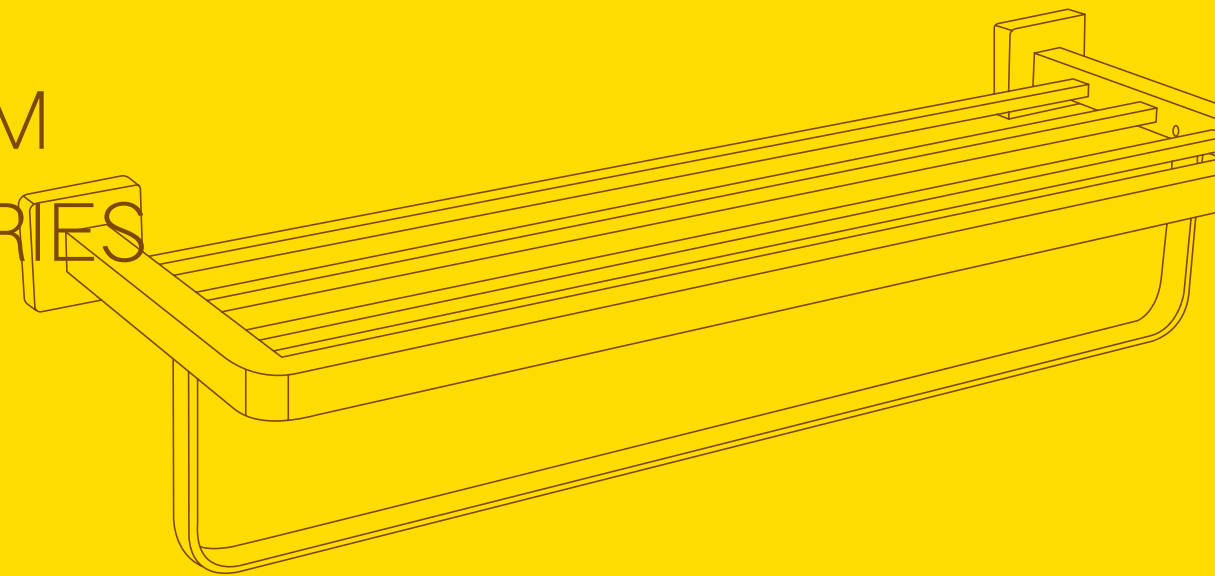

124

BATHROOM ACCESSORIES SET
AX37(ACU) SERIES

AX37-801 (ACU)

马桶刷座
BRUSH HOLDER

主要材料: 不锈钢 304
表面处理: 青古铜
Main Material: 304 stainless steel
Surface processing : ACU

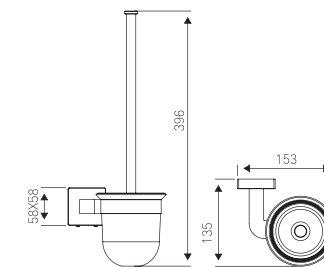

AX37-200(ACU)



毛巾环
TOWEL RING

主要材料: 不锈钢 304
表面处理: 青古铜
Main Material: 304 stainless steel
Surface processing : ACU

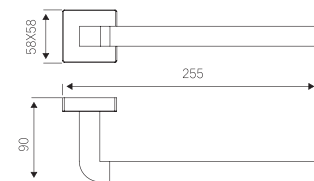

AX37-261 (ACU)



毛巾单杆
SINGLE TOWEL BAR

主要材料: 不锈钢 304
表面处理: 青古铜
Main Material: 304 stainless steel
Surface processing : ACU

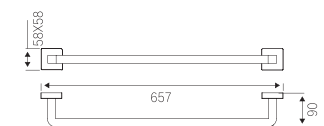

AX37-301 (ACU)



卷纸座 (带盖)
PAPER HOLDER(WITH COVER)

主要材料: 不锈钢 304
表面处理: 青古铜
Main Material: 304 stainless steel
Surface processing : ACU

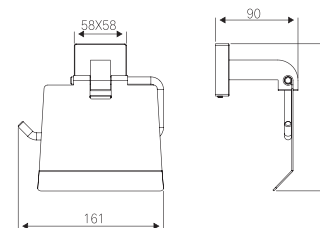

AX37-262(ACU)



毛巾双杆
DOUBLE TOWEL BAR

主要材料: 不锈钢 304
表面处理: 青古铜
Main Material: 304 stainless steel
Surface processing : ACU

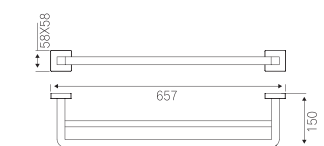

AX37-702(ACU)



双衣钩
DOUBLE ROBE HOOK

主要材料: 不锈钢 304
表面处理: 青古铜
Main Material: 304 stainless steel
Surface processing : ACU

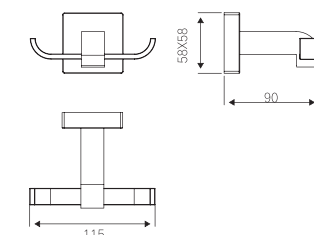

AX37-662(ACU)



毛巾架 (带下杆)
TOWEL RACK (WITH BAR)

主要材料: 不锈钢 304
表面处理: 青古铜
Main Material: 304 stainless steel
Surface processing : ACU

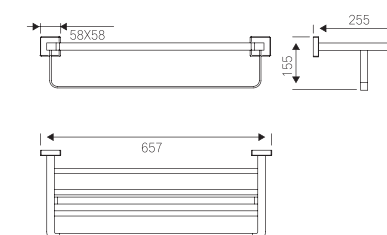

BATHROOM ACCESSORIES SET

套装挂件 —
AX37(ORB) 系列

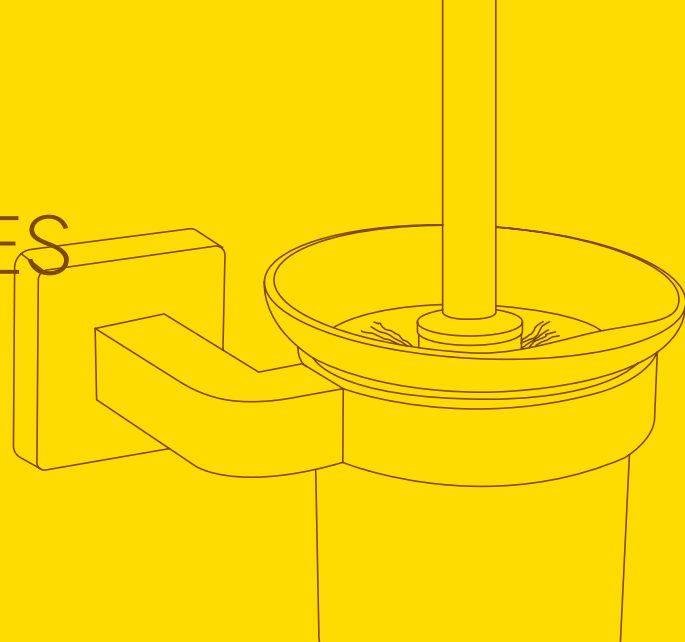

126

BATHROOM ACCESSORIES SET
AX37(ORB)SERIES

AX37-801(ORB)

马桶刷座
BRUSH HOLDER

主要材料: 不锈钢 304
表面处理: 黑古铜
Main Material: 304 stainless steel
Surface processing : ORB

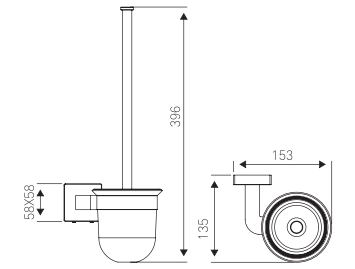

AX37-200(ORB)

毛巾环
TOWEL RING

主要材料: 不锈钢 304
表面处理: 黑古铜
Main Material: 304 stainless steel
Surface processing : ORB

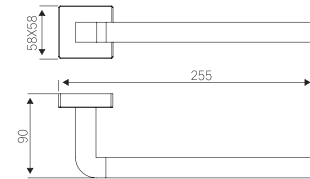

AX37-261(ORB)

毛巾单杆
SINGLE TOWEL BAR

主要材料: 不锈钢 304
表面处理: 黑古铜
Main Material: 304 stainless steel
Surface processing : ORB

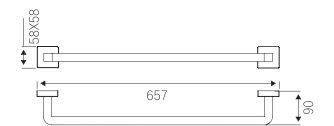

AX37-301(ORB)

卷纸座 (带盖)
PAPER HOLDER(WITH COVER)

主要材料: 不锈钢 304
表面处理: 黑古铜
Main Material: 304 stainless steel
Surface processing : ORB

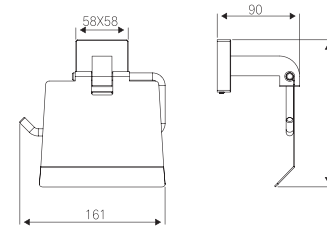

AX37-262(ORB)

毛巾双杆
DOUBLE TOWEL BAR

主要材料: 不锈钢 304
表面处理: 黑古铜
Main Material: 304 stainless steel
Surface processing : ORB

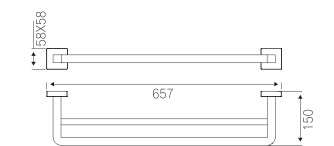

AX37-702(ORB)

双衣钩
DOUBLE ROBE HOOK

主要材料: 不锈钢 304
表面处理: 黑古铜
Main Material: 304 stainless steel
Surface processing : ORB

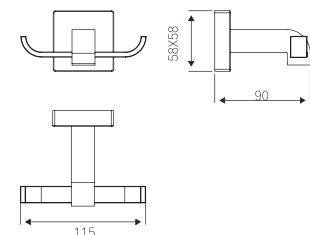

AX37-662(ORB)

毛巾架 (带下杆)
TOWEL RACK (WITH BAR)

主要材料: 不锈钢 304
表面处理: 黑古铜
Main Material: 304 stainless steel
Surface processing : ORB

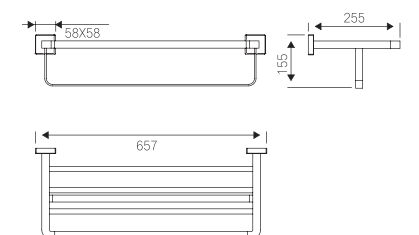

BATHROOM ACCESSORIES SET

套装挂件 —
AX35(P) 系列

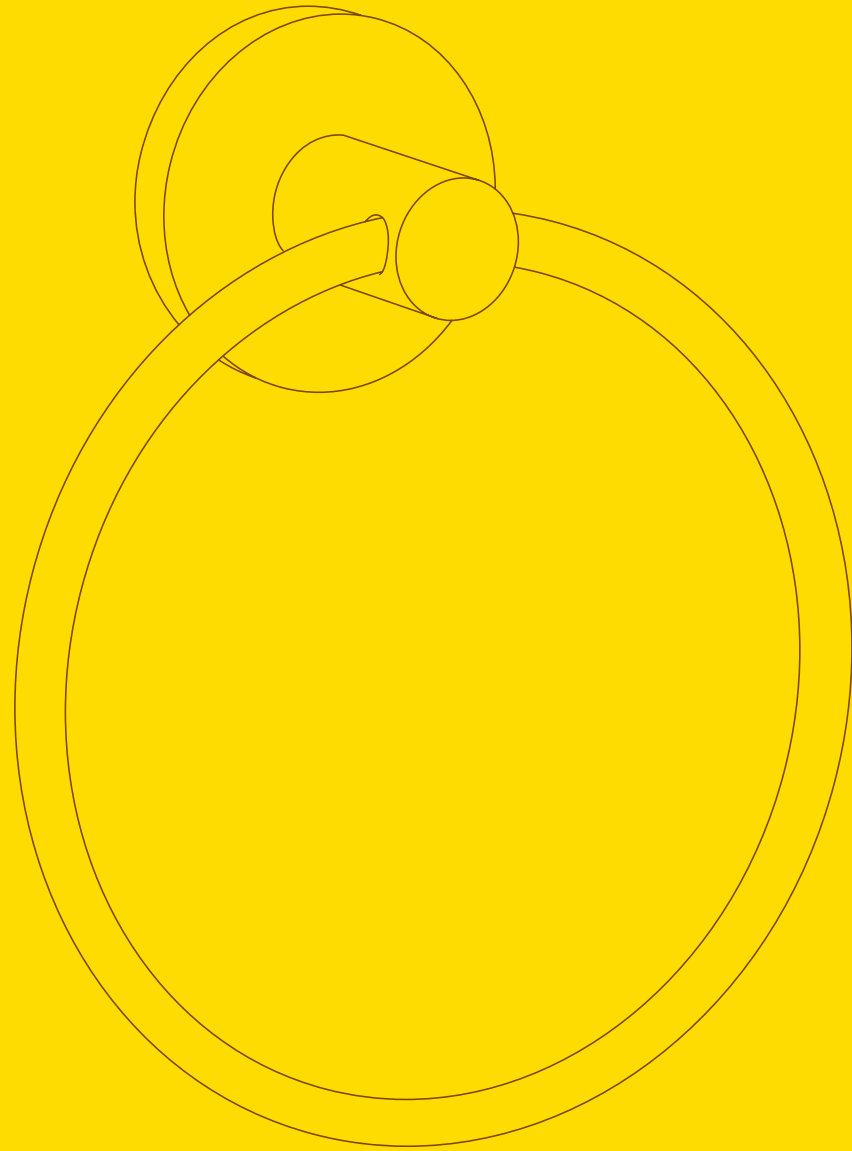

128

BATHROOM ACCESSORIES SET
AX35(P) SERIES



AX35-301

卷纸座 (无盖)
PAPER HOLDER (WITHOUT COVER)

主要材料: 不锈钢 304
表面处理: 镜光
Main Material: 304 stainless steel
Surface processing: Polish finished

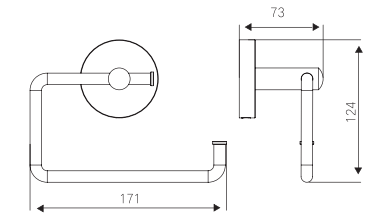

AX35-3011

卷纸座 (带盖)
PAPER HOLDER (WITH COVER)

主要材料: 不锈钢 304
表面处理: 镜光
Main Material: 304 stainless steel
Surface processing: Polish finished

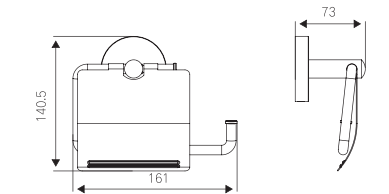

AX35-3012

卷纸座 (带手机托架)
PAPER HOLDER (WITH SHELF)

主要材料: 不锈钢 304
表面处理: 镜光
Main Material: 304 stainless steel
Surface processing: Polish finished

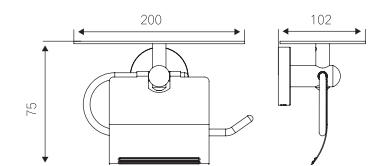

AX35-200

毛巾环
TOWEL RING

主要材料: 不锈钢 304
表面处理: 镜光
Main Material: 304 stainless steel
Surface processing: Polish finished

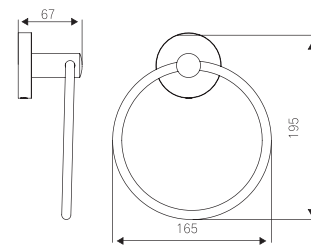

AX35-702

双衣钩
DOUBLE ROBE HOOK

主要材料: 不锈钢 304
表面处理: 镜光
Main Material: 304 stainless steel
Surface processing: Polish finished

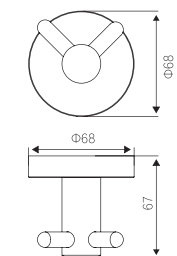



AX35-801

马桶刷座
BRUSH HOLDER

主要材料: 不锈钢 304, 陶瓷
表面处理: 镜光
Main Material: 304 stainless steel, Ceramic
Surface processing: Polish finished

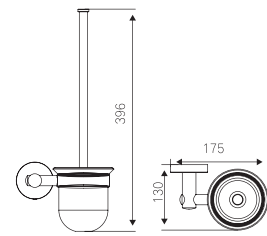

AX35-261

毛巾单杆
SINGLE TOWEL BAR

主要材料: 不锈钢 304
表面处理: 镜光
Main Material: 304 stainless steel
Surface processing: Polish finished

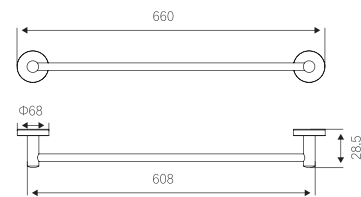

AX35-262

毛巾双杆
DOUBLE TOWEL BAR

主要材料: 不锈钢 304
表面处理: 镜光
Main Material: 304 stainless steel
Surface processing: Polish finished

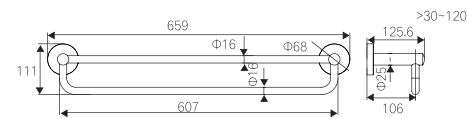

AX35-662

毛巾架 (带下杆)
TOWEL RACK (WITH BAR)

主要材料: 不锈钢 304
表面处理: 镜光
Main Material: 304 stainless steel
Surface processing: Polish finished

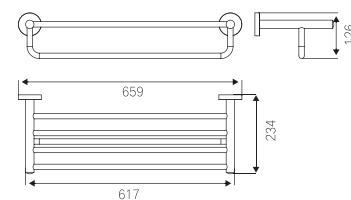

BATHROOM ACCESSORIES SET

套装挂件 — AX35(PVD) 系列

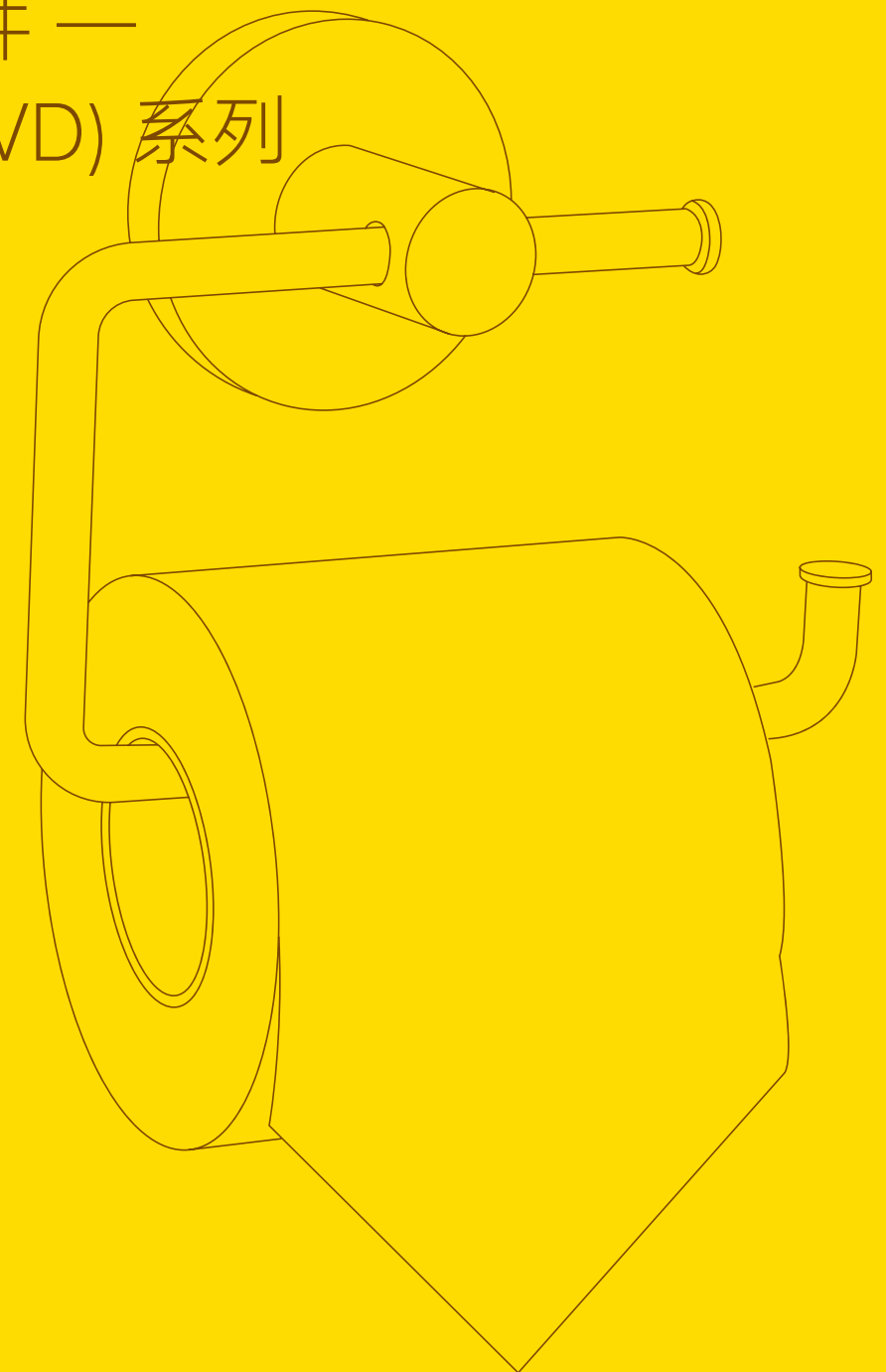



AX35-200(PVD)

毛巾环
TOWEL RING

主要材料: 不锈钢 304
表面处理: 镀金
Main Material: 304 stainless steel
Surface processing : PVD

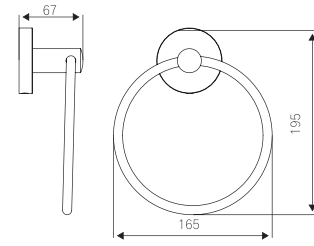

AX35-801 (PVD)

马桶刷座
BRUSH HOLDER

主要材料: 不锈钢 304
表面处理: 镀金
Main Material: 304 stainless steel
Surface processing : PVD

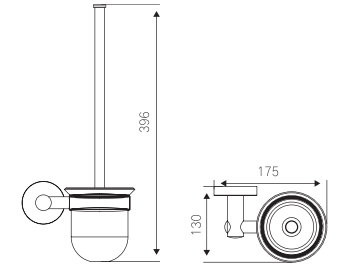

AX35-301 (PVD)

卷纸座 (无盖)
PAPER HOLDER (WITHOUT COVER)

主要材料: 不锈钢 304
表面处理: 镀金
Main Material: 304 stainless steel
Surface processing : PVD

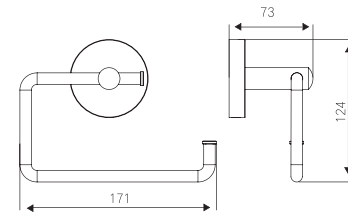

AX35-261 (PVD)

毛巾单杆
SINGLE TOWEL BAR

主要材料: 不锈钢 304
表面处理: 镀金
Main Material: 304 stainless steel
Surface processing : PVD

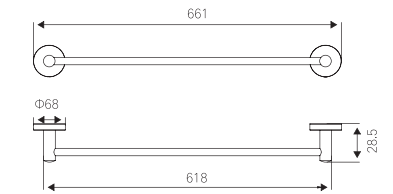

AX35-3011 (PVD)

卷纸座 (带盖)
PAPER HOLDER(WITH COVER)

主要材料: 不锈钢 304
表面处理: 镀金
Main Material: 304 stainless steel
Surface processing : PVD

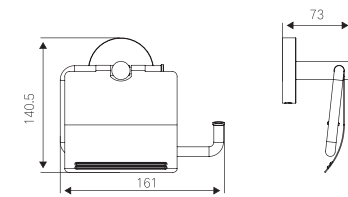

AX35-262(PVD)

毛巾双杆
DOUBLE TOWEL BAR

主要材料: 不锈钢 304
表面处理: 镀金
Main Material: 304 stainless steel
Surface processing : PVD

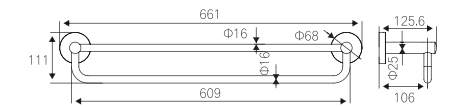

AX35-702(PVD)

双衣钩
DOUBLE ROBE HOOK

主要材料: 不锈钢 304
表面处理: 镀金
Main Material: 304 stainless steel
Surface processing : PVD

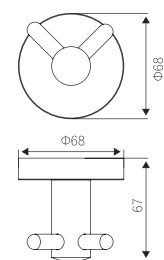

AX35-662(PVD)

毛巾架 (带下杆)
TOWEL RACK (WITH BAR)

主要材料: 不锈钢 304
表面处理: 镀金
Main Material: 304 stainless steel
Surface processing : PVD

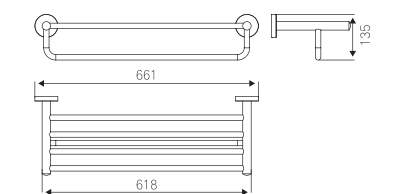

BATHROOM ACCESSORIES SET

套装挂件 —
AX30 系列

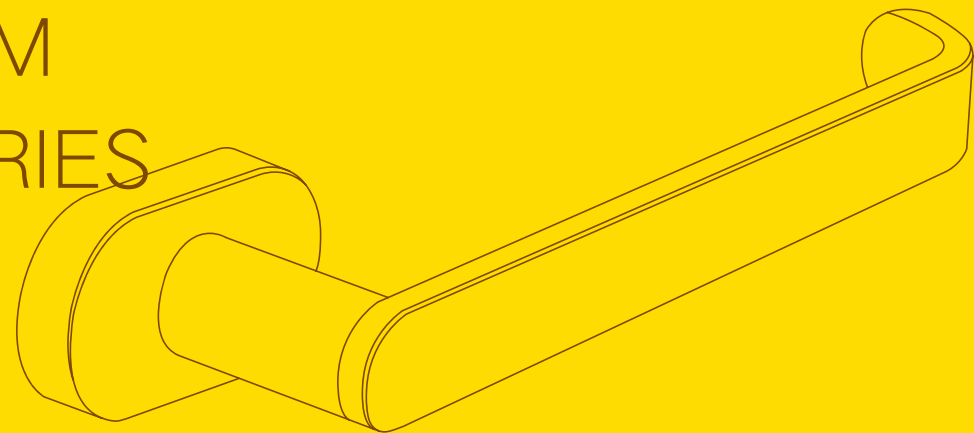

AX30-200(P)



毛巾环
TOWEL RING

主要材料: 不锈钢 304
表面处理: 镜光
Main Material: 304 stainless steel
Surface processing : Polish finished

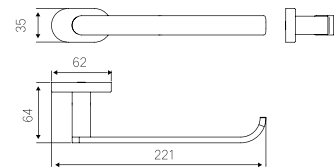

AX30-3011(P)



卷纸座 (带盖)
PAPER HOLDER (WITH COVER)

主要材料: 不锈钢 304
表面处理: 镜光
Main Material: 304 stainless steel
Surface processing : Polish finished

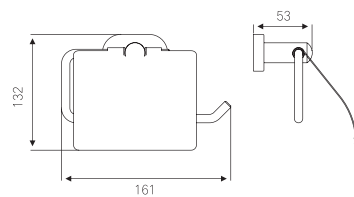

AX30-701(P)



双衣钩
DOUBLE ROBE HOOK

主要材料: 不锈钢 304
表面处理: 镜光
Main Material: 304 stainless steel
Surface processing : Polish finished

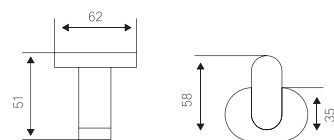

134

BATHROOM ACCESSORIES SET
AX30 SERIES



AX30-801(P)

马桶刷座
BRUSH HOLDER

主要材料: 不锈钢 304
表面处理: 镜光
Main Material: 304 stainless steel
Surface processing : Polish finished

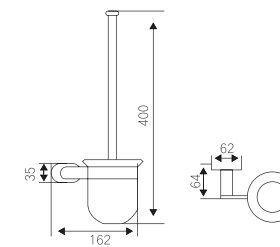

AX30-261(P)



毛巾单杆
SINGLE TOWEL BAR

主要材料: 不锈钢 304
表面处理: 镜光
Main Material: 304 stainless steel
Surface processing : Polish finished



AX30-262(P)



毛巾双杆
DOUBLE TOWEL BAR

主要材料: 不锈钢 304
表面处理: 镜光
Main Material: 304 stainless steel
Surface processing : Polish finished

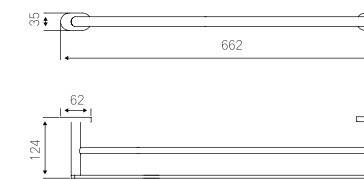

AX30-662(P)



毛巾架 (带下杆)
TOWEL RACK (WITH BAR)

主要材料: 不锈钢 304
表面处理: 镜光
Main Material: 304 stainless steel
Surface processing : Polish finished

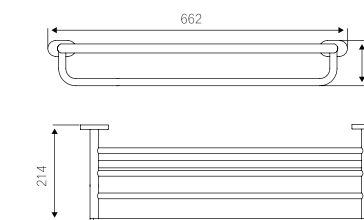

BATHROOM ACCESSORIES SET

套装挂件 —
AX29 系列

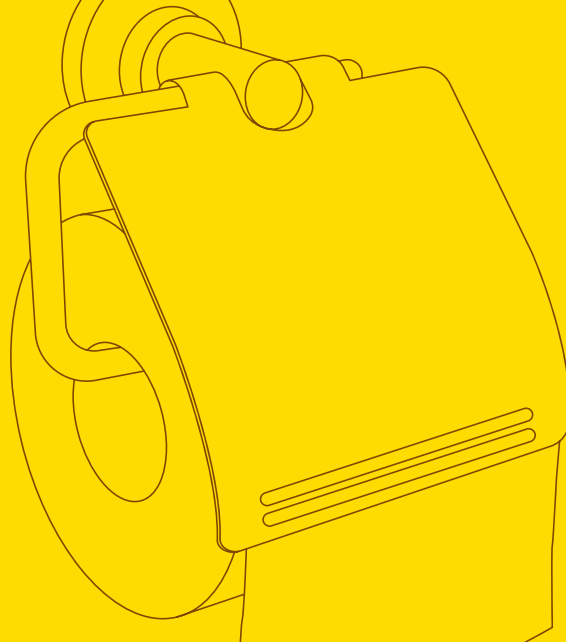

136

BATHROOM ACCESSORIES SET
AX29 SERIES

AX29-801

马桶座刷 (陶瓷)
BRUSH HOLDER (CERAMIC)

主要材料: 不锈钢 304
表面处理: 镜光
Main Material: 304 stainless steel
Surface processing : Polish finished

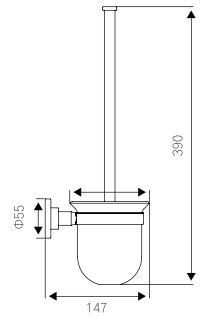

AX29-200

毛巾环
TOWEL RING

主要材料: 不锈钢 304
表面处理: 镜光
Main Material: 304 stainless steel
Surface processing : Polish finished

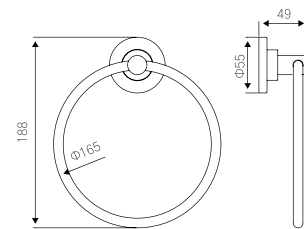

AX29-261

毛巾单杆
SINGLE TOWEL BAR

主要材料: 不锈钢 304
表面处理: 镜光
Main Material: 304 stainless steel
Surface processing : Polish finished



AX29-301

卷纸座 (带盖)
PAPER HOLDER (WITH COVER)

主要材料: 不锈钢 304
表面处理: 镜光
Main Material: 304 stainless steel
Surface processing : Polish finished

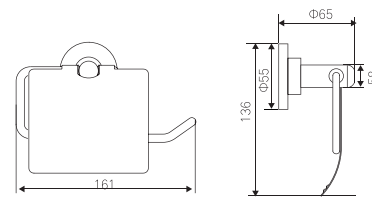

AX29-262

毛巾双杆
DOUBLE TOWEL BAR

主要材料: 不锈钢 304
表面处理: 镜光
Main Material: 304 stainless steel
Surface processing : Polish finished

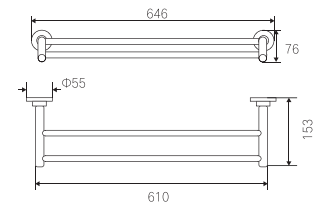

AX29-702

双衣钩
DOUBLE ROBE HOOK

主要材料: 不锈钢 304
表面处理: 镜光
Main Material: 304 stainless steel
Surface processing : Polish finished

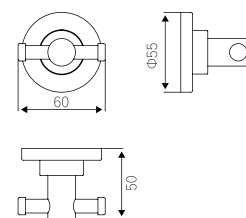

AX29-662

毛巾架 (带下杆)
TOWEL RACK (WITH BAR)

主要材料: 不锈钢 304
表面处理: 镜光
Main Material: 304 stainless steel
Surface processing : Polish finished

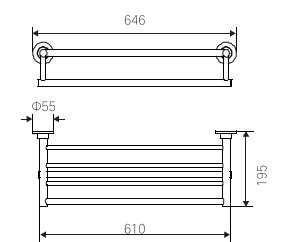

BATHROOM ACCESSORIES SET

套装挂件 —
AX28 系列

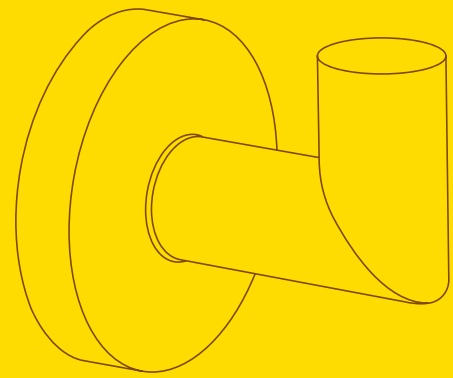

AX28-200



毛巾环
TOWEL RING

主要材料: 不锈钢 304
表面处理: 镜光
Main Material: 304 stainless steel
Surface processing: Polish finished

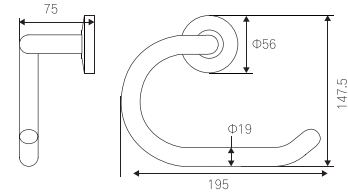

AX28-3011



卷纸座 (带盖)
PAPER HOLDER (WITH COVER)

主要材料: 不锈钢 304
表面处理: 镜光
Main Material: 304 stainless steel
Surface processing: Polish finished

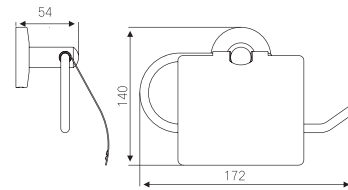

AX28-701



单衣钩
SINGLE ROBE HOOK

主要材料: 不锈钢 304
表面处理: 镜光
Main Material: 304 stainless steel
Surface processing: Polish finished

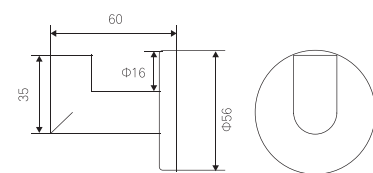

AX28-801



马桶座刷 (陶瓷)
BRUSH HOLDER (CERAMIC)

主要材料: 不锈钢 304
表面处理: 镜光
Main Material: 304 stainless steel
Surface processing: Polish finished

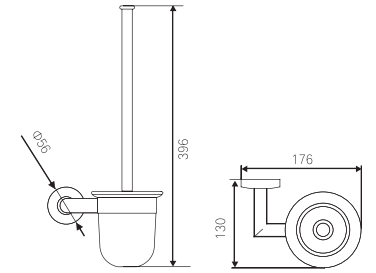

AX28-261



毛巾单杆
SINGLE TOWEL BAR

主要材料: 不锈钢 304
表面处理: 镜光
Main Material: 304 stainless steel
Surface processing: Polish finished

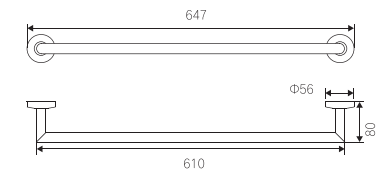

AX28-262



毛巾双杆
DOUBLE TOWEL BAR

主要材料: 不锈钢 304
表面处理: 镜光
Main Material: 304 stainless steel
Surface processing: Polish finished

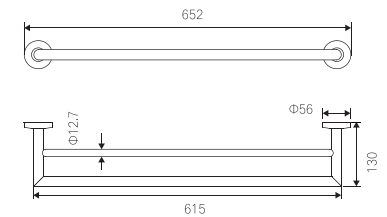

AX28-662



毛巾架 (带下杆)
TOWEL RACK (WITH BAR)

主要材料: 不锈钢 304
表面处理: 镜光
Main Material: 304 stainless steel
Surface processing: Polish finished

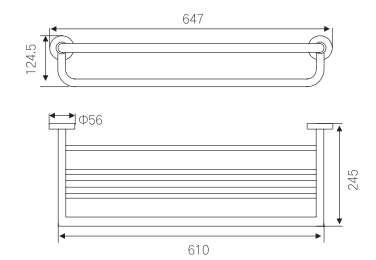

BATHROOM ACCESSORIES SET

套装挂件 —
AX22 系列



AX22-200



毛巾环
TOWEL RING

主要材料：不锈钢 304
表面处理：镜光
Main Material: 304 stainless steel
Surface processing : Polish finished

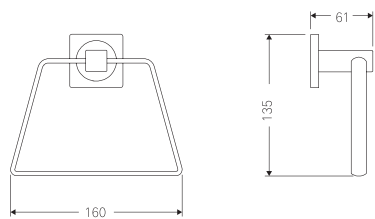

AX22-301



卷纸座
PAPER HOLDER

主要材料：不锈钢 304
表面处理：镜光
Main Material: 304 stainless steel
Surface processing : Polish finished

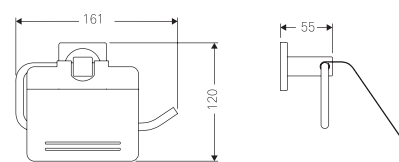

AX22-701



双衣钩
DOUBLE ROBE HOOK

主要材料：不锈钢 304
表面处理：镜光
Main Material: 304 stainless steel
Surface processing : Polish finished

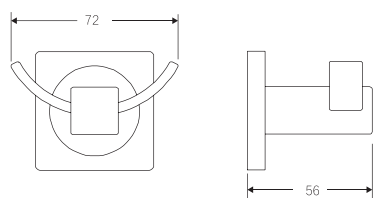

140

BATHROOM ACCESSORIES SET AX28 SERIES

AX22-261



毛巾单杆
SINGLE TOWEL BAR

主要材料：不锈钢 304
表面处理：镜光
Main Material: 304 stainless steel
Surface processing : Polish finished



AX22-262



毛巾双杆
DOUBLE TOWEL BAR

主要材料：不锈钢 304
表面处理：镜光
Main Material: 304 stainless steel
Surface processing : Polish finished



AX22-662



毛巾架
TOWEL RACK

主要材料：不锈钢 304
表面处理：镜光
Main Material: 304 stainless steel
Surface processing : Polish finished



AX22-661-1



毛巾架 (带下杆)
TOWEL RACK (WITH BAR)

主要材料：不锈钢 304
表面处理：镜光
Main Material: 304 stainless steel
Surface processing : Polish finished

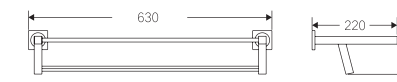

BATHROOM ACCESSORIES SET

套装挂件 —
AX18 系列

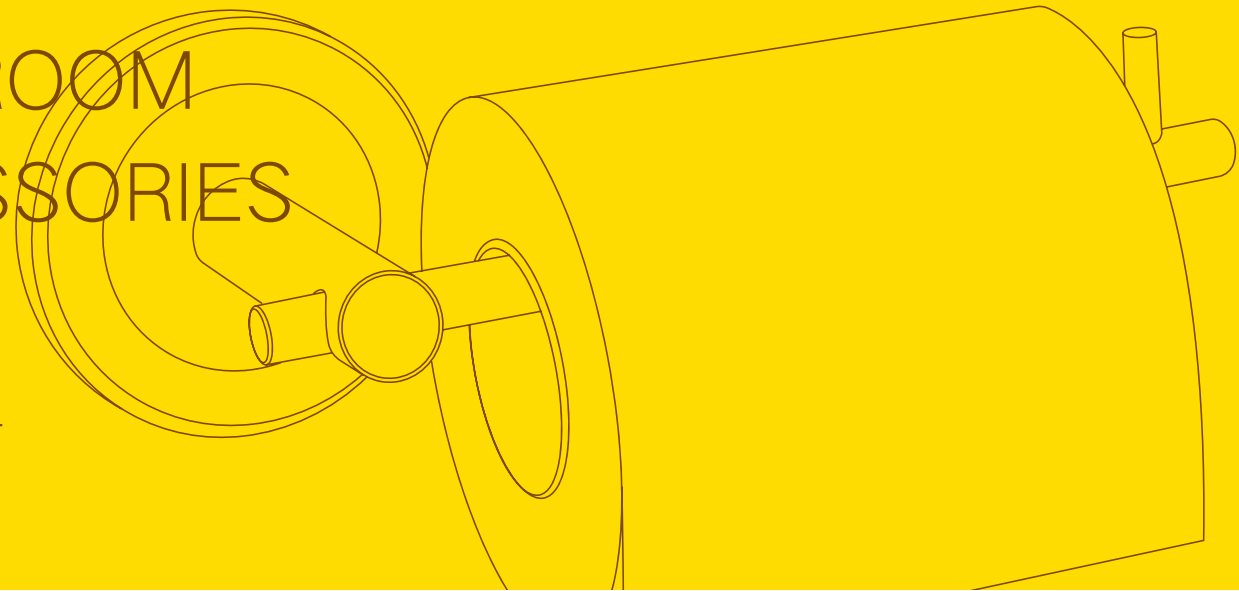

142

BATHROOM ACCESSORIES SET
AX18 SERIES

AX18-801

马桶座刷
BRUSH HOLDER

主要材料：不锈钢 304
表面处理：砂光
Main Material: 304 stainless steel
Surface processing : Satin finished

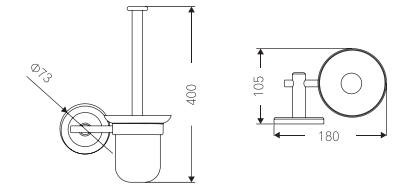

AX18-200

毛巾环
TOWEL RING

主要材料：不锈钢 304
表面处理：砂光
Main Material: 304 stainless steel
Surface processing : Satin finished

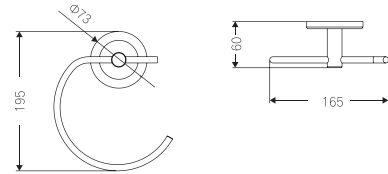

AX18-261

毛巾单杆
SINGLE TOWEL BAR

主要材料：不锈钢 304
表面处理：砂光
Main Material: 304 stainless steel
Surface processing : Satin finished

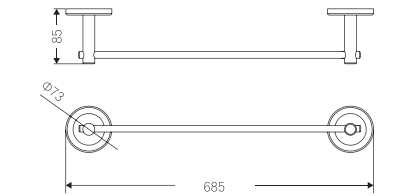

AX18-301

卷纸座
PAPER HOLDER

主要材料：不锈钢 304
表面处理：砂光
Main Material: 304 stainless steel
Surface processing : Satin finished

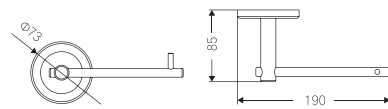

AX18-262

毛巾双杆
DOUBLE TOWEL BAR

主要材料：不锈钢 304
表面处理：砂光
Main Material: 304 stainless steel
Surface processing : Satin finished

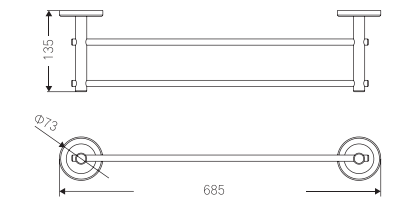

AX18-701

单衣钩
SINGLE ROBE HOOK

主要材料：不锈钢 304
表面处理：砂光
Main Material: 304 stainless steel
Surface processing : Satin finished

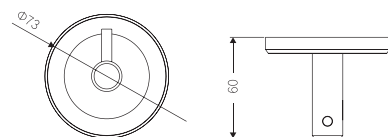

AX18-662

毛巾架
TOWEL RACK

主要材料：不锈钢 304
表面处理：砂光
Main Material: 304 stainless steel
Surface processing : Satin finished

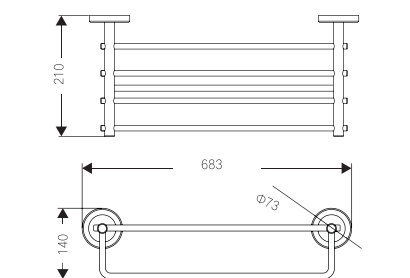

BATHROOM ACCESSORIES SET

套装挂件 —
AX13 系列

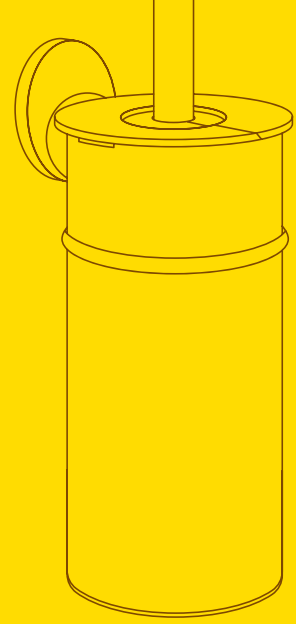

144

BATHROOM ACCESSORIES SET AX13 SERIES

AX13-800

马桶座刷
BRUSH HOLDER

主要材料：不锈钢 304
表面处理：镜光
Main Material: 304 stainless steel
Surface processing : Polish finished

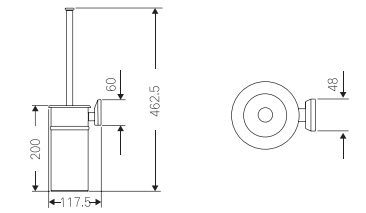

AX13-200

毛巾环
TOWEL RING

主要材料：不锈钢 304
表面处理：镜光
Main Material: 304 stainless steel
Surface processing : Polish finished

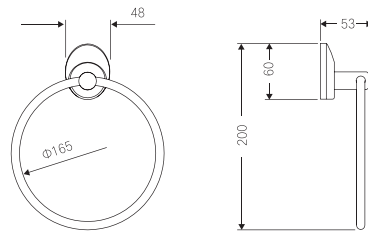

AX13-261

毛巾单杆
SINGLE TOWEL BAR

主要材料：不锈钢 304
表面处理：镜光
Main Material: 304 stainless steel
Surface processing : Polish finished

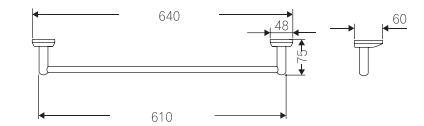

AX13-301

卷纸座
PAPER HOLDER

主要材料：不锈钢 304
表面处理：镜光
Main Material: 304 stainless steel
Surface processing : Polish finished

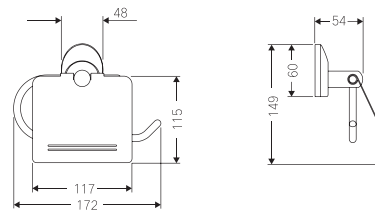

AX13-262

毛巾双杆
DOUBLE TOWEL BAR

主要材料：不锈钢 304
表面处理：镜光
Main Material: 304 stainless steel
Surface processing : Polish finished

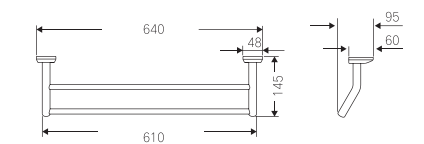

AX13-701

单衣钩
SINGLE ROBE HOOK

主要材料：不锈钢 304
表面处理：镜光
Main Material: 304 stainless steel
Surface processing : Polish finished

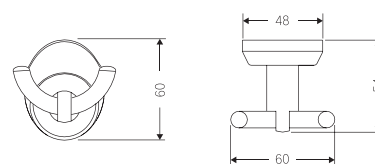

AX13-662

毛巾架 (带下杆)
TOWEL RACK (WITH BAR)

主要材料：不锈钢 304
表面处理：镜光
Main Material: 304 stainless steel
Surface processing : Polish finished

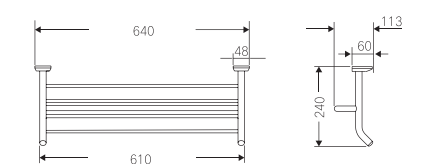

BATHROOM ACCESSORIES SET

套装挂件 —
AC51A 系列

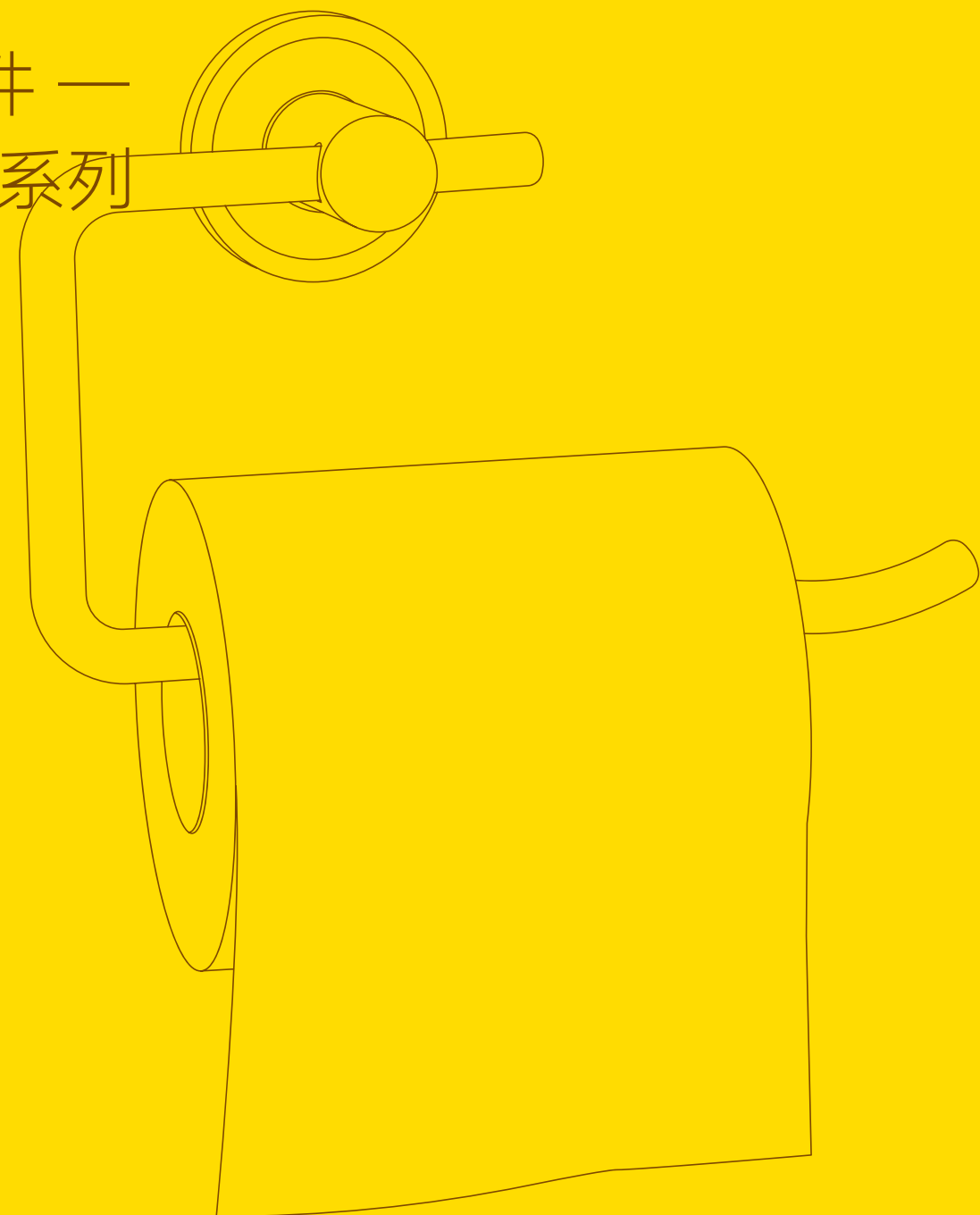

146

BATHROOM ACCESSORIES SET
AC51A SERIES



AC51A-200

毛巾环
TOWEL RING

主要材料：铜
表面处理：镀铬
Main Material : Brass
Surface processing : Chrome Plating

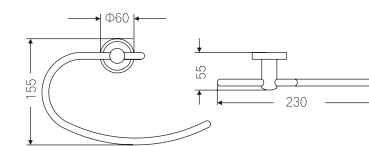

AC51A-301

卷纸座
PAPER HOLDER

主要材料：铜
表面处理：镀铬
Main Material : Brass
Surface processing : Chrome Plating

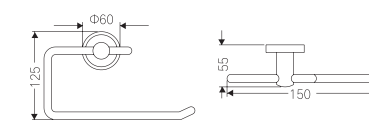

AC51A-3011

卷纸座 (带盖)
PAPER HOLDER (WITH COVER)

主要材料：铜
表面处理：镀铬
Main Material : Brass
Surface processing : Chrome Plating

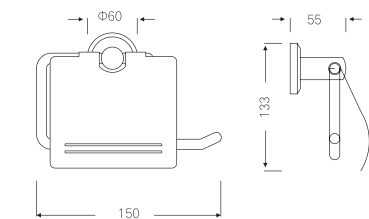

AC51A-701

单衣钩
SINGLE ROBE HOOK

主要材料：铜
表面处理：镀铬
Main Material : Brass
Surface processing : Chrome Plating

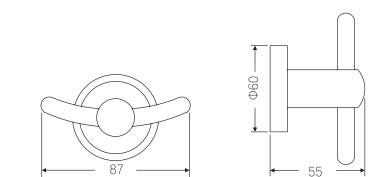



AC51A-801

马桶刷座
BRUSH HOLDER

主要材料: 铜
表面处理: 镀铬
Main Material: Brass
Surface processing: Chrome Plating

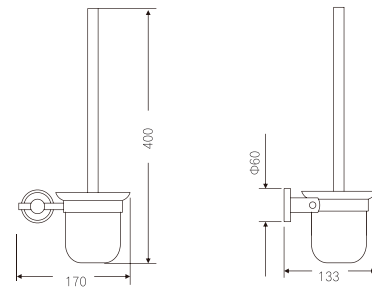

AC51A-261

毛巾单杆
SINGLE TOWEL BAR

主要材料: 铜
表面处理: 镀铬
Main Material: Brass
Surface processing: Chrome Plating



AC51A-262

毛巾双杆
DOUBLE TOWEL BAR

主要材料: 铜
表面处理: 镀铬
Main Material: Brass
Surface processing: Chrome Plating



AC51A-662

毛巾架 (带下杆)
TOWEL RACK (WITH BAR)

主要材料: 铜
表面处理: 镀铬
Main Material: Brass
Surface processing: Chrome Plating

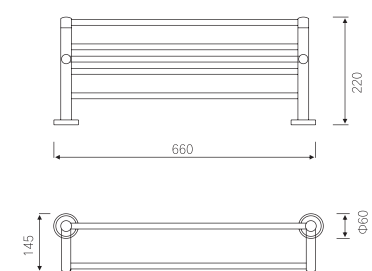

BATHROOM ACCESSORIES SET

套装挂件 — AC61 系列



AC61-200



毛巾环
TOWEL RING

主要材料: 铜
表面处理: 镀铬
Main Material : Brass
Surface processing : Chrome Plating

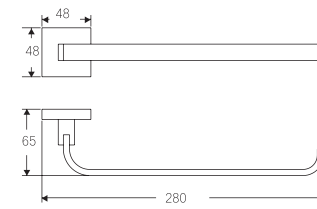

AC61-301



卷纸座
PAPER HOLDER

主要材料: 铜
表面处理: 镀铬
Main Material : Brass
Surface processing : Chrome Plating

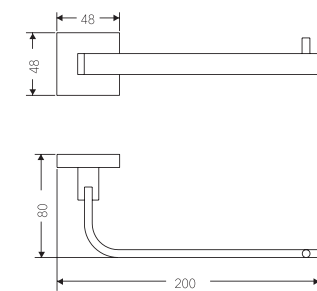

AC61-3011



卷纸座 (带盖)
PAPER HOLDER(WITH COVER)

主要材料: 铜
表面处理: 镀铬
Main Material : Brass
Surface processing : Chrome Plating

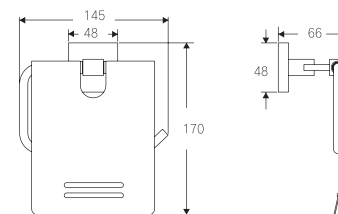

AC61-701



单衣钩
SINGLE ROBE HOOK

主要材料: 铜
表面处理: 镀铬
Main Material : Brass
Surface processing : Chrome Plating

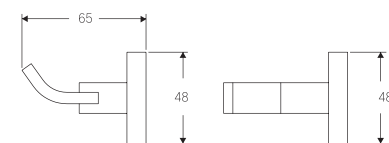

AC61-801



马桶刷座
BRUSH HOLDER

主要材料: 铜
表面处理: 镀铬
Main Material : Brass
Surface processing : Chrome Plating

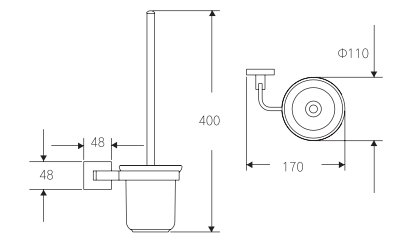

AC61-261



毛巾单杆
SINGLE TOWEL BAR

主要材料: 铜
表面处理: 镀铬
Main Material : Brass
Surface processing : Chrome Plating

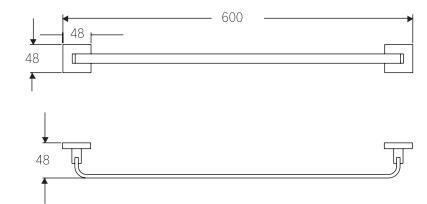

AC61-262



毛巾双杆
DOUBLE TOWEL BAR

主要材料: 铜
表面处理: 镀铬
Main Material : Brass
Surface processing : Chrome Plating

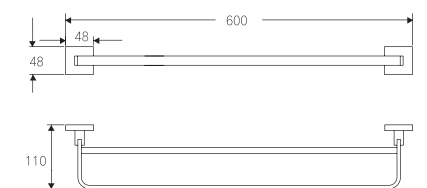

AC61-662



毛巾架 (带下杆)
TOWEL RACK (WITH BAR)

主要材料: 铜
表面处理: 镀铬
Main Material : Brass
Surface processing : Chrome Plating

